

PROPOSED BOUNDARY MAP OF  
TEMECULA VALLEY UNIFIED SCHOOL DISTRICT  
COMMUNITY FACILITIES DISTRICT NO. 2018-1

COUNTY OF RIVERSIDE  
STATE OF CALIFORNIA

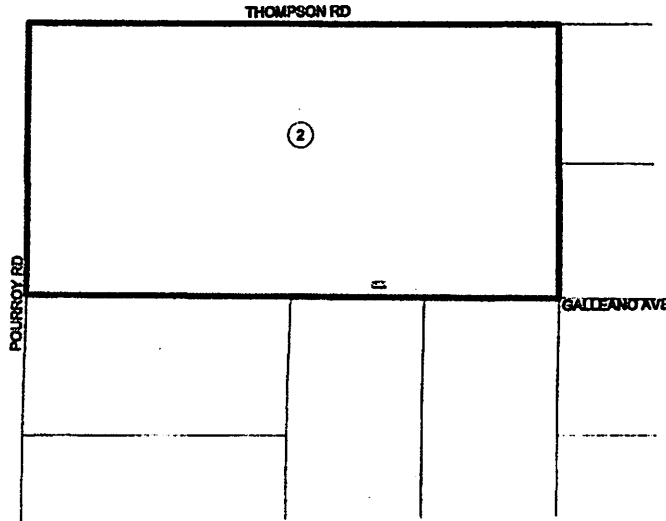
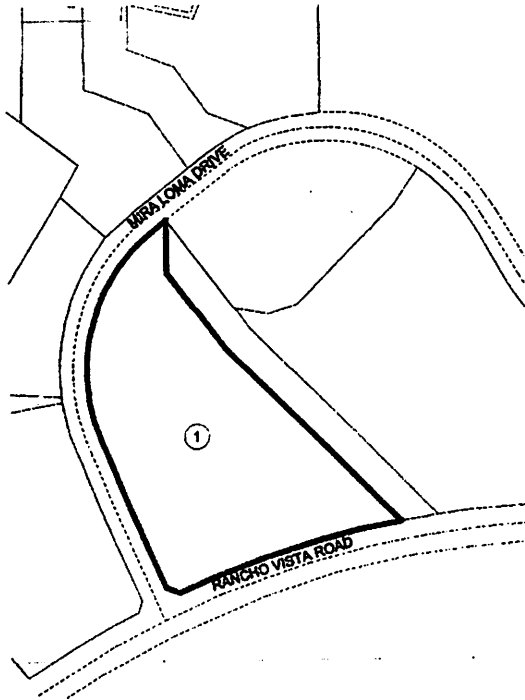

FILED IN THE OFFICE OF THE CLERK OF THE BOARD OF  
EDUCATION OF THE TEMECULA VALLEY UNIFIED SCHOOL  
DISTRICT THIS 3rd DAY OF JANUARY, 2018.

*John Hill*  
CLERK OF THE BOARD OF EDUCATION  
TEMECULA VALLEY UNIFIED SCHOOL DISTRICT  
STATE OF CALIFORNIA

I HEREBY CERTIFY THAT THE WITHIN MAP SHOWING THE  
BOUNDARIES OF COMMUNITY FACILITIES DISTRICT NO. 2018-1,  
RIVERSIDE COUNTY, STATE OF CALIFORNIA, WAS APPROVED  
BY THE BOARD OF EDUCATION OF THE TEMECULA VALLEY  
UNIFIED SCHOOL DISTRICT AT A REGULAR MEETING THEREOF,  
HELD ON THE 14th DAY OF JANUARY, 2018, BY ITS  
RESOLUTION NO. 2017-18/20.

*John Hill*  
CLERK OF THE BOARD OF EDUCATION  
TEMECULA VALLEY UNIFIED SCHOOL DISTRICT  
STATE OF CALIFORNIA

FILED THIS 22nd DAY OF JANUARY, 2018, AT  
THE HOUR OF 10:50 O'CLOCK A.M. IN BOOK  
81 OF MAPS OF ASSESSMENT AND COMMUNITY  
FACILITIES DISTRICTS AT PAGES 77 AND AS  
INSTRUMENT NO. 2018-0028191, IN THE OFFICES OF  
THE COUNTY RECORDER OF RIVERSIDE COUNTY, STATE OF  
CALIFORNIA.  
FEE: \$ 84.-

BY: *Marina Shores S. Olvera* COUNTY RECORDER  
COUNTY RECORDER OF THE COUNTY OF RIVERSIDE  
**PETER ALDANA**

LEGEND:

- ① LOT NUMBER
- \_\_\_\_\_ COMMUNITY FACILITIES DISTRICT BOUNDARY

LOT DESIGNATION			
LOT NO.	ASSESSOR'S PARCEL NO.	TRACT NO.	LOCATION
1	944-269-003	31584	CITY OF TEMECULA
2	964-616-001	35181	COUNTY OF RIVERSIDE



**SDFA**  
SPECIAL DISTRICT FINANCING  
& ADMINISTRATION  
437 WEST GRAND AVENUE  
ESCONDIDO, CALIFORNIA 92025  
TELEPHONE: (760)233-2630  
FAX: (760)233-2631

NOTE: FOR PARTICULARS OF LINES AND  
DIMENSIONS OF ASSESSOR'S PARCELS,  
REFERENCE IS MADE TO THE RIVERSIDE  
COUNTY ASSESSOR'S PARCEL MAPS.

SHEET	1 OF 1
DATE	JANUARY 2018
JOB NO.	CFD 2018-1