

COPY

76
17

PROPOSED BOUNDARY MAP OF
TEMECULA VALLEY UNIFIED SCHOOL DISTRICT
COMMUNITY FACILITIES DISTRICT NO. 2013-1
COUNTY OF RIVERSIDE
STATE OF CALIFORNIA

LOT DESIGNATION	
LOT NO.	ASSESSOR'S PARCEL NO.*
1	964-080-004
2	964-080-005
3	964-080-006
4	964-080-009
5	964-080-010
6	964-080-012
7	964-080-013
NAP	964-080-014

* THE BOUNDARY OF THE ASSESSOR PARCEL IS TO THE CENTER OF THE DEPICTED ROAD, WHERE APPLICABLE.

FILED IN THE OFFICE OF THE CLERK OF THE BOARD OF EDUCATION OF THE TEMECULA VALLEY UNIFIED SCHOOL DISTRICT THIS 23rd DAY OF April, 2013.

[Signature]

CLERK OF THE BOARD OF EDUCATION,
TEMECULA VALLEY UNIFIED SCHOOL DISTRICT,
STATE OF CALIFORNIA

I HEREBY CERTIFY THAT THE WITHIN MAP SHOWING THE BOUNDARIES OF COMMUNITY FACILITIES DISTRICT NO. 2013-1, RIVERSIDE COUNTY, STATE OF CALIFORNIA, WAS APPROVED BY THE BOARD OF EDUCATION OF THE TEMECULA VALLEY UNIFIED SCHOOL DISTRICT AT A REGULAR MEETING THEREOF, HELD ON THE 7th DAY OF May, 2013, BY ITS RESOLUTION NO. 2013-13/25

[Signature]

CLERK OF THE BOARD OF EDUCATION,
TEMECULA VALLEY UNIFIED SCHOOL DISTRICT,
STATE OF CALIFORNIA

FILED THIS 9th DAY OF MAY, 2013, AT THE HOUR OF 3:44 O'CLOCK P.M. IN BOOK 70 OF MAPS OF ASSESSMENT AND COMMUNITY FACILITIES DISTRICTS AT PAGES 17, AND AS INSTRUMENT NO. 222722, IN THE OFFICES OF THE COUNTY RECORDER OF RIVERSIDE COUNTY, STATE OF CALIFORNIA. FEE: \$ 10.00

[Signature]

COUNTY RECORDER OF THE COUNTY OF RIVERSIDE

NOTE: FOR PARTICULARS OF LINES AND DIMENSIONS OF THE ASSESSOR'S PARCELS, REFERENCE IS MADE TO THE COUNTY OF RIVERSIDE ASSESSOR'S PARCEL MAPS.

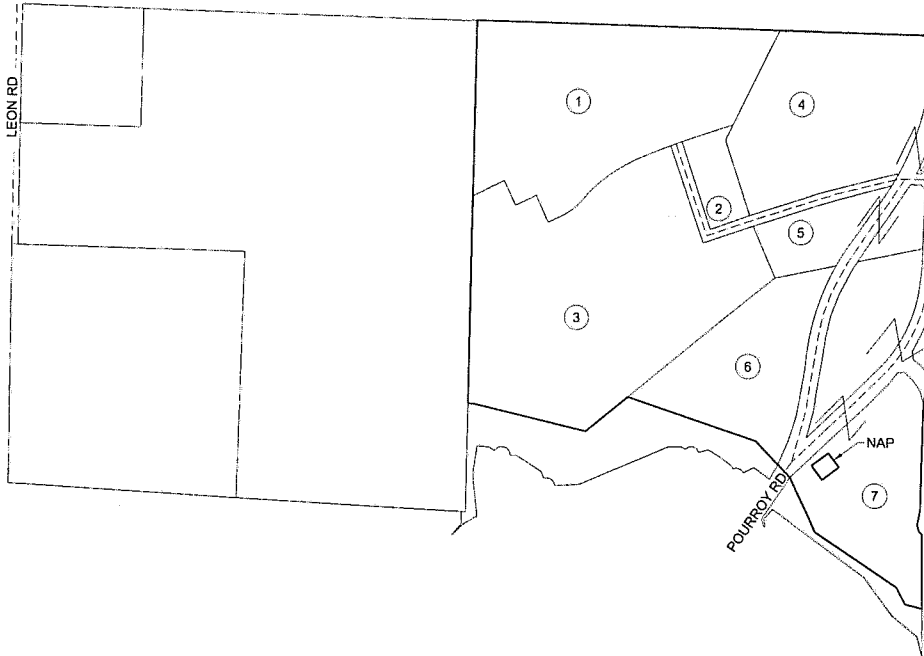

SDFA

SPECIAL DISTRICT FINANCING
& ADMINISTRATION

437 WEST GRAND AVENUE
ESCONDIDO, CALIFORNIA 92025
TELEPHONE: (760)233-2630
FAX: (760)233-2631

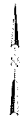

LEGEND:



LOT NUMBER



COMMUNITY FACILITIES DISTRICT BOUNDARY

SHEET	1 OF 1
DATE	MAY 2013
JOB NO.	CFD20131-0413