

**PROPOSED BOUNDARY MAP OF  
TEMECULA VALLEY UNIFIED SCHOOL DISTRICT  
COMMUNITY FACILITIES DISTRICT NO. 2010-1**

COUNTY OF RIVERSIDE  
STATE OF CALIFORNIA

LOT DESIGNATION	TAX ZONE	LOT NO.	TRACT	ASSESSOR'S PARCEL NUMBER
1	1	11	29114	480-550-004
2	1	12	29114	480-550-005
3	1	13	29114	480-550-006
4	1	14	29114	480-550-007
5	1	15	29114	480-550-008
6	1	16	29114	480-550-009
7	1	17	29114	480-550-010
8	1	18	29114	480-550-011
9	1	19	29114	480-550-012
10	1	20	29114	480-550-013
11	1	21	29114	480-550-014
12	1	22	29114	480-550-015
13	1	23	29114	480-550-016
14	1	24	29114	480-550-017
15	1	25	29114	480-550-018
16	1	26	29114	480-550-019
17	1	27	29114	480-550-020
18	1	28	29114	480-550-021
19	1	29	29114	480-550-022
20	1	30	29114	480-550-023
21	1	31	29114	480-550-024
22	1	32	29114	480-550-025
23	1	33	29114	480-550-026
24	1	34	29114	480-550-027
25	1	35	29114	480-550-028
26	1	36	29114	480-550-029
27	1	37	29114	480-550-030
28	1	38	29114	480-550-031
29	1	39	29114	480-550-032
30	1	40	29114	480-550-033
31	1	41	29114	480-550-034
32	1	42	29114	480-550-035
33	1	43	29114	480-550-036
34	1	44	29114	480-550-037
35	1	45	29114	480-550-038
36	1	46	29114	480-550-039
37	1	47	29114	480-551-001
38	1	48	29114	480-551-002
39	1	49	29114	480-551-003
40	1	50	29114	480-551-004
41	1	51	29114	480-551-005
42	1	52	29114	480-551-006
43	1	53	29114	480-551-007
44	1	54	29114	480-551-008
45	1	55	29114	480-551-009
46	1	56	29114	480-551-010
47	1	57	29114	480-551-011
48	1	58	29114	480-551-012
49	1	59	29114	480-551-013
50	1	60	29114	480-260-012

LOT DESIGNATION	TAX ZONE	LOT NO.	TRACT	ASSESSOR'S PARCEL NUMBER
51	1	61	29114	480-260-013
52	1	62	29114	480-260-014
53	1	63	29114	480-260-015
54	1	64	29114	480-260-016
55	1	13	29114-1	480-281-012
56	1	14	29114-1	480-281-013
57	1	20	29114-1	480-281-019
58	1	21	29114-1	480-281-020
59	1	22	29114-1	480-281-021
60	1	23	29114-1	480-281-022
61	2	1	CP*	480-621-001
62	2	2	CP*	480-621-002
63	2	3	CP*	480-621-003
64	2	4	CP*	480-621-004
65	2	5	CP*	480-621-005
66	2	6	CP*	480-621-006
67	2	7	CP*	480-621-007
68	2	8	CP*	480-621-008
69	2	9	CP*	480-621-009
70	2	10	CP*	480-621-010
71	2	11	CP*	480-621-011
72	2	12	CP*	480-621-012
73	2	13	CP*	480-621-013
74	2	14	CP*	480-621-014
75	2	15	CP*	480-621-015
76	2	16	CP*	480-621-016
77	2	17	CP*	480-621-017
78	2	18	CP*	480-621-018
79	2	19	CP*	480-621-019
80	2	20	CP*	480-621-020
81	2	21	CP*	480-621-021
82	2	22	CP*	480-621-022
83	2	23	CP*	480-621-023
84	2	24	CP*	480-621-024
85	2	25	CP*	480-621-025
86	2	26	CP*	480-621-026
87	2	27	CP*	480-621-027
88	2	28	CP*	480-621-028
89	2	29	CP*	480-621-029
90	2	30	CP*	480-621-030
91	2	31	CP*	480-621-031
92	2	32	CP*	480-621-032
93	2	33	CP*	480-621-033
94	2	34	CP*	480-621-034
95	2	35	CP*	480-621-035
96	2	36	CP*	480-621-036
97	2	37	CP*	480-621-037
98	2	38	CP*	480-621-038
99	2	39	CP*	480-621-039
100	2	40	CP*	480-621-040

LOT DESIGNATION	TAX ZONE	LOT NO.	TRACT	ASSESSOR'S PARCEL NUMBER
101	2	41	CP*	480-621-041
102	2	42	CP*	480-621-042
103	2	43	CP*	480-621-043
104	2	44	CP*	480-621-044
105	2	45	CP*	480-621-045
106	2	46	CP*	480-621-046
107	2	47	CP*	480-621-047
108	2	48	CP*	480-621-048
109	2	49	CP*	480-621-049
110	2	50	CP*	480-621-050
111	2	51	CP*	480-621-051
112	2	52	CP*	480-621-052
113	2	53	CP*	480-621-053
114	2	54	CP*	480-621-054
115	2	55	CP*	480-621-055
116	2	56	CP*	480-621-056
117	2	57	CP*	480-621-057
118	2	58	CP*	480-621-058
119	2	59	CP*	480-621-059
120	2	60	CP*	480-621-060
121	2	61	CP*	480-621-061
122	2	62	CP*	480-621-062
123	2	63	CP*	480-621-063
124	2	64	CP*	480-621-064
125	2	65	CP*	480-621-065
126	2	66	CP*	480-621-066
127	2	67	CP*	480-621-067
128	2	68	CP*	480-621-068
129	2	69	CP*	480-621-069
130	2	70	CP*	480-621-070
131	2	71	CP*	480-621-071
132	2	72	CP*	480-621-072
133	2	73	CP*	480-621-073
134	2	74	CP*	480-621-074
135	2	75	CP*	480-621-075
136	2	76	CP*	480-621-076
137	2	77	CP*	480-621-077
138	2	78	CP*	480-621-078
139	2	79	CP*	480-621-079
140	2	80	CP*	480-621-080
141	2	81	CP*	480-621-081
142	2	82	CP*	480-621-082
143	2	83	CP*	480-621-083
144	2	84	CP*	480-621-084
145	2	85	CP*	480-621-085
146	2	86	CP*	480-621-086
147	2	87	CP*	480-621-087
148	2	88	CP*	480-621-088
149	2	89	CP*	480-621-089
150	2	90	CP*	480-621-090

LOT DESIGNATION	TAX ZONE	LOT NO.	TRACT	ASSESSOR'S PARCEL NUMBER
151	2	91	CP*	480-621-091
152	2	92	CP*	480-621-092
153	2	93	CP*	480-621-093
154	2	94	CP*	480-621-094
155	2	95	CP*	480-621-095
156	2	96	CP*	480-621-096
157	2	97	CP*	480-621-097
158	2	98	CP*	480-621-098
159	2	99	CP*	480-621-099
160	2	100	CP*	480-621-100
161	2	101	CP*	480-621-101
162	2	102	CP*	480-621-102
163	2	103	CP*	480-621-103
164	2	104	CP*	480-621-104
165	2	105	CP*	480-621-105
166	2	106	CP*	480-621-106
167	2	107	CP*	480-621-107
168	2	108	CP*	480-621-108
169	2	109	CP*	480-621-109
170	2	110	CP*	480-621-110
171	2	111	CP*	480-621-111
172	2	112	CP*	480-621-112
173	2	113	CP*	480-621-113
174	2	114	CP*	480-621-114
175	2	115	CP*	480-621-115
176	2	116	CP*	480-621-116
177	2	117	CP*	480-621-117
178	2	118	CP*	480-621-118
179	2	119	CP*	480-621-119
180	2	120	CP*	480-621-120
181	2	121	CP*	480-621-121
182	2	122	CP*	480-621-122
183	2	123	CP*	480-621-123
184	2	124	CP*	480-621-124
185	2	125	CP*	480-621-125
186	2	126	CP*	480-621-126
187	2	127	CP*	480-621-127
188	2	128	CP*	480-621-128
189	2	129	CP*	480-621-129
190	2	130	CP*	480-621-130
191	2	131	CP*	480-621-131
192	2	132	CP*	480-621-132
193	2	133	CP*	480-621-133
194	2	134	CP*	480-621-134
195	2	135	CP*	480-621-135
196	2	136	CP*	480-621-136
197	2	137	CP*	480-621-137
198	2	138	CP*	480-621-138
199	2	139	CP*	480-621-139
200	2	140	CP*	480-621-140
201	2	141	CP*	480-621-141
202	2	142	CP*	480-621-142
203	2	143	CP*	480-621-143
204	2	144	CP*	480-621-144
205	2	145	CP*	480-621-145
206	2	146	CP*	480-621-146
207	2	147	CP*	480-621-147

FILED IN THE OFFICE OF THE SECRETARY OF THE BOARD OF EDUCATION OF THE TEMECULA VALLEY UNIFIED SCHOOL DISTRICT THIS 1st DAY OF December 2010.

*Timothy Ritter*  
TIMOTHY RITTER  
SECRETARY OF THE BOARD OF EDUCATION  
TEMECULA VALLEY UNIFIED SCHOOL DISTRICT  
STATE OF CALIFORNIA

I HEREBY CERTIFY THAT THE WITHIN MAP SHOWING THE PROPOSED BOUNDARIES OF COMMUNITY FACILITIES DISTRICT NO. 2010-1, RIVERSIDE COUNTY, STATE OF CALIFORNIA, WAS APPROVED BY THE BOARD OF EDUCATION OF THE TEMECULA VALLEY UNIFIED SCHOOL DISTRICT AT A REGULAR MEETING THEREOF HELD ON THE 14th DAY OF December 2010, BY ITS RESOLUTION NO. 2010-11/18.

*Timothy Ritter*  
TIMOTHY RITTER  
SECRETARY OF THE BOARD OF EDUCATION  
TEMECULA VALLEY UNIFIED SCHOOL DISTRICT  
STATE OF CALIFORNIA

FILED THIS 17th DAY OF December 2010 AT THE HOUR OF 4:46 O'CLOCK P.M. IN BOOK 19 OF MAPS OF Page 100-102 ASSESSMENT AND COMMUNITY FACILITIES DISTRICTS AND AS INSTRUMENT NO. 2010-12/17, IN THE OFFICE OF THE COUNTY RECORDER OF RIVERSIDE COUNTY, STATE OF CALIFORNIA Fee: \$4.00

*Debbie Gomez*  
Debbie Gomez  
Deputy  
COUNTY RECORDER OF RIVERSIDE COUNTY

NOTE: FOR PARTICULARS OF LINES AND DIMENSIONS OF ASSESSOR'S PARCELS, REFERENCE IS MADE TO THE RIVERSIDE COUNTY ASSESSOR'S PARCEL MAPS.

**ZIMMERMAN GROUP**  
LAND DEVELOPMENT SOLUTIONS  
28022 CABOT ROAD, SUITE 620  
LAGUNA HILLS, CA 92657  
(949) 542-7070 PHONE (949) 542-7070 FAX  
WWW.ZIMMERMANGROUP.COM

\* BELLASOL CONDOMINIUM PLAN RECORDED 1/23/2008 AS DOC #2008-0033858

City 74  
101

SHEET 2 OF 3  
11/29/2010

# PROPOSED BOUNDARY MAP OF TEMECULA VALLEY UNIFIED SCHOOL DISTRICT COMMUNITY FACILITIES DISTRICT NO. 2010-1

COUNTY OF RIVERSIDE  
STATE OF CALIFORNIA

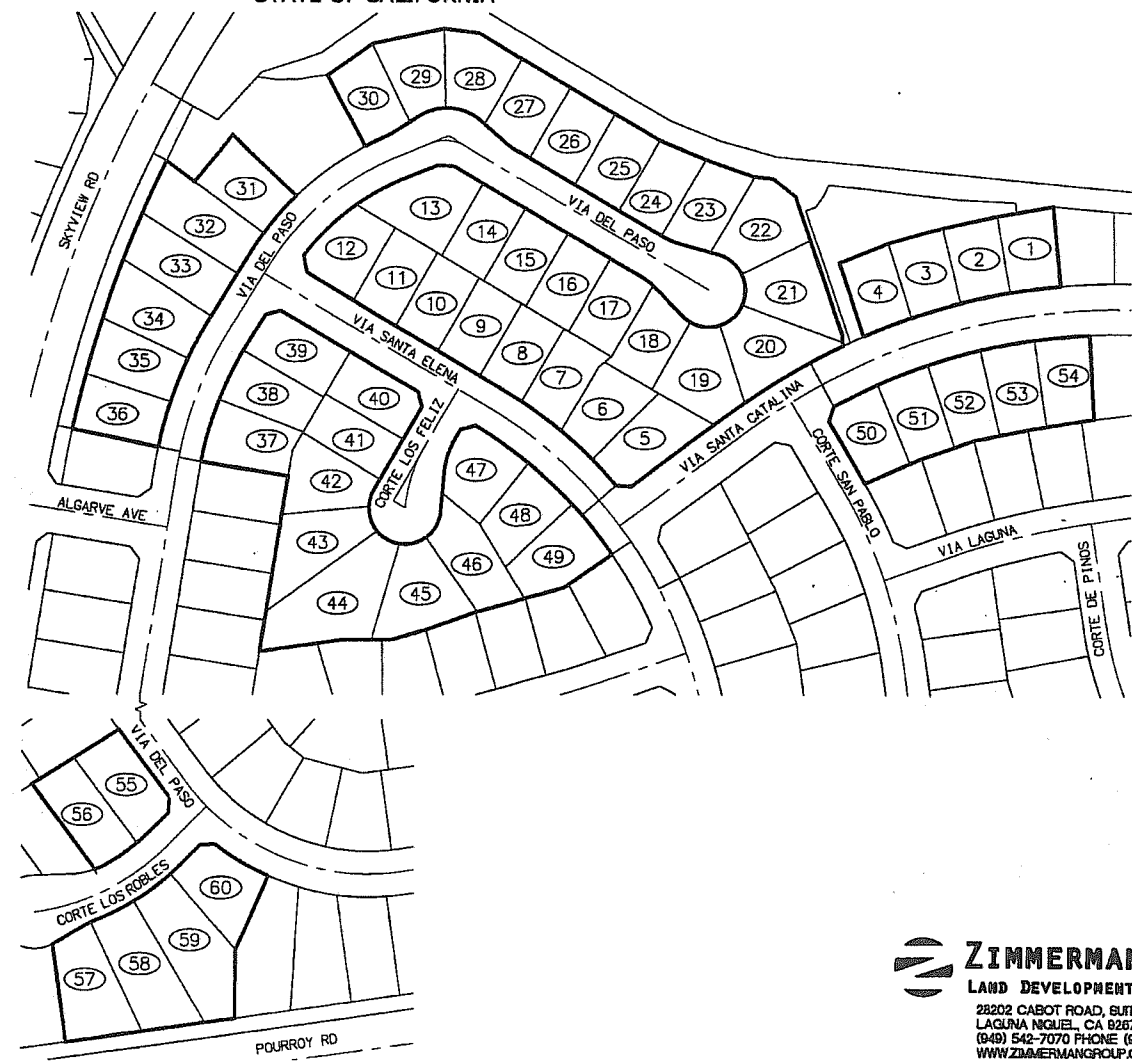
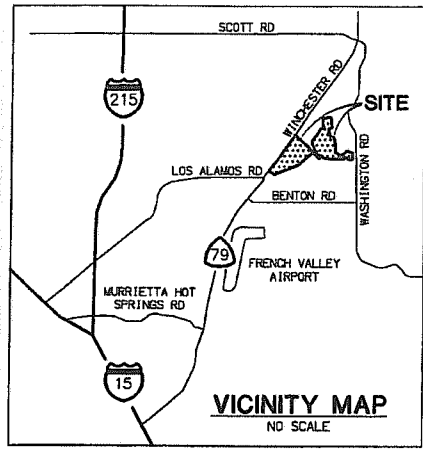

**LEGEND**  
① LOT DESIGNATION  
--- CFD BOUNDARY



**ZIMMERMAN GROUP**  
LAND DEVELOPMENT SOLUTIONS  
28202 CABOT ROAD, SUITE 620  
LAGUNA NIGUEL, CA 92677  
(949) 542-7070 PHONE (949) 542-7076 FAX  
WWW.ZIMMERMANGROUP.COM

City  
74  
102  
SHEET 3 OF 3  
11/29/2010

PROPOSED BOUNDARY MAP OF  
TEMECULA VALLEY UNIFIED SCHOOL DISTRICT  
COMMUNITY FACILITIES DISTRICT NO. 2010-1  
COUNTY OF RIVERSIDE  
STATE OF CALIFORNIA

WINCHESTER RD / STATE HWY 79

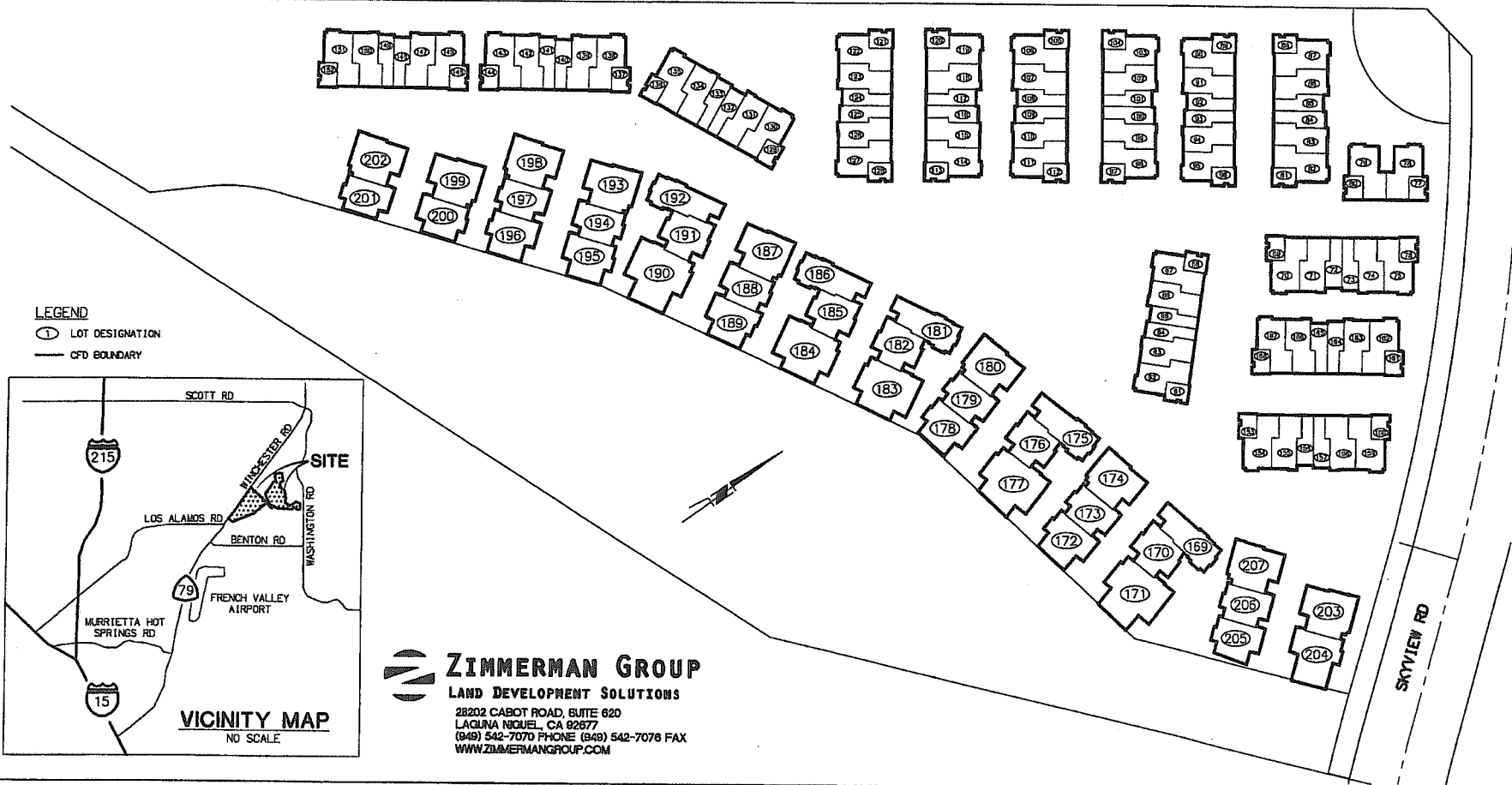

LEGEND  
○ LOT DESIGNATION  
— CFD BOUNDARY

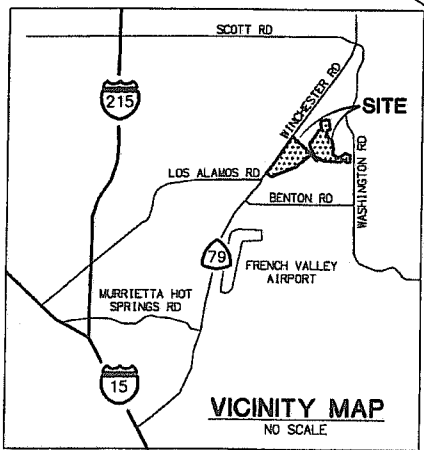

**ZIMMERMAN GROUP**  
LAND DEVELOPMENT SOLUTIONS  
28202 CABOT ROAD, SUITE 620  
LAGUNA HILLS, CA 92653  
(949) 542-7070 PHONE (949) 542-7076 FAX  
WWW.ZIMMERMANGROUP.COM