

**SUPPLEMENTAL BOUNDARY MAP  
OF  
COMMUNITY FACILITIES DISTRICT NO. 2005-1(H)  
OF TEMECULA VALLEY UNIFIED SCHOOL DISTRICT  
("CFD NO. 2005-1(H)")  
RIVERSIDE COUNTY  
STATE OF CALIFORNIA**

(MODIFYING THE BOUNDARY MAP FOR COMMUNITY FACILITIES DISTRICT NO. 2005-1 OF HEMET UNIFIED SCHOOL DISTRICT, RIVERSIDE COUNTY, STATE OF CALIFORNIA RECORDED ON MAY 28, 2005, IN BOOK 62 OF MAPS OF ASSESSMENT AND COMMUNITY FACILITIES DISTRICTS AT PAGE 82, AS INSTRUMENT NO. 2005-423072 IN THE OFFICE OF THE RECORDER FOR THE COUNTY OF RIVERSIDE, STATE OF CALIFORNIA.)

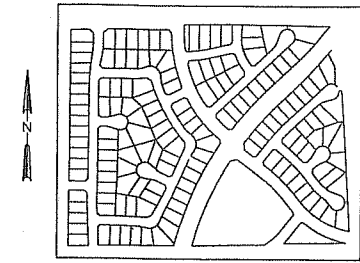

FILED IN THE OFFICE OF THE CLERK OF THE BOARD OF EDUCATION OF THE TEMECULA VALLEY UNIFIED SCHOOL DISTRICT THIS 15th DAY OF January, 20 16.

*Sandra Hankson*  
CLERK OF THE BOARD OF EDUCATION  
TEMECULA VALLEY UNIFIED SCHOOL DISTRICT  
AS THE LEGISLATIVE BODY OF CFD NO. 2005-1(H)  
STATE OF CALIFORNIA

I HEREBY CERTIFY THAT THIS SUPPLEMENTAL MAP OF THE BOUNDARIES OF CFD NO. 2005-1(H) IN THE COUNTY OF RIVERSIDE, STATE OF CALIFORNIA, AND RELATED TRANSFER OF GOVERNANCE, AUTHORIZED BY THE "GOVERNANCE TRANSFER AGREEMENT" UNDER SECTION 2(a) OF CHAPTER 206 OF THE 2013 LEGISLATION SESSION, OF CFD NO. 2005-1(H) FROM HEMET UNIFIED SCHOOL DISTRICT ("HUSD") TO THE TEMECULA VALLEY UNIFIED SCHOOL DISTRICT ("TVUSD") WAS APPROVED BY TVUSD ON THE 16TH DAY OF SEPTEMBER, 2014, BY ITS RESOLUTION NO. 2014-15/06 AND APPROVED BY THE HUSD ON THE 7TH DAY OF OCTOBER, 2014 BY ITS RESOLUTION NO. 2296. I FURTHER CERTIFY THAT BOTH THE "GOVERNANCE TRANSFER EFFECTIVE DATE" AND "REORGANIZATION EFFECTIVE DATE," IDENTIFIED IN THE GOVERNANCE TRANSFER AGREEMENT, OCCURRED ON JULY 1, 2015.

*Sandra Hankson*  
CLERK OF THE BOARD OF EDUCATION  
TEMECULA VALLEY UNIFIED SCHOOL DISTRICT  
AS THE LEGISLATIVE BODY OF CFD NO. 2005-1(H)  
STATE OF CALIFORNIA

FILED THIS 26th DAY OF JANUARY, 20 16, AT THE HOUR OF 12:05 O'CLOCK P.M. IN BOOK 79 OF MAPS OF ASSESSMENT AND COMMUNITY FACILITIES DISTRICTS AT PAGE(S) 23-24 AS INSTRUMENT NO. 2016-0028389 IN THE OFFICE OF THE RECORDER FOR THE COUNTY OF RIVERSIDE, STATE OF CALIFORNIA. FEE: \$ 12.00

*Nancy Stearns S. Olson*, DEPUTY  
COUNTY RECORDER OF THE COUNTY OF RIVERSIDE

| LOT DESIGNATION | ASSESSOR'S PARCEL NO |
|-----------------|----------------------|
| 1               | 476320001            |
| 2               | 476320002            |
| 3               | 476320003            |
| 4               | 476320004            |
| 5               | 476320005            |
| 6               | 476321001            |
| 7               | 476321002            |
| 8               | 476321003            |
| 9               | 476321004            |
| 10              | 476321005            |
| 11              | 476321006            |
| 12              | 476321007            |
| 13              | 476321008            |
| 14              | 476321009            |
| 15              | 476321010            |
| 16              | 476321014            |
| 17              | 476321011            |
| 18              | 476321012            |
| 19              | 476321013            |
| 20              | 476322001            |
| 21              | 476322002            |
| 22              | 476322003            |
| 23              | 476322004            |
| 24              | 476322005            |
| 25              | 476322006            |
| 26              | 476322007            |
| 27              | 476322008            |
| 28              | 476322009            |
| 29              | 476322010            |
| 30              | 476322011            |
| 31              | 476322012            |
| 32              | 476322013            |
| 33              | 476322014            |
| 34              | 476322015            |
| 35              | 476322016            |
| 36              | 476322017            |
| 37              | 476322018            |
| 38              | 476322019            |
| 39              | 476323001            |
| 40              | 476323002            |
| 41              | 476323003            |
| 42              | 476323004            |
| 43              | 476323005            |
| 44              | 476323006            |
| 45              | 476323007            |
| 46              | 476323008            |
| 47              | 476323009            |
| 48              | 476323010            |
| 49              | 476323011            |
| 50              | 476323012            |
| 51              | 476323013            |

| LOT DESIGNATION | ASSESSOR'S PARCEL NO |
|-----------------|----------------------|
| 52              | 476323014            |
| 53              | 476323015            |
| 54              | 476323016            |
| 55              | 476323017            |
| 56              | 476323018            |
| 57              | 476323019            |
| 58              | 476323020            |
| 59              | 476323021            |
| 60              | 476323022            |
| 61              | 476323023            |
| 62              | 476323024            |
| 63              | 476323025            |
| 64              | 476323026            |
| 65              | 476323027            |
| 66              | 476323028            |
| 67              | 476323029            |
| 68              | 476323030            |
| 69              | 476323031            |
| 70              | 476323032            |
| 71              | 476323033            |
| 72              | 476323034            |
| 73              | 476323035            |
| 74              | 476323036            |
| 75              | 476323037            |
| 76              | 476330001            |
| 77              | 476330002            |
| 78              | 476330003            |
| 79              | 476330004            |
| 80              | 476330005            |
| 81              | 476330006            |
| 82              | 476330007            |
| 83              | 476330008            |
| 84              | 476330009            |
| 85              | 476330010            |
| 86              | 476330011            |
| 87              | 476330012            |
| 88              | 476330013            |
| 89              | 476330014            |
| 90              | 476331001            |
| 91              | 476331002            |
| 92              | 476331003            |
| 93              | 476331004            |
| 94              | 476331005            |
| 95              | 476331006            |
| 96              | 476331007            |
| 97              | 476331008            |
| 98              | 476332005            |
| 99              | 476332001            |
| 100             | 476332002            |
| 101             | 476332003            |
| 102             | 476332004            |

| LOT DESIGNATION | ASSESSOR'S PARCEL NO |
|-----------------|----------------------|
| 103             | 476333001            |
| 104             | 476333002            |
| 105             | 476333003            |
| 106             | 476333004            |
| 107             | 476333005            |
| 108             | 476333006            |
| 109             | 476333007            |
| 110             | 476333008            |
| 111             | 476333009            |
| 112             | 476333010            |
| 113             | 476333011            |
| 114             | 476333012            |
| 115             | 476333013            |
| 116             | 476333014            |
| 117             | 476333015            |
| 118             | 476340001            |
| 119             | 476340002            |
| 120             | 476340003            |
| 121             | 476340004            |
| 122             | 476340005            |
| 123             | 476340006            |
| 124             | 476340007            |
| 125             | 476340008            |
| 126             | 476340009            |
| 127             | 476340010            |
| 128             | 476340011            |
| 129             | 476340012            |
| 130             | 476340013            |
| 131             | 476340014            |
| 132             | 476340015            |
| 133             | 476340016            |
| 134             | 476340017            |
| 135             | 476340018            |
| 136             | 476340019            |
| 137             | 476340020            |
| 138             | 476340021            |
| 139             | 476340022            |
| 140             | 476340023            |
| 141             | 476340024            |
| 142             | 476340025            |
| 143             | 476340026            |
| 144             | 476340027            |
| 145             | 476340028            |
| 146             | 476340029            |
| 147             | 476340030            |
| 148             | 476340031            |
| 149             | 476340032            |
| 150             | 476340033            |
| 151             | 476340034            |
| 152             | 476340035            |
| 153             | 476340037            |

**S DFA**  
SPECIAL DISTRICT FINANCING  
& ADMINISTRATION  
  
437 WEST GRAND AVENUE  
ESCONDIDO, CALIFORNIA 92025  
TELEPHONE: (760)233-2630  
FAX: (760)233-2631

PROPOSED BOUNDARY MAP OF  
COMMUNITY FACILITIES DISTRICT NO. 2005-1  
OF HEMET UNIFIED SCHOOL DISTRICT  
RIVERSIDE COUNTY  
STATE OF CALIFORNIA

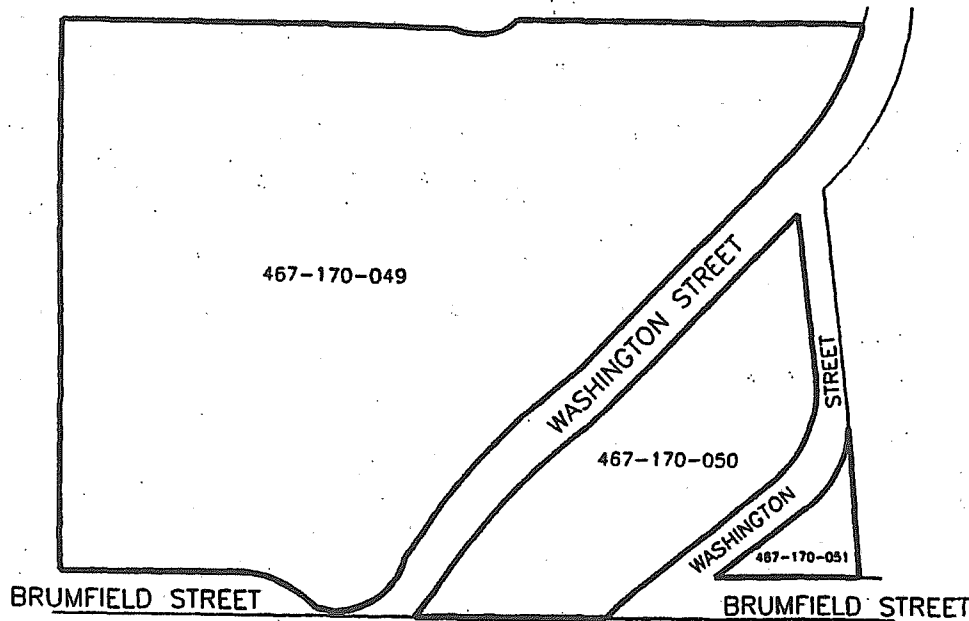

(1) Filed in the office of the Secretary of the Governing Board this \_\_\_ day of \_\_\_\_\_, 20\_\_.

Philip O. Pendley  
Secretary of the Governing Board

(2) I hereby certify that the within map showing the boundaries of Community Facilities District No. 2005-1 of the Hemet Unified School District, Riverside County, State of California, was approved by the Governing Board at a regular meeting thereof, held on this \_\_\_ day of \_\_\_\_\_, 20\_\_ by its Resolution No. \_\_\_\_\_.

Philip O. Pendley  
Secretary of the Governing Board

(3) Filed this \_\_\_ day of \_\_\_\_\_, 20\_\_ of the hour \_\_\_ o'clock \_\_\_ m, in Book \_\_\_ of Maps of Assessment and Community Facilities Districts of page \_\_\_ and as Instrument No. \_\_\_ in the office of the County Recorder of Riverside County, State of California.

County Recorder of Riverside County

Reference is hereby made to the Assessor maps of the County of Riverside for an exact description of the lines and dimensions of each lot and parcel.

LEGEND

|  |  |
|--|--|
|  | Boundaries of Community Facilities District No. 2005-1 |
|  | Assessor Parcel Boundary                               |
|  | Riverside County Assessor Parcel Number                |

PREPARED BY  
DAVID TAUSSIG & ASSOCIATES, INC.

Recorded May 26, 2005 Book 62 Page 82  
Instrument No. 2005-423072