

# PROPOSED BOUNDARY MAP OF COMMUNITY FACILITIES DISTRICT NO. 06-1

## TUSTIN UNIFIED SCHOOL DISTRICT COUNTY OF ORANGE, STATE OF CALIFORNIA

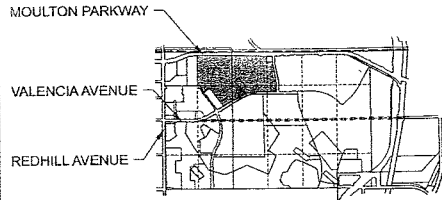

VICINITY MAP

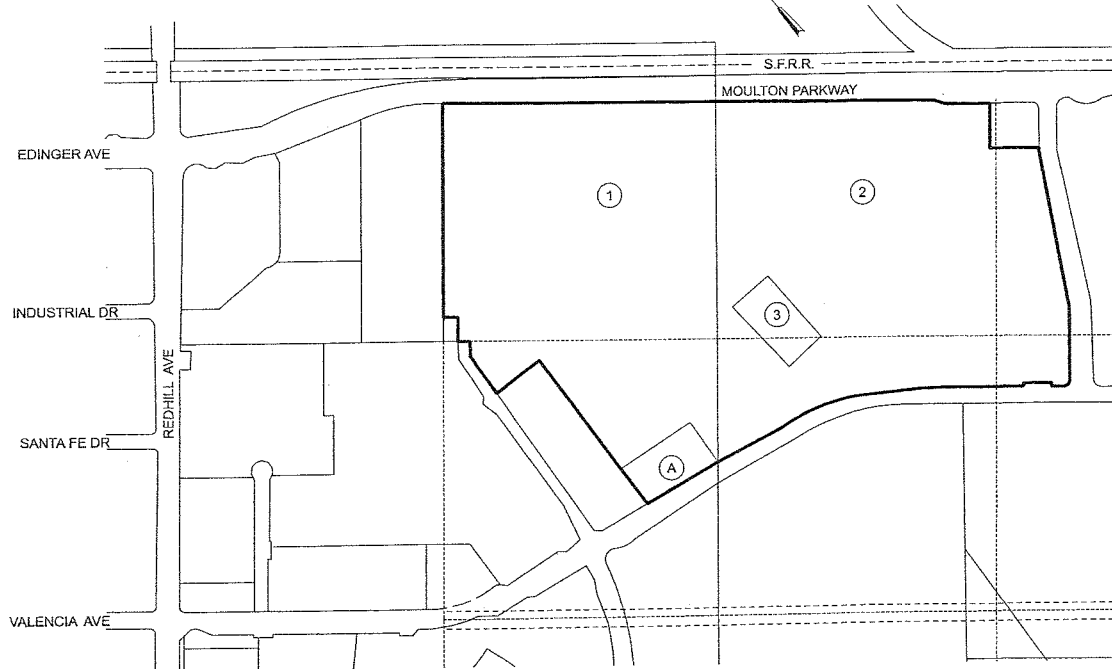

LOT DESIGNATION	
LOT NO.	ASSESSOR'S PARCEL NO.
1	430-282-18
2	434-061-53
3	434-061-54
A	PORTION OF LOT 10 OF TRACT NO. 16857 RECORDED ON JULY 19, 2005 WHICH IS NOT INCLUDED IN APN 430-282-18 (LOT NO. 1 OF THIS BOUNDARY MAP) AND HAS NOT YET BEEN ASSIGNED AN ASSESSOR'S PARCEL NUMBER BY THE COUNTY OF ORANGE.

LEGEND:

- ① ORANGE COUNTY ASSESSOR'S PARCEL NUMBER
- COMMUNITY FACILITIES DISTRICT BOUNDARY

FILED IN THE OFFICE OF THE SECRETARY OF THE BOARD OF EDUCATION THIS 30<sup>th</sup> DAY OF MAY, 2006.

*Peter C. Gorman*  
 PETER C. GORMAN, ED.D.  
 SECRETARY OF THE BOARD OF EDUCATION  
 TUSTIN UNIFIED SCHOOL DISTRICT  
 STATE OF CALIFORNIA

I HEREBY CERTIFY THAT THE WITHIN MAP SHOWING PROPOSED BOUNDARIES OF COMMUNITY FACILITIES DISTRICT NO. 06-1 OF THE TUSTIN UNIFIED SCHOOL DISTRICT, COUNTY OF ORANGE, STATE OF CALIFORNIA, WAS APPROVED BY THE BOARD OF EDUCATION AT A REGULAR MEETING THEREOF, HELD ON THE 27<sup>th</sup> DAY OF MAY, 2006, BY ITS RESOLUTION NO. 06-1-03.

*Peter C. Gorman*  
 PETER C. GORMAN, ED.D.  
 SECRETARY OF THE BOARD OF EDUCATION  
 TUSTIN UNIFIED SCHOOL DISTRICT  
 STATE OF CALIFORNIA

Recording Requested by Tustin Unified School District

FILED THIS 12<sup>th</sup> DAY OF May, 2006, AT THE HOUR OF 10:16 O'CLOCK A.M. IN BOOK 91 AND PAGE 36 OF MAPS OF ASSESSMENT AND COMMUNITY FACILITIES DISTRICTS IN THE OFFICE OF THE COUNTY RECORDER IN THE COUNTY OF ORANGE, CALIFORNIA. Document Number 2006-000334544 Fee \$7-

*Tom Daly*  
 Tom Daly, COUNTY RECORDER  
 COUNTY OF ORANGE  
 STATE OF CALIFORNIA  
 Deputy

NOTES:

1. FOR PARTICULARS OF LINES AND DIMENSIONS OF ASSESSOR'S PARCELS, REFERENCE IS MADE TO THE ORANGE COUNTY ASSESSOR PARCEL MAPS.
2. ALL PROPERTY LOCATED WITHIN THE CFD BOUNDARY IS LOCATED IN THE CITY OF TUSTIN.

SHEET 1 OF 1  
 DATE APRIL 2006  
 JOB NO. CFD061-03-06-R1

# SDFA

SPECIAL DISTRICT FINANCING  
& ADMINISTRATION

437 WEST GRAND AVENUE  
ESCONDIDO, CALIFORNIA 92025  
TELEPHONE: (760)233-2630  
FAX: (760)233-2631

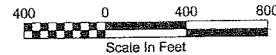

93  
5

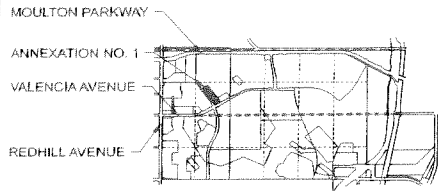

VICINITY MAP

LEGEND:

- ① ORANGE COUNTY ASSESSOR'S PARCEL NUMBER
- COMMUNITY FACILITIES DISTRICT BOUNDARY

FILED IN THE OFFICE OF THE SECRETARY OF THE BOARD OF EDUCATION  
THIS 27TH DAY OF MARCH 2008.

*Richard Bray*  
RICHARD BRAY  
SECRETARY OF THE BOARD OF EDUCATION  
TUSTIN UNIFIED SCHOOL DISTRICT  
STATE OF CALIFORNIA

I HEREBY CERTIFY THAT THE WITHIN MAP SHOWING BOUNDARIES OF PROPOSED ANNEXATION NO. 1 TO COMMUNITY FACILITIES DISTRICT NO. 06-1, OF THE TUSTIN UNIFIED SCHOOL DISTRICT, COUNTY OF ORANGE, STATE OF CALIFORNIA WAS APPROVED BY THE BOARD OF EDUCATION AT A REGULAR MEETING THEREOF, HELD ON THE 31ST DAY OF MARCH, 2008, BY ITS RESOLUTION NO. 08-1-17. THIS BOUNDARY MAP AFFECTS THE BOUNDARY MAP FOR COMMUNITY FACILITIES DISTRICT NO. 06-1 OF THE TUSTIN UNIFIED SCHOOL DISTRICT, COUNTY OF ORANGE, STATE OF CALIFORNIA, PRIOR RECORDED AT BOOK 91 AND PAGE 36 OF MAPS OF ASSESSMENT AND COMMUNITY FACILITIES DISTRICTS ON MAY 18, 2006 IN THE OFFICE OF THE COUNTY RECORDER FOR THE COUNTY OF ORANGE, STATE OF CALIFORNIA.

*Richard Bray*  
RICHARD BRAY  
SECRETARY OF THE BOARD OF EDUCATION  
TUSTIN UNIFIED SCHOOL DISTRICT  
STATE OF CALIFORNIA

Recording Requested by Tustin Unified School District  
FILED THIS 1 DAY OF APRIL, 2008, AT THE HOUR OF 2:44 O'CLOCK P.M.  
IN BOOK 92 AND PAGE 5 OF MAPS OF ASSESSMENT AND COMMUNITY FACILITIES DISTRICTS IN THE OFFICE OF THE COUNTY RECORDER IN THE COUNTY OF ORANGE, CALIFORNIA. Instrument # 200800150388 Fee \$7.00

*Tom Daly*  
COUNTY RECORDER  
COUNTY OF ORANGE  
STATE OF CALIFORNIA  
Tom Daly

BOUNDARY MAP  
OF PROPOSED ANNEXATION NO. 1 TO  
COMMUNITY FACILITIES DISTRICT NO. 06-1 TO THE  
TUSTIN UNIFIED SCHOOL DISTRICT  
COUNTY OF ORANGE, STATE OF CALIFORNIA  
CITY OF TUSTIN



LOT DESIGNATION	
LOT NO.	ASSESSOR'S PARCEL NO.
1	430-362-25
2	430-362-26
3	430-362-27
4	430-362-28
5	430-362-29
6	430-362-31
7	430-351-01
8	430-351-55
9	430-351-54
10	430-351-53
11	430-351-82
12	430-352-01
13	430-352-02
14	430-352-46
15	430-352-47
16	430-352-12
17	430-352-11
18	430-352-10
19	430-352-09
20	430-352-45
21	430-352-48
22	430-352-43
23	430-352-13
24	430-352-14
25	430-352-15
26	430-352-16
27	430-352-41
28	430-352-42
29	430-352-31
30	430-352-32
31	430-352-30
32	430-352-29

NOTES:

1. FOR PARTICULARS OF LINES AND DIMENSIONS OF ASSESSOR'S PARCELS, REFERENCE IS MADE TO THE ORANGE COUNTY ASSESSOR PARCEL MAPS.
2. ALL PROPERTY LOCATED WITHIN THE PROPOSED ANNEXATION BOUNDARY IS LOCATED IN THE CITY OF TUSTIN.



**SDFA**  
SPECIAL DISTRICT FINANCING  
& ADMINISTRATION

437 WEST GRAND AVENUE  
ESCONDIDO, CALIFORNIA 92025  
TELEPHONE: (760)233-2630  
FAX: (760)233-2631

SHEET	1 OF 1
DATE	JANUARY 2008
JOB NO.	AN061-1207

BK 93 PG 5