

BOUNDARY MAP OF PROPOSED BOUNDARIES OF
REDLANDS UNIFIED SCHOOL DISTRICT
COMMUNITY FACILITIES DISTRICT NO. 2016-1
SAN BERNARDINO COUNTY
STATE OF CALIFORNIA

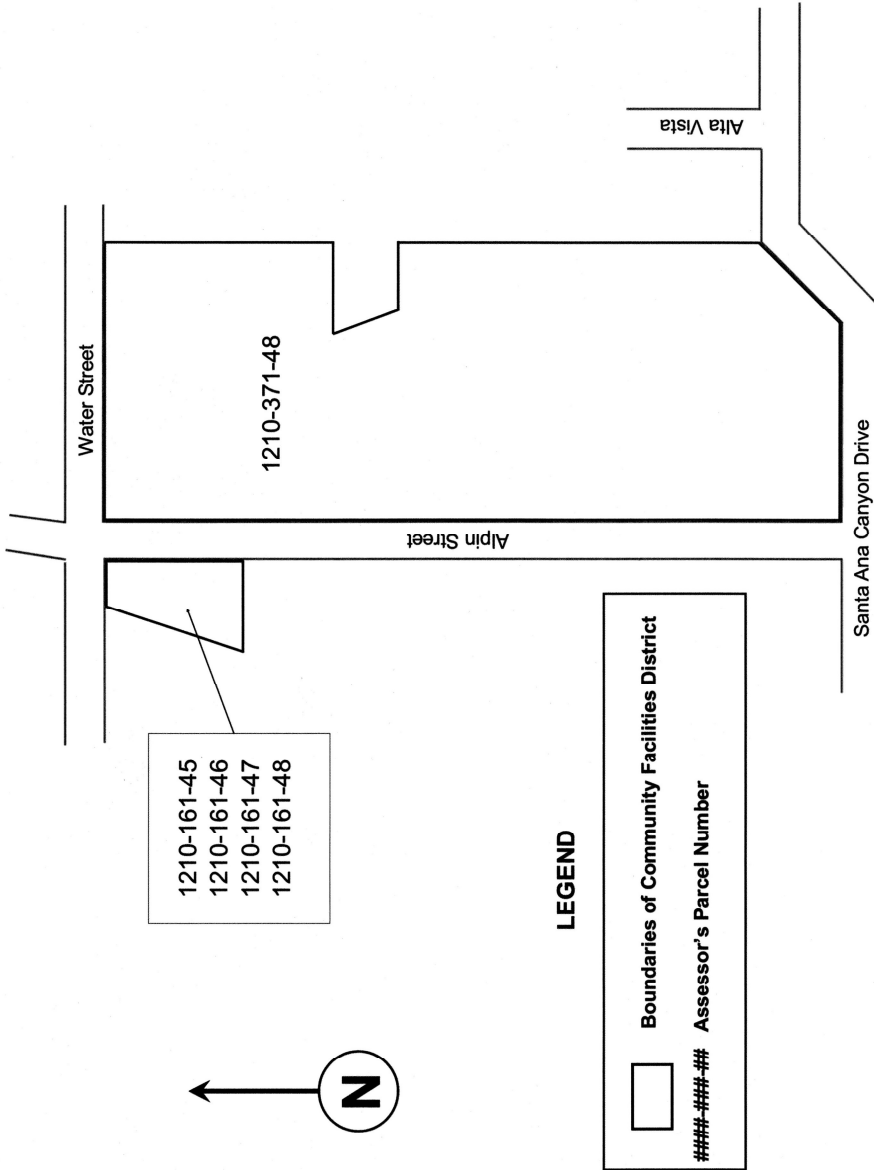

(1) Filed in the office of the Clerk of the Board of Education of the Redlands Unified School District this 13 day of September, 2016.

Donna West
Donna West, Clerk of the Board of Education
Redlands Unified School District

(2) I hereby certify that the within map showing the proposed boundaries of Community Facilities District No. 2016-1 of the Redlands Unified School District, San Bernardino County, State of California, was approved by the Board of Education of the Redlands Unified School District at the regular meeting thereof, held on this 13 day of September, 2016 by its Resolution No. 13,206-17.

Donna West
Donna West, Clerk of the Board of Education
Redlands Unified School District

(3) THIS MAP HAS BEEN FILED UNDER DOCUMENT NUMBER 2016-0399750, THIS 27th DAY OF SEPTEMBER, 2016, AT 10:37 A.M. IN BOOK 87, OF ASSESSMENT MAPS AT PAGE(S) 24-28, AT THE REQUEST OF REDLANDS UNIFIED SCHOOL DISTRICT IN THE AMOUNT OF \$ 18.00.

BOB DUTTON
ASSESSOR — RECORDER
COUNTY OF SAN BERNARDINO

BY: Mick Duran-Loss
DEPUTY RECORDER

Recorded in Office of Recorder,
County of San Bernardino,
Assessor's Office
2016092704 10:37 AM

Reference is hereby made to the Assessor maps of the County of San Bernardino for an exact description of the lines and dimensions of each lot and parcel.

BOUNDARY MAP OF PROPOSED BOUNDARIES OF
REDLANDS UNIFIED SCHOOL DISTRICT
COMMUNITY FACILITIES DISTRICT NO. 2016-1
SAN BERNARDINO COUNTY
STATE OF CALIFORNIA

1212-451-42 1212-451-52
1212-451-43 1212-451-53
1212-451-44 1212-451-54
1212-451-45 1212-451-55
1212-451-46 1212-451-56
1212-451-47 1212-451-57
1212-451-48 1212-451-58
1212-451-49 1212-451-59
1212-451-50 1212-451-60
1212-451-51 1212-451-61

1212-451-07
1212-451-08
1212-451-09
1212-451-10
1212-451-11

LEGEND

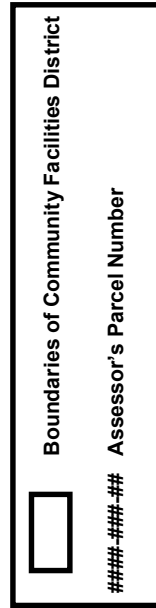
 Boundaries of Community Facilities District
###-###-## Assessor's Parcel Number

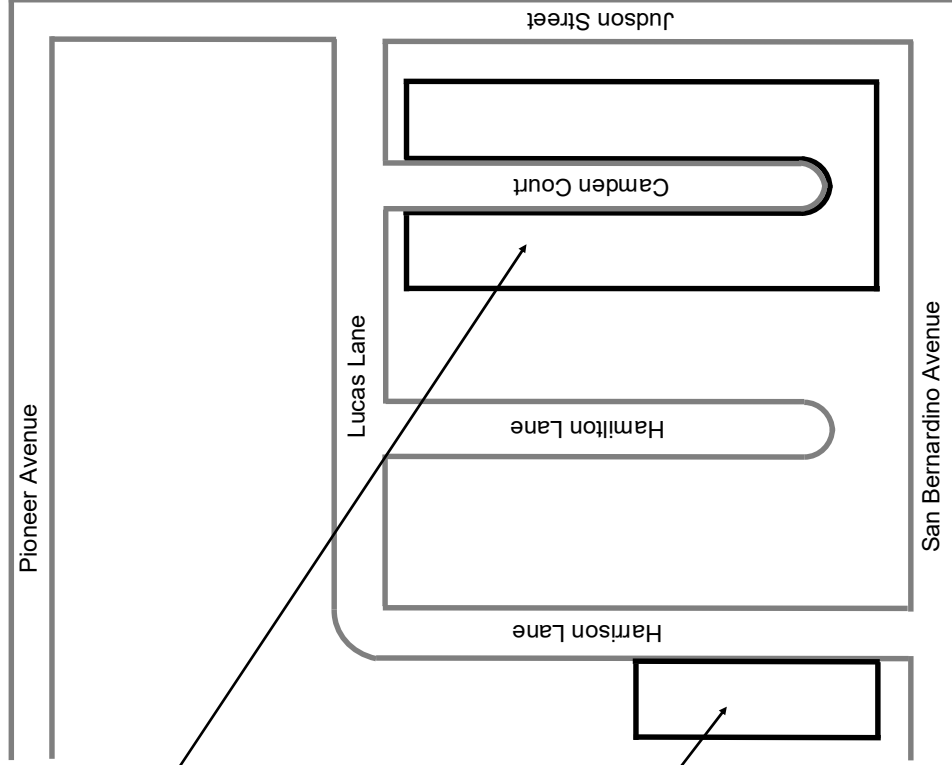

BOUNDARY MAP OF PROPOSED BOUNDARIES OF
REDLANDS UNIFIED SCHOOL DISTRICT
COMMUNITY FACILITIES DISTRICT NO. 2016-1
SAN BERNARDINO COUNTY
STATE OF CALIFORNIA

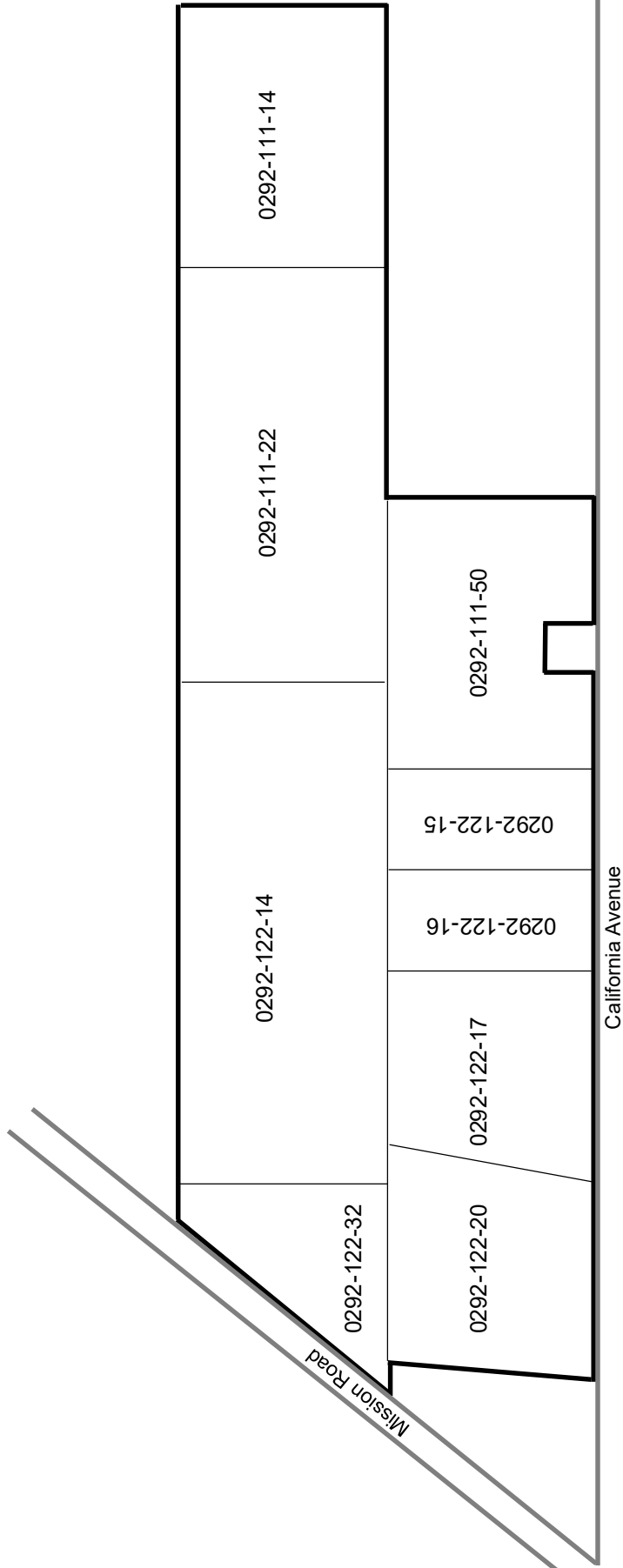

LEGEND

Boundaries of Community Facilities District

Boundaries of Assessor's Parcels

####-###-## Assessor's Parcel Number



Prepared by:
California Financial Services

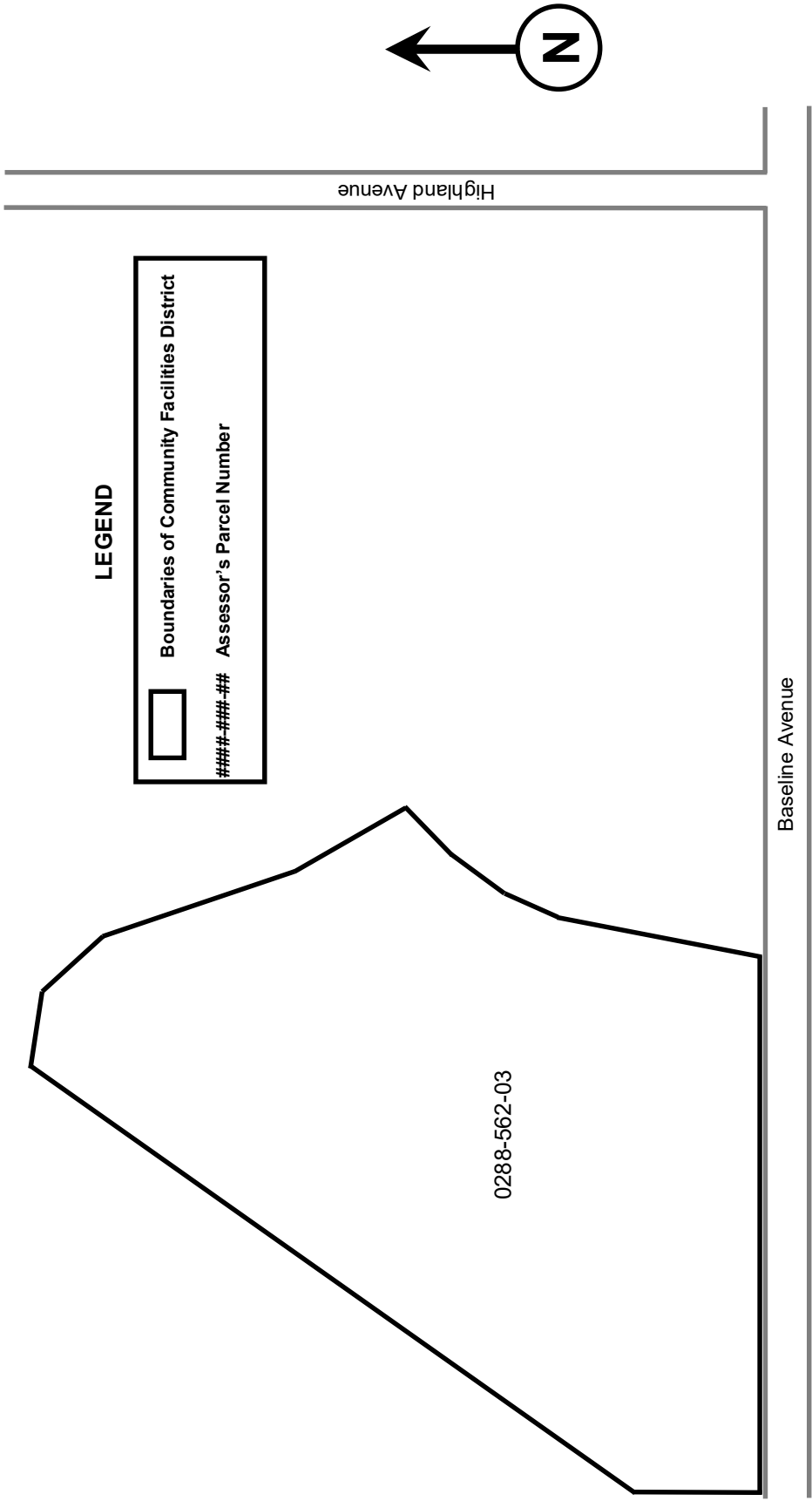

BOUNDARY MAP OF PROPOSED BOUNDARIES OF
REDLANDS UNIFIED SCHOOL DISTRICT
COMMUNITY FACILITIES DISTRICT NO. 2016-1
SAN BERNARDINO COUNTY
STATE OF CALIFORNIA

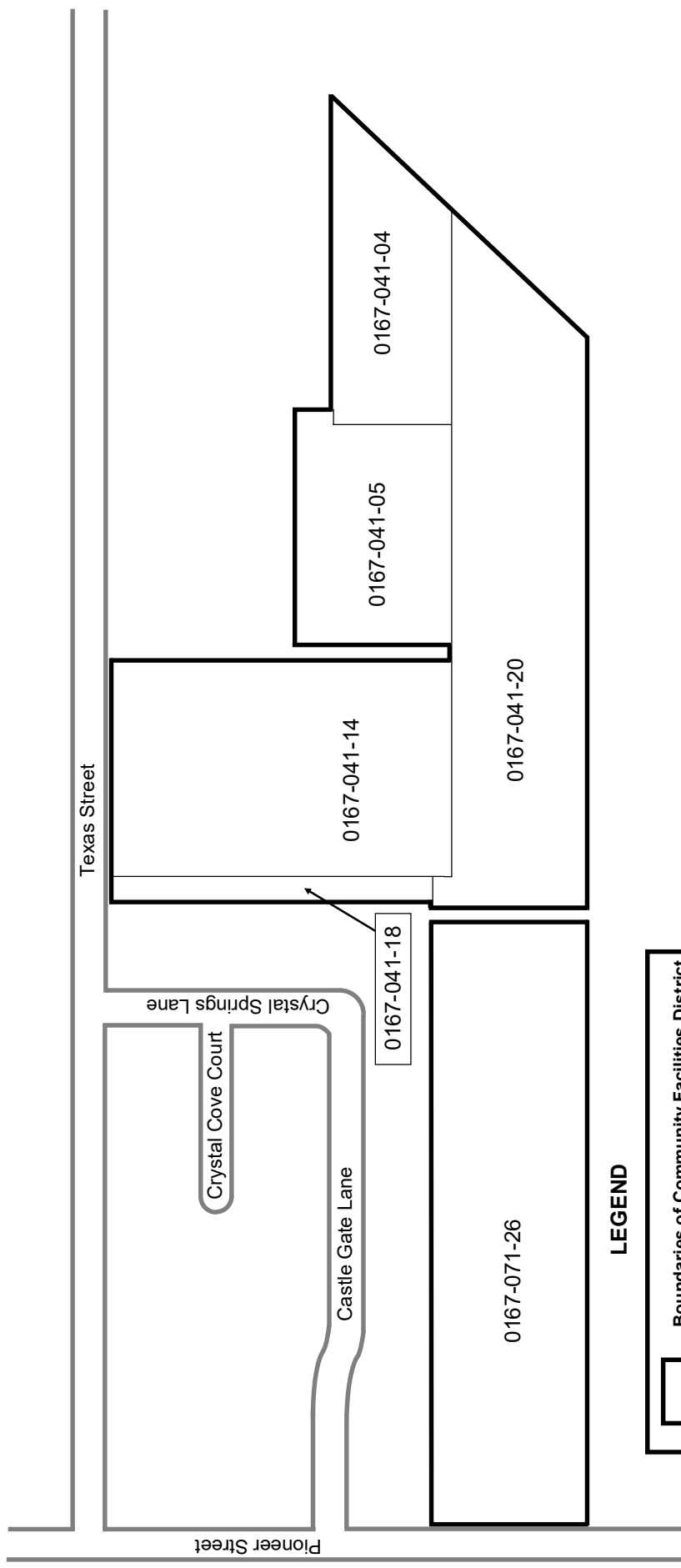

BOUNDARY MAP OF PROPOSED BOUNDARIES OF
REDLANDS UNIFIED SCHOOL DISTRICT
COMMUNITY FACILITIES DISTRICT NO. 2016-1
SAN BERNARDINO COUNTY
STATE OF CALIFORNIA



LEGEND

	Boundaries of Community Facilities District
	Boundaries of Assessor's Parcels
###-###-##	Assessor's Parcel Number



Prepared by:
California Financial Services

BOUNDARY MAP OF
ANNEXATION NO. 1 TO
COMMUNITY FACILITIES DISTRICT NO. 2016-1 OF THE
REDLANDS UNIFIED SCHOOL DISTRICT
SAN BERNARDINO COUNTY

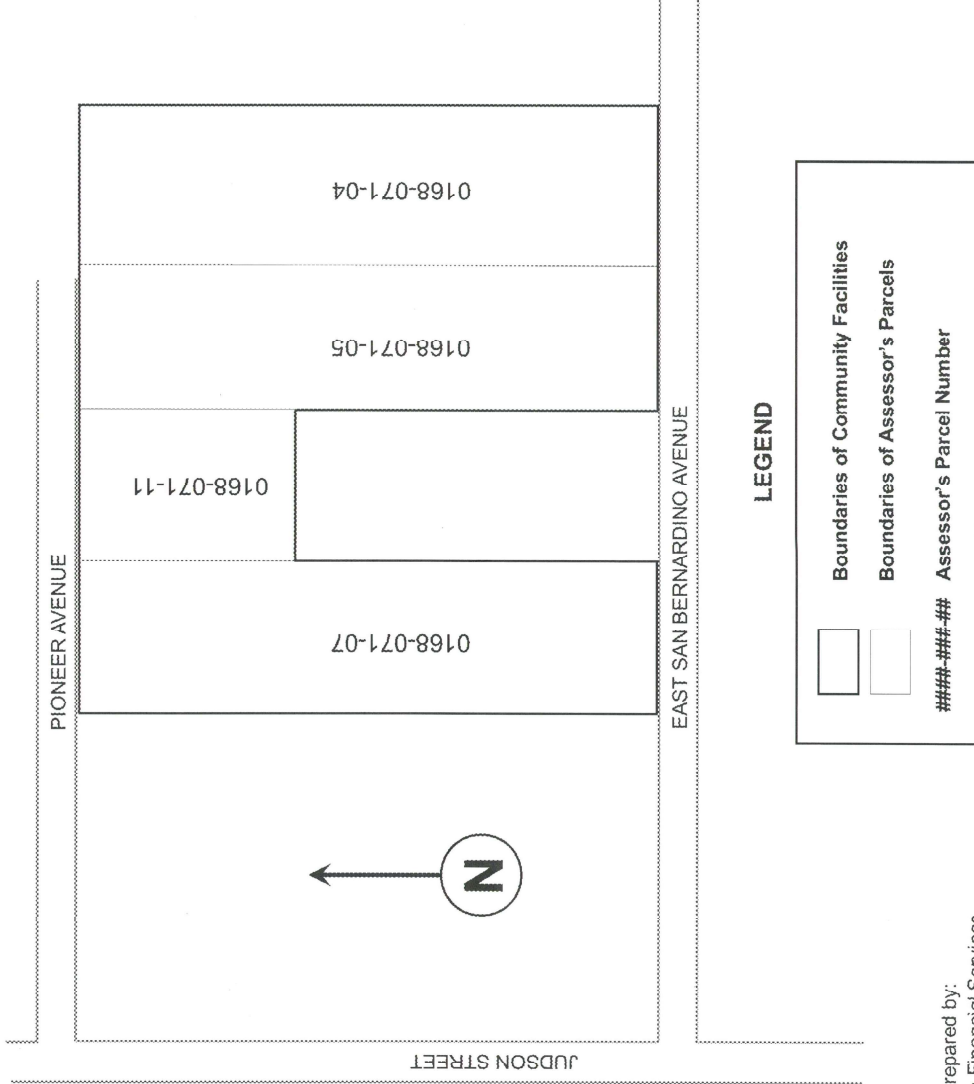

(1) Filed in the office of the Clerk of the Board of Education of the Redlands Unified School District this 9 day of May, 2017

Jim O'Neill
Jim O'Neill, Clerk of the Board of Education
Redlands Unified School District

(2) I hereby certify that the within map showing the proposed boundaries of Annexation No. 1 to the Community Facilities District No. 2016-1 of the Redlands Unified School District, San Bernardino County, State of California, was approved by the Board of Education of the Redlands Unified School District at the regular meeting thereof, held on this 9 day of May, 2017 by its Resolution No. 42,2016-17

Jim O'Neill
Jim O'Neill, Clerk of the Board of Education
Redlands Unified School District

(3) THIS MAP HAS BEEN FILED UNDER DOCUMENT NUMBER 2017 0203447, THIS 17 DAY OF MAY, 2017 AT 2:16 P. M. IN BOOK 87 OF BOUNDARY MAP AT PAGE(S) 44-51, AT THE REQUEST OF REDLANDS UNIFIED SCHOOL DISTRICT, IN THE AMOUNT OF \$ 17.00

BOB DUTTON
ASSESSOR - RECORDER
COUNTY OF SAN BERNARDINO

BY: Sharon Garcia
DEPUTY RECORDER

Reference is hereby made to the Assessor maps of the County of San Bernardino for an exact description of the lines and dimensions of each lot and parcel.

BOUNDARY MAP OF
ANNEXATION NO. 1 TO
COMMUNITY FACILITIES DISTRICT NO. 2016-1 OF THE
REDLANDS UNIFIED SCHOOL DISTRICT
SAN BERNARDINO COUNTY

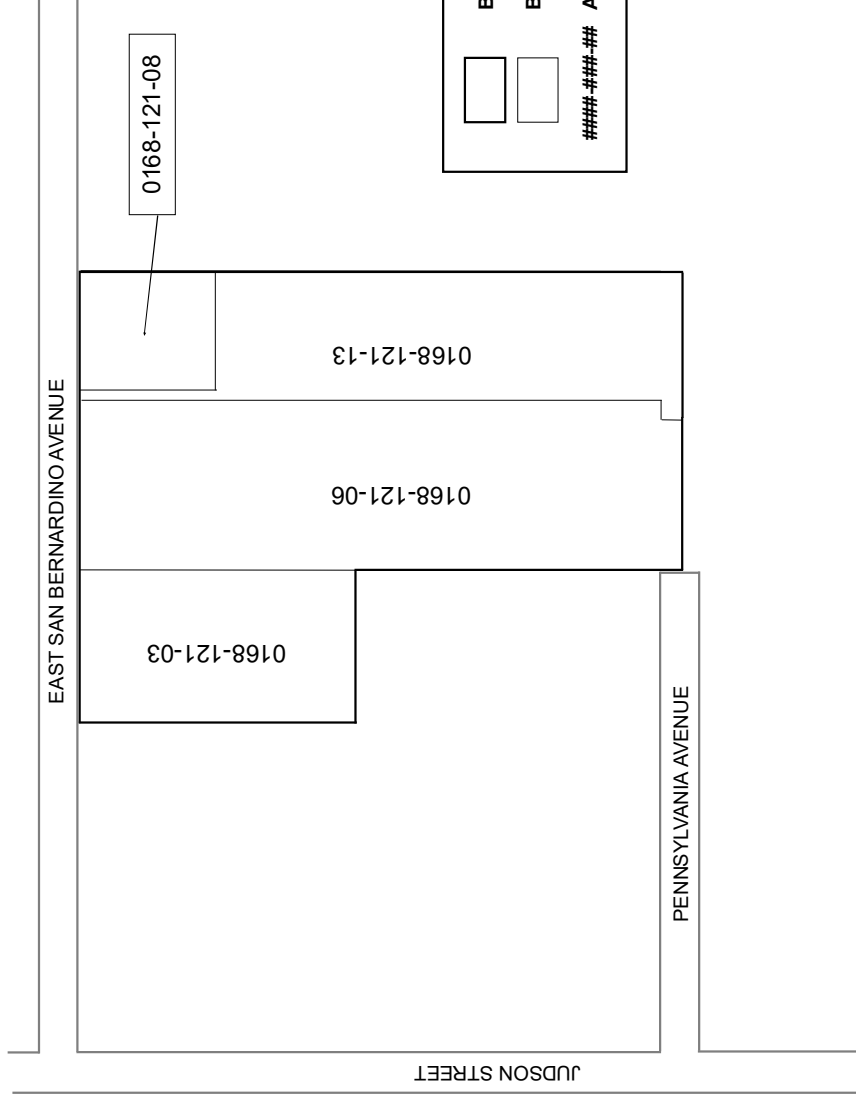
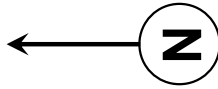

LEGEND

	Boundaries of Community Facilities
	Boundaries of Assessor's Parcels
####-###-##	Assessor's Parcel Number

Reference is hereby made to the Assessor maps of the County of San Bernardino for an exact description of the lines and dimensions of each lot and parcel.

BOUNDARY MAP OF
 ANNEXATION NO. 1 TO
 COMMUNITY FACILITIES DISTRICT NO. 2016-1 OF THE
 REDLANDS UNIFIED SCHOOL DISTRICT
 SAN BERNARDINO COUNTY

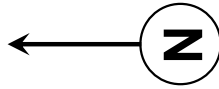
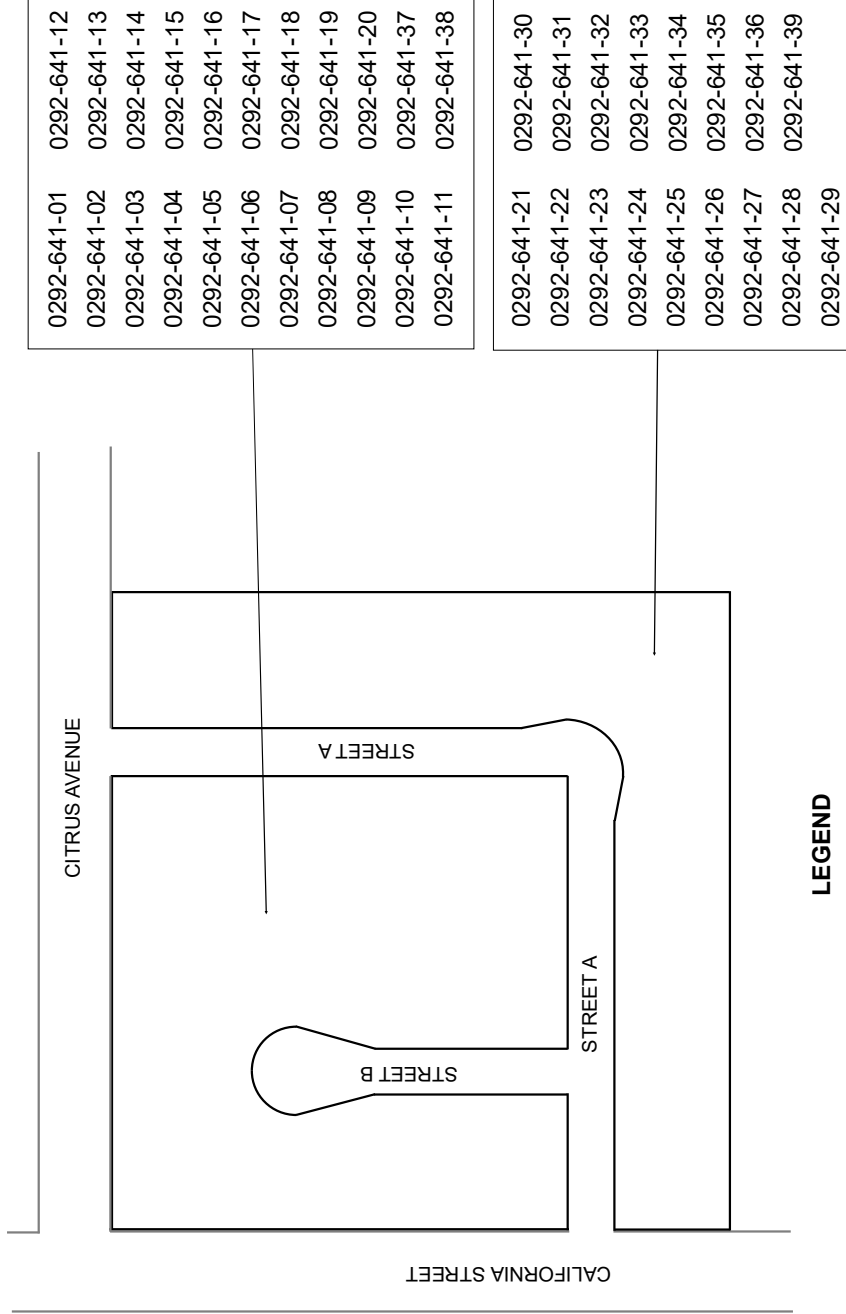

LEGEND

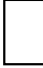
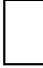
 Boundaries of Community Facilities District
 ####-###-## Assessor's Parcel Number

Reference is hereby made to the Assessor maps of the County of San Bernardino for an exact description of the lines and dimensions of each lot and parcel.

18/18

SHEET 1 OF 3

BOUNDARY MAP OF
ANNEXATION NO. 2 TO
COMMUNITY FACILITIES DISTRICT NO. 2016-1 OF THE
REDLANDS UNIFIED SCHOOL DISTRICT
SAN BERNARDINO COUNTY

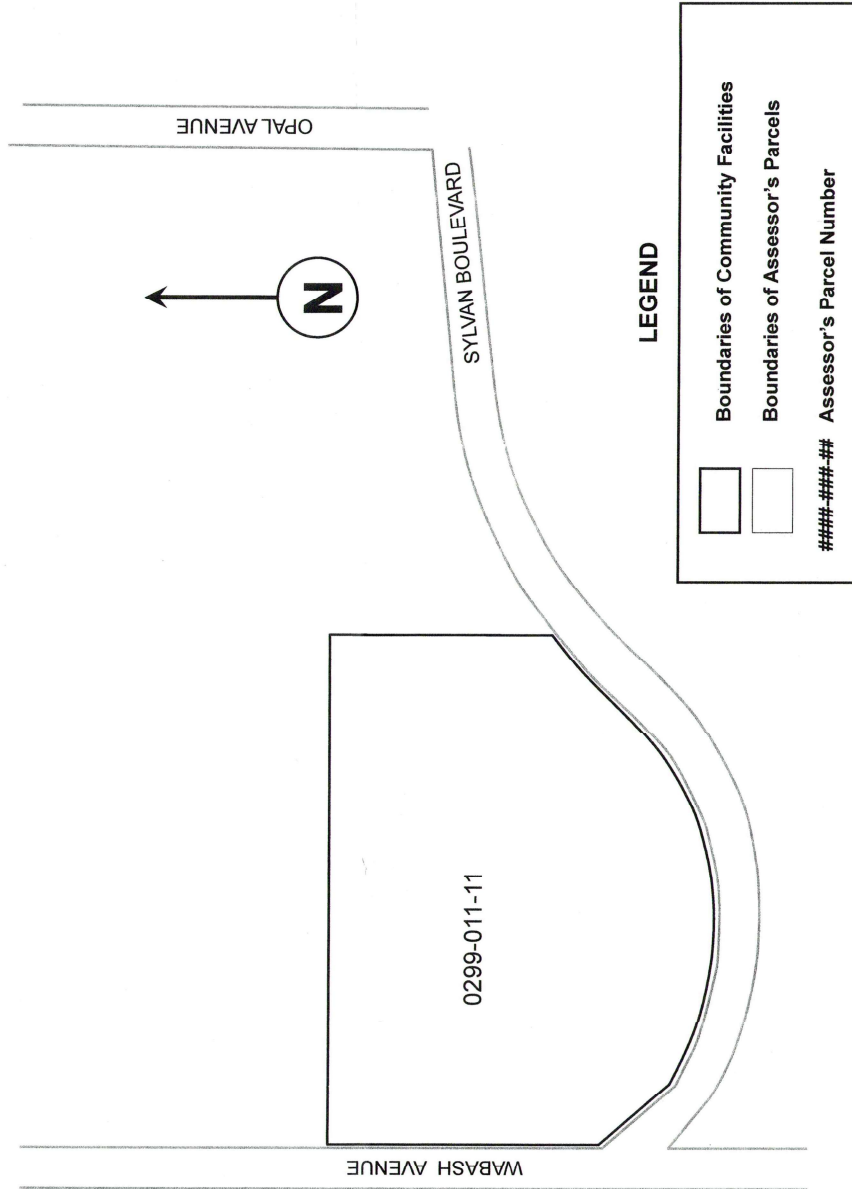

(1) Filed in the office of the Clerk of the Board of Education of the Redlands Unified School District this 13th day of FEBRUARY, 2018

AK
Alex Vara, Clerk of the Board of Education
Redlands Unified School District

(2) I hereby certify that the within map showing the proposed boundaries of Annexation No. 2 to the Community Facilities District No. 2016-1 of the Redlands Unified School District, San Bernardino County, State of California, was approved by the Board of Education of the Redlands Unified School District at the regular meeting thereof, held on this 13th day of FEBRUARY 2018 by its Resolution No. 20, 2017-18.

AK
Alex Vara, Clerk of the Board of Education
Redlands Unified School District

(3) THIS MAP HAS BEEN FILED UNDER DOCUMENT NUMBER 2018-0064508, THIS 22nd DAY OF FEBRUARY, 2018, AT 2:52 P. M. IN BOOK 87, OF ASSESSMENT MAPS AT PAGE(S) 81-83 AT THE REQUEST OF REDLANDS UNIFIED SCHOOL DISTRICT IN THE AMOUNT OF \$ 13.00



BOB DUTTON
ASSESSOR — RECORDER
COUNTY OF SAN BERNARDINO
Bob Dutton

Reference is hereby made to the Assessor maps of the County of San Bernardino for an exact description of the lines and dimensions of each lot and parcel.

18/18

BOUNDARY MAP OF
ANNEXATION NO. 2 TO
COMMUNITY FACILITIES DISTRICT NO. 2016-1 OF THE
REDLANDS UNIFIED SCHOOL DISTRICT
SAN BERNARDINO COUNTY

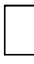
LEGEND

	Boundaries of Community Facilities
	Boundaries of Assessor's Parcels
	Assessor's Parcel Number

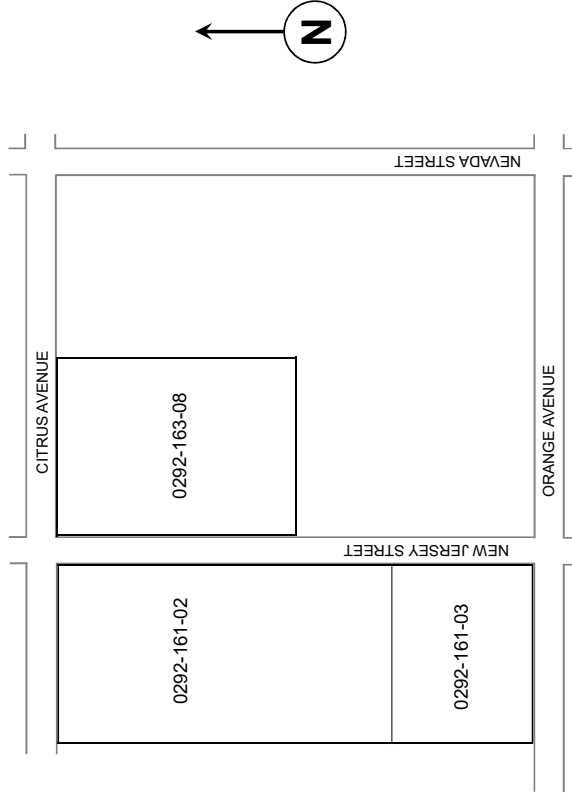



Reference is hereby made to the Assessor maps of the County of San Bernardino for an exact description of the lines and dimensions of each lot and parcel.

SHEET 3 OF 3

BOUNDARY MAP OF
ANNEXATION NO. 2 TO
COMMUNITY FACILITIES DISTRICT NO. 2016-1 OF THE
REDLANDS UNIFIED SCHOOL DISTRICT
SAN BERNARDINO COUNTY
STATE OF CALIFORNIA

PIONEER AVENUE

LEGEND

	Boundaries of Community Facilities
	Boundaries of Assessor's Parcels
####-###-##	Assessor's Parcel Number

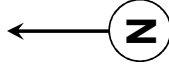

Reference is hereby made to the Assessor maps of the County of San Bernardino for an exact description of the lines and dimensions of each lot and parcel.

Prepared by:
California Financial Services

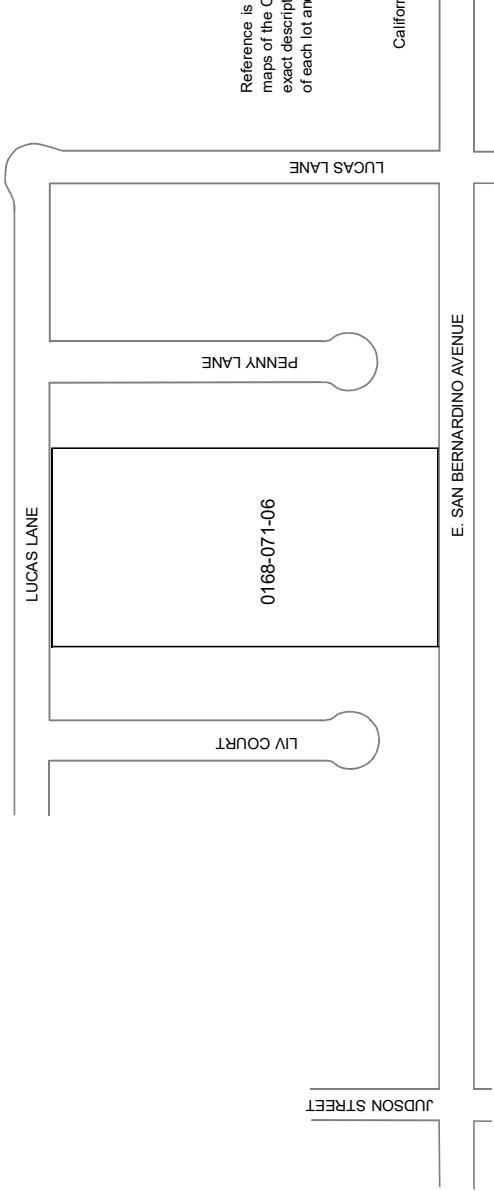

BOUNDARY MAP OF
ANNEXATION NO. 3 TO
COMMUNITY FACILITIES DISTRICT NO. 2016-1 OF THE
REDLANDS UNIFIED SCHOOL DISTRICT
SAN BERNARDINO COUNTY
STATE OF CALIFORNIA

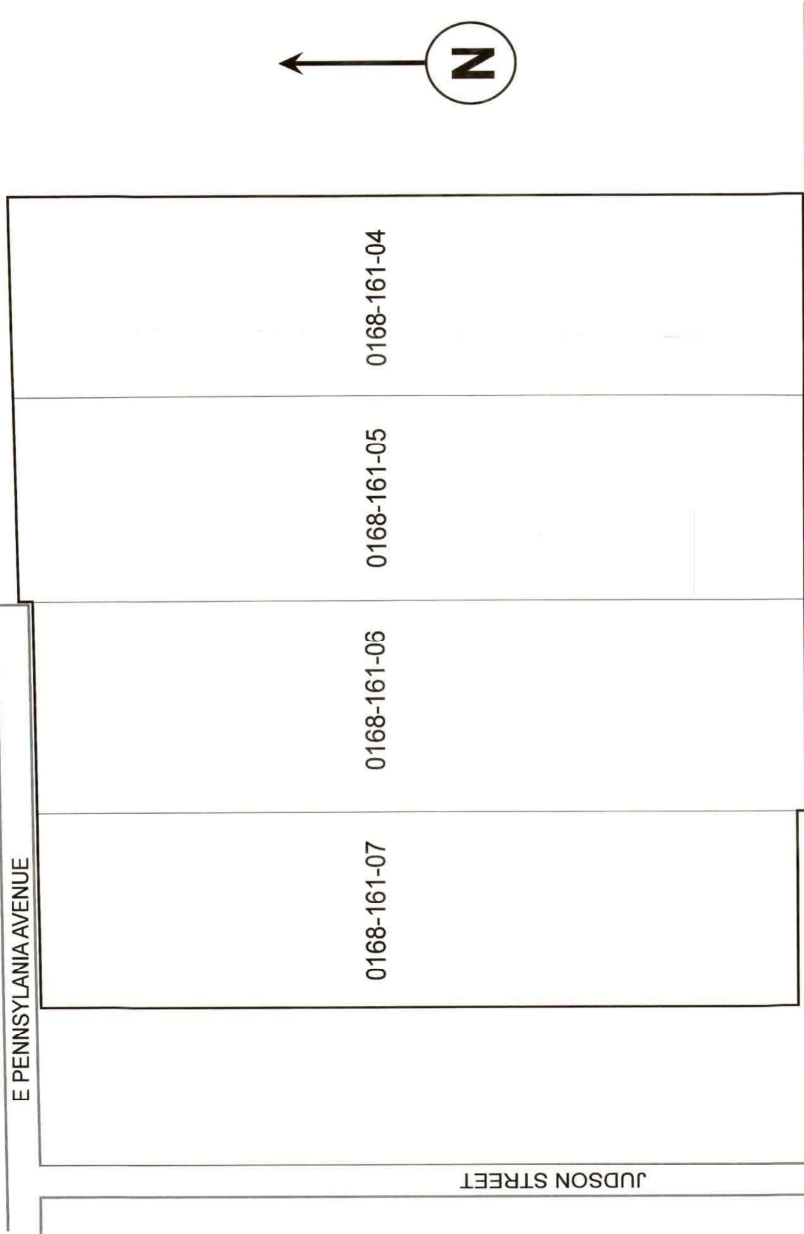

LEGEND

	Boundaries of Community Facilities District
	Boundaries of Assessor's Parcels
####-###-##	Assessor's Parcel Number

Prepared by:
KeyAnalytics

(1) Filed in the office of the Clerk of the Board of Education of the Redlands Unified School District this 11 day of Dec., 2018

Patty S. Holcher
Clerk of the Board of Education
Redlands Unified School District

(2) I hereby certify that the within map showing the proposed boundaries of Annexation No. 3 to the Community Facilities District No. 2016-1 of the Redlands Unified School District, San Bernardino County, State of California, was approved by the Board of Education of the Redlands Unified School District at the regular meeting thereof, held on this 11 day of Dec., 2018 by its Resolution No. 19, 2018-19

Patty S. Holcher
Clerk of the Board of Education
Redlands Unified School District

(3) THIS MAP HAS BEEN FILED UNDER DOCUMENT NUMBER 020180465867, THIS 18 DAY OF December, 2018, AT 11:00 A.M. IN BOOK 88, OF Assessments AT PAGE(S) 9-11 AT THE REQUEST OF _____, IN THE AMOUNT OF \$ _____.

BOB DUTTON
ASSESSOR — RECORDER
COUNTY OF SAN BERNARDINO



BY: _____
DEPUTY RECORDER

Reference is hereby made to the Assessor maps of the County of San Bernardino for an exact description of the lines and dimensions of each lot and parcel.

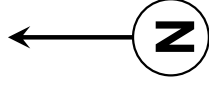
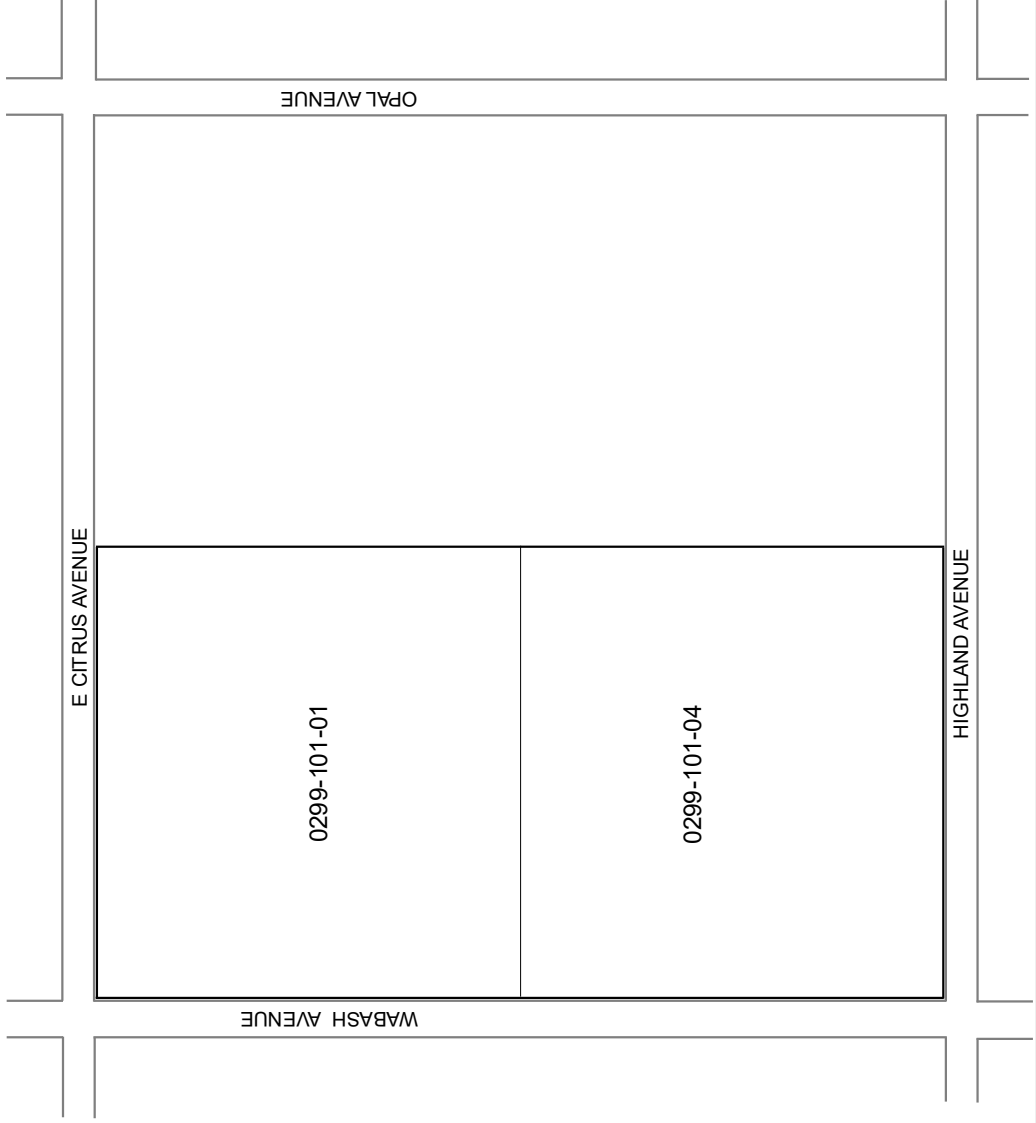
BOUNDARY MAP OF
ANNEXATION NO. 3 TO
COMMUNITY FACILITIES DISTRICT NO. 2016-1 OF THE
REDLANDS UNIFIED SCHOOL DISTRICT
SAN BERNARDINO COUNTY
STATE OF CALIFORNIA



LEGEND



	Boundaries of Community Facilities District
	Boundaries of Assessor's Parcels
####-###-##	Assessor's Parcel Number

Reference is hereby made to the Assessor maps of the County of San Bernardino for an exact description of the lines and dimensions of each lot and parcel.

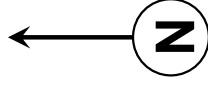
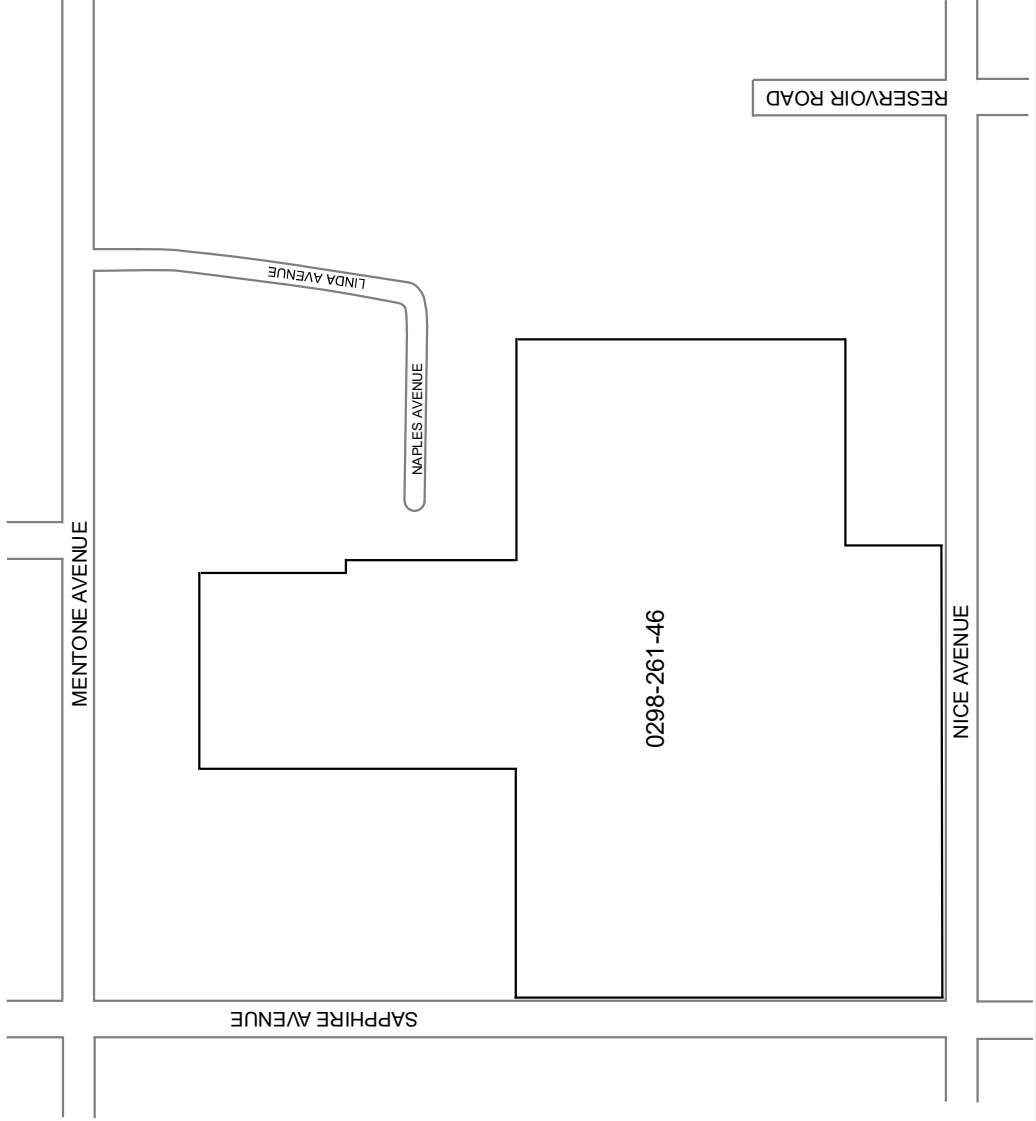
BOUNDARY MAP OF
ANNEXATION NO. 3 TO
COMMUNITY FACILITIES DISTRICT NO. 2016-1 OF THE
REDLANDS UNIFIED SCHOOL DISTRICT
SAN BERNARDINO COUNTY
STATE OF CALIFORNIA

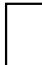

LEGEND

	Boundaries of Community Facilities District
	Boundaries of Assessor's Parcels
####-###-##	Assessor's Parcel Number

Reference is hereby made to the Assessor maps of the County of San Bernardino for an exact description of the lines and dimensions of each lot and parcel.

BOUNDARY MAP OF
ANNEXATION NO. 4 TO
COMMUNITY FACILITIES DISTRICT NO. 2016-1 OF THE
REDLANDS UNIFIED SCHOOL DISTRICT
SAN BERNARDINO COUNTY



NICE AVENUE

CRAFTON AVENUE

0298-531-01	0298-531-23
0298-531-02	0298-531-24
0298-531-03	0298-531-25
0298-531-04	0298-531-26
0298-531-05	0298-531-27
0298-531-06	0298-531-28
0298-531-07	0298-531-29
0298-531-08	0298-531-30
0298-531-09	0298-531-31
0298-531-10	0298-531-32
0298-531-11	0298-531-33
0298-531-12	0298-531-34
0298-531-13	0298-531-35
0298-531-14	0298-531-36
0298-531-15	0298-531-37
0298-531-16	0298-531-38
0298-531-17	0298-531-39
0298-531-18	0298-531-40
0298-531-19	0298-531-41
0298-531-20	0298-531-42
0298-531-21	0298-531-43
0298-531-22	0298-531-44

LEGEND

 Boundaries of Community Facilities District

####-####-## Assessor's Parcel Number

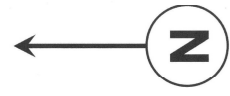

(1) Filed in the office of the Clerk of the Board of Education of the Redlands Unified School District this 13 day of August, 2019

Patty J. Holof

Patty Holof, Clerk of the Board of Education
Redlands Unified School District

(2) I hereby certify that the within map showing the proposed boundaries of Annexation No. 4 to the Community Facilities District No. 2016-1 of the Redlands Unified School District, San Bernardino County, State of California, was approved by the Board of Education of the Redlands Unified School District at the regular meeting thereof, held on this 13 day of August, 2019 by its Resolution No. 37,2019-20.

Patty J. Holof

Patty Holof, Clerk of the Board of Education
Redlands Unified School District

(3) THIS MAP HAS BEEN FILED UNDER DOCUMENT NUMBER 20190288219, THIS 21st DAY OF Aug, 2019, AT 2:59 P. M. IN BOOK 88 OF Assessment Maps AT PAGE(S) 96, AT THE REQUEST OF Redlands Unified School District, IN THE AMOUNT OF \$ 9.00.

BOB DUTTON
ASSESSOR — RECORDER
COUNTY OF SAN BERNARDINO

Recorded in Office of Assessor,
County of San Bernardino,
Book 88, Page 96
Date 2019-08-21 2:59 PM

BY: Bob Dutton
DEPUTY RECORDER

Reference is hereby made to the Assessor maps of the County of San Bernardino for an exact description of the lines and dimensions of each lot and parcel.