

AMENDED BOUNDARIES OF  
POWAY UNIFIED SCHOOL DISTRICT  
COMMUNITY FACILITIES DISTRICT NO. 4  
(Black Mountain Ranch)  
SAN DIEGO COUNTY, STATE OF CALIFORNIA

Pursuant to Street and Highways Code Section 3113.5, this map shows the consolidated boundaries of Poway Unified School District Community Facilities District No. 4 (Black Mountain Ranch), San Diego County, State of California, and supersedes the map prior recorded at Book 31 of Maps of Assessment and Community Facilities Districts at page 45, as Document No. 97-0637883, in the office of the County Recorder for the County of San Diego, State of California.

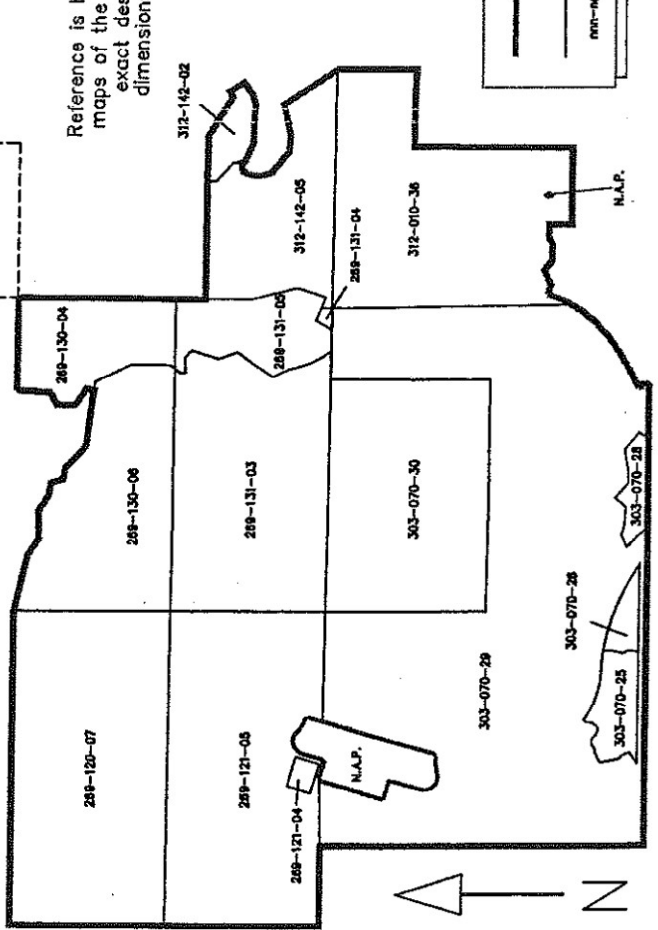

Reference is hereby made to the Assessor maps of the County of San Diego for an exact description of the lines and dimensions of each lot and parcel.

LEGEND

	Amended Boundaries of Community Facilities District No. 4
	Assessor Parcel Boundaries
	Assessor Parcel Number

Confirmed Copy

(1) Filed in the office of the Secretary to the Board of Education this 23<sup>rd</sup> day of November, 2000.  
*Dr. Robert Reeves*  
Dr. Robert Reeves  
Secretary of the Board of Education

(2) I hereby certify that the within map showing the amended boundaries of Community Facilities District No. 4 (Black Mountain Ranch), San Diego County, State of California, was approved by the Board of Education at a regular meeting thereof, held on this 3<sup>rd</sup> day of November, 2000, by its Resolution No. 27-201.  
*Dr. Robert Reeves*  
Dr. Robert Reeves  
Secretary of the Board of Education

(3) Filed this 17<sup>th</sup> day of November, 2000, at the hour of 11:00 o'clock A.M. in Book 31 of Maps of Assessment and Community Facilities Districts at page 73 and as Instrument No. 200-0637883 in the office of the County Recorder of San Diego County, State of California.  
*Charlene J. Feltus*  
County Recorder of San Diego County