

PROPOSED BOUNDARY MAP OF
COMMUNITY FACILITIES DISTRICT NO. 2023-1 OF THE
MORENO VALLEY UNIFIED SCHOOL DISTRICT
RIVERSIDE COUNTY
STATE OF CALIFORNIA

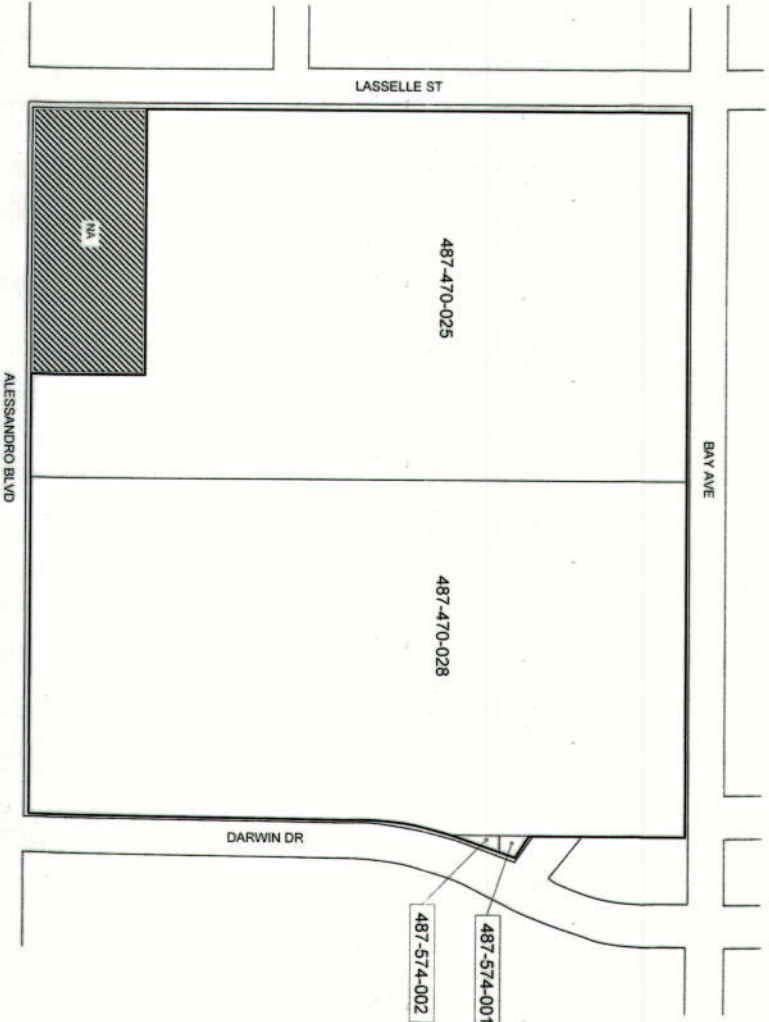

	Boundaries of Community Facilities District
	Boundaries of Current Assessor's Parcel Number
	Excluded Portion (See Page 2)
	Assessor's Parcel Number

LEGEND

(1) Filed in the office of the Clerk of the Board of Education of the Moreno Valley Unified School District this 24 day of January, 2023
Ruth Self-Williams
Clerk of the Board of Education
Moreno Valley Unified School District

(2) I hereby certify that the within map showing the proposed boundaries of Community Facilities District No. 2023-1 of the Moreno Valley Unified School District, Riverside County, State of California, was approved by the Board of Education of the Moreno Valley Unified School District at the regular meeting thereof, held on this 24 day of January, 2023 by its Resolution No. 2023-25-46
Ruth Self-Williams
Clerk of the Board of Education
Moreno Valley Unified School District

(3) Filed this 31st day of January, 2023, at the hour of 1:42 o'clock P.M. in Book 90 of Maps Assessments and Community Facilities Districts at Pages 49-50 and as Instrument No. 2023-00290716 in the offices of the County Recorder of Riverside County, State of California.

Fee: \$ 11

By: *OK*
County Recorder of Riverside County
Assessor-Clerk-Recorder Peter Aldana

Reference is hereby made to the Assessor maps of the County of Riverside for an exact description of the lines and dimensions of each lot and parcel.

Copy

46

PROPOSED BOUNDARY MAP OF
COMMUNITY FACILITIES DISTRICT NO. 2023-1 OF THE
MORENO VALLEY UNIFIED SCHOOL DISTRICT
RIVERSIDE COUNTY
STATE OF CALIFORNIA

**DESCRIPTION OF PORTION OF APN 487-470-025
NOT INCLUDED (EXCLUDED PORTION) WITHIN THE BOUNDARIES
OF COMMUNITY FACILITIES DISTRICT NO 2023-1**

PARCEL A AS SHOWN ON LOT LINE ADJUSTMENT NO. 1077, AS EVIDENCED BY DOCUMENT RECORDED APRIL 25, 2022, AS INSTRUMENT NO. 2022-0194052 OF OFFICIAL RECORDS OF THE COUNTY OF RIVERSIDE, STATE OF CALIFORNIA, BEING MORE PARTICULARLY DESCRIBED AS FOLLOWS:

PARCEL A:

BEING A PORTION OF LOT 5 IN BLOCK 103 OF MAP NO. 1 OF BEAR VALLEY ALESSANDRO DEVELOPMENT COMPANY, AS SHOWN BY MAP RECORDED IN BOOK 11, PAGE 10 OF MAPS, RECORDS OF SAN BERNARDINO COUNTY, CALIFORNIA, DESCRIBED AS FOLLOWS:

BEGINNING AT THE SOUTHWEST CORNER OF LOT 5 IN BLOCK 103 OF SAID MAP, THENCE, ALONG THE SOUTHERLY LINE OF SAID LOT 5, ALSO BEING PARALLEL WITH AND DISTANT 60 FEET NORTHERLY OF THE CENTERLINE OF ALESSANDRO BOULEVARD AS SHOWN ON SAID MAP, SOUTH 89°34'13" EAST 435.49 FEET; THENCE NORTH 0°24'17" EAST 216.92 FEET; THENCE NORTH 89°34'13" WEST 453.49 FEET TO THE WESTERLY LINE OF SAID LOT 5, ALSO BEING PARALLEL WITH AND DISTANT 30 FEET EASTERLY OF THE CENTERLINE OF LASSELLE STREET AS SHOWN ON SAID MAP; THENCE, ALONG SAID MAP; THENCE, ALONG SAID WESTERLY LINE OF SAID LOT 5, SOUTH 0°24'17" WEST 216.92 FEET TO THE POINT OF BEGINNING.