

**BOUNDARY MAP OF
COMMUNITY FACILITIES DISTRICT NO. 14
CHULA VISTA ELEMENTARY SCHOOL DISTRICT
COUNTY OF SAN DIEGO
STATE OF CALIFORNIA**

SHEET 1 OF 1

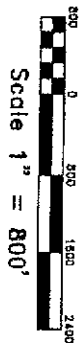
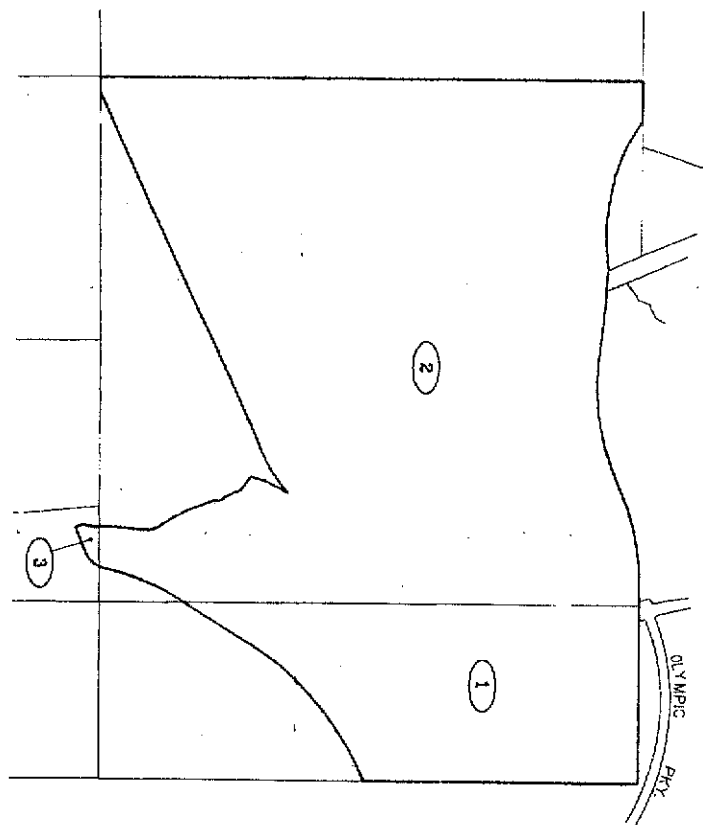

**Special District Planning
& Administration**
333 South Juniper Street, Suite 208
Escondido, California 92029
Tel: (760) 233-2630 Fax: (760) 233-2631

(07-019 OCTOBER 2002)

BK 36 A6 58

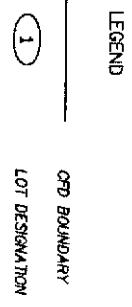

LOT DESIGNATION

LOT NO.	ASSESSOR'S PARCEL NO.
1	643-070-07-00
2	643-070-09-00
3	644-080-14-00

FILED IN THE OFFICE OF THE SECRETARY OF THE BOARD OF EDUCATION OF THE SCHOOL DISTRICT THIS 2nd DAY OF December, 2002.

[Signature]
JOSEPH B. BURNS, ED.D.
SECRETARY OF THE BOARD OF EDUCATION
CHULA VISTA ELEMENTARY SCHOOL DISTRICT
STATE OF CALIFORNIA

I HEREBY CERTIFY THAT THE WITHIN MAP SHOWING BOUNDARIES OF COMMUNITY FACILITIES DISTRICT NO. 14 OF THE CHULA VISTA ELEMENTARY SCHOOL DISTRICT, COUNTY OF SAN DIEGO, STATE OF CALIFORNIA, WAS APPROVED BY THE BOARD OF EDUCATION OF THE SCHOOL DISTRICT AT A MEETING HELD ON THE 10th DAY OF December, 2002, BY ITS RESOLUTION NO. 2002-03-01.

[Signature]
LOWELL BILLINGS, ED.D.
SCHOOL AYS OF THE BOARD OF EDUCATION
CHULA VISTA ELEMENTARY SCHOOL DISTRICT
STATE OF CALIFORNIA

FILED THIS 17th DAY OF DECEMBER, 2002 AT THE HOUR OF 4:53 O'CLOCK P.M. IN BOOK 45 AND PAGE 101-115 OF THE COUNTY RECORDS IN THE COUNTY OF SAN DIEGO, CALIFORNIA.

[Signature]
COUNTY RECORDER
COUNTY OF SAN DIEGO
STATE OF CALIFORNIA

NOTE: FOR PARTICULARS OF LINES AND DIMENSIONS OF ASSESSOR'S PARCELS, REFERENCE IS MADE TO THE SAN DIEGO COUNTY ASSESSOR'S PARCEL MAPS.

**Conformed
Copy**

2002-1154155