

PROPOSED BOUNDARY MAP OF COMMUNITY FACILITIES DISTRICT NO. 2018-1

OF THE BEAUMONT UNIFIED SCHOOL DISTRICT
COUNTY OF RIVERSIDE
STATE OF CALIFORNIA

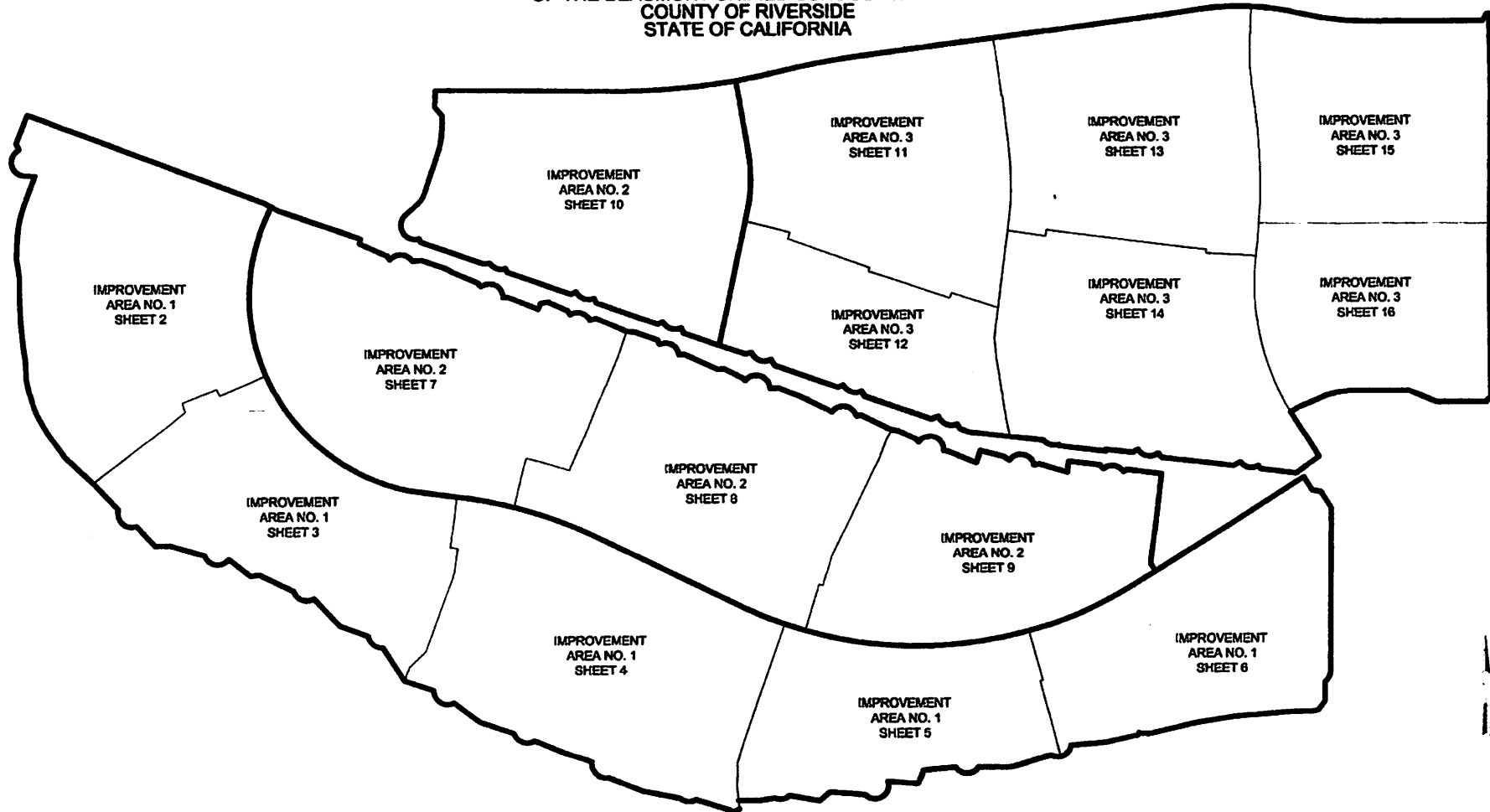

FILED IN THE OFFICE OF THE CLERK OF THE BOARD OF TRUSTEES OF THE BEAUMONT UNIFIED SCHOOL DISTRICT THIS 13th DAY OF July 2018.

I HEREBY CERTIFY THAT THE WITHIN MAP SHOWING THE BOUNDARIES OF COMMUNITY FACILITIES DISTRICT NO. 2018-1, RIVERSIDE COUNTY, STATE OF CALIFORNIA, WAS APPROVED BY THE BOARD OF TRUSTEES OF THE BEAUMONT UNIFIED SCHOOL DISTRICT AT A REGULAR MEETING THEREOF, HELD ON THE 24th DAY OF July, 2018, BY ITS RESOLUTION NO. 2018-19-03.

FILED THIS 2nd DAY OF August 2018, AT THE HOUR OF 1:38 O'CLOCK P.M. IN BOOK 82 OF MAPS OF ASSESSMENT AND COMMUNITY FACILITIES DISTRICTS AT PAGES 74-92, AND AS INSTRUMENT NO. 2018-0311337, IN THE OFFICES OF THE COUNTY RECORDER OF RIVERSIDE COUNTY, STATE OF CALIFORNIA.

FEE: \$ 45.00
Peter Adana

NOTE: FOR PARTICULARS OF LINES AND DIMENSIONS OF ASSESSOR'S PARCELS, REFERENCE IS MADE TO THE RIVERSIDE COUNTY ASSESSOR'S PARCEL MAPS.

S DFA

SPECIAL DISTRICT FINANCING & ADMINISTRATION

437 WEST GRAND AVENUE
ESCONDIDO, CALIFORNIA 92025
TELEPHONE: (760)233-2630
FAX: (760)233-2631

Denise Lara
CLERK OF THE BOARD OF TRUSTEES
BEAUMONT UNIFIED SCHOOL DISTRICT
STATE OF CALIFORNIA

Denise Lara
CLERK OF THE BOARD OF TRUSTEES
BEAUMONT UNIFIED SCHOOL DISTRICT
STATE OF CALIFORNIA

Yusuf
COUNTY RECORDER OF THE COUNTY OF
RIVERSIDE

SHEET	1 OF 19
DATE	JULY 2018
JOB NO.	BUSD2018-1

COPY 12/15

LEGEND:



LOT NUMBER



COMMUNITY FACILITIES DISTRICT BOUNDARY



PROPOSED BOUNDARIES OF
COMMUNITY FACILITIES DISTRICT NO. 2018-1
OF THE BEAUMONT UNIFIED SCHOOL DISTRICT
COUNTY OF RIVERSIDE
STATE OF CALIFORNIA

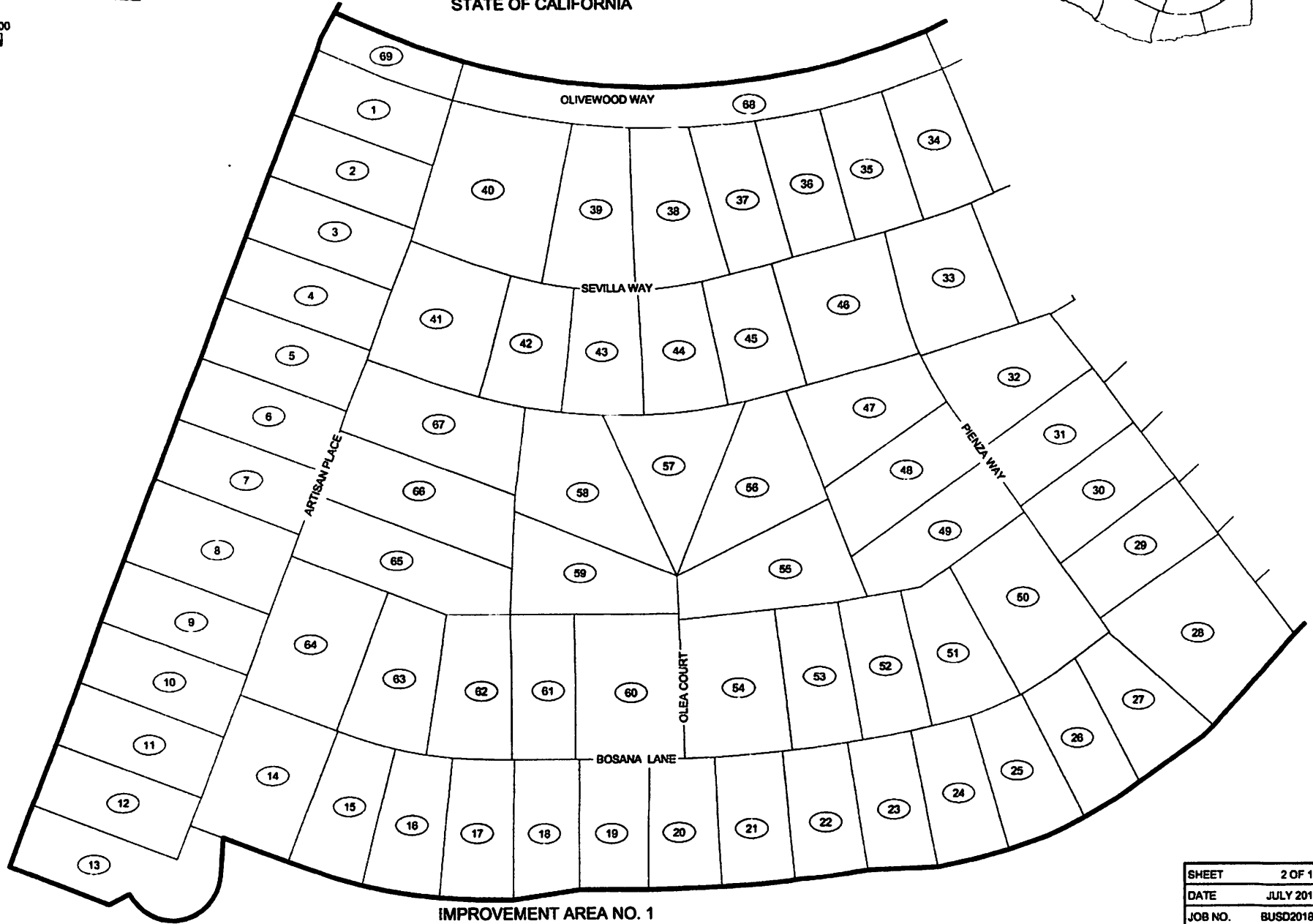
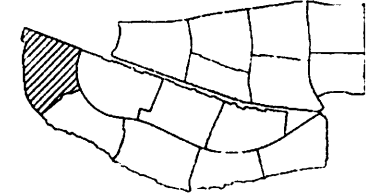

SDFA

SPECIAL DISTRICT FINANCING
& ADMINISTRATION

437 WEST GRAND AVENUE
ESCONDIDO, CALIFORNIA 92025
TELEPHONE: (760)233-2630
FAX: (760)233-2631

IMPROVEMENT AREA NO. 1

SHEET	2 OF 19
DATE	JULY 2018
JOB NO.	BUSD2018-1

0004 82/76

LEGEND:



LOT NUMBER



COMMUNITY FACILITIES DISTRICT BOUNDARY



PROPOSED BOUNDARIES OF
COMMUNITY FACILITIES DISTRICT NO. 2018-1
OF THE BEAUMONT UNIFIED SCHOOL DISTRICT
COUNTY OF RIVERSIDE
STATE OF CALIFORNIA

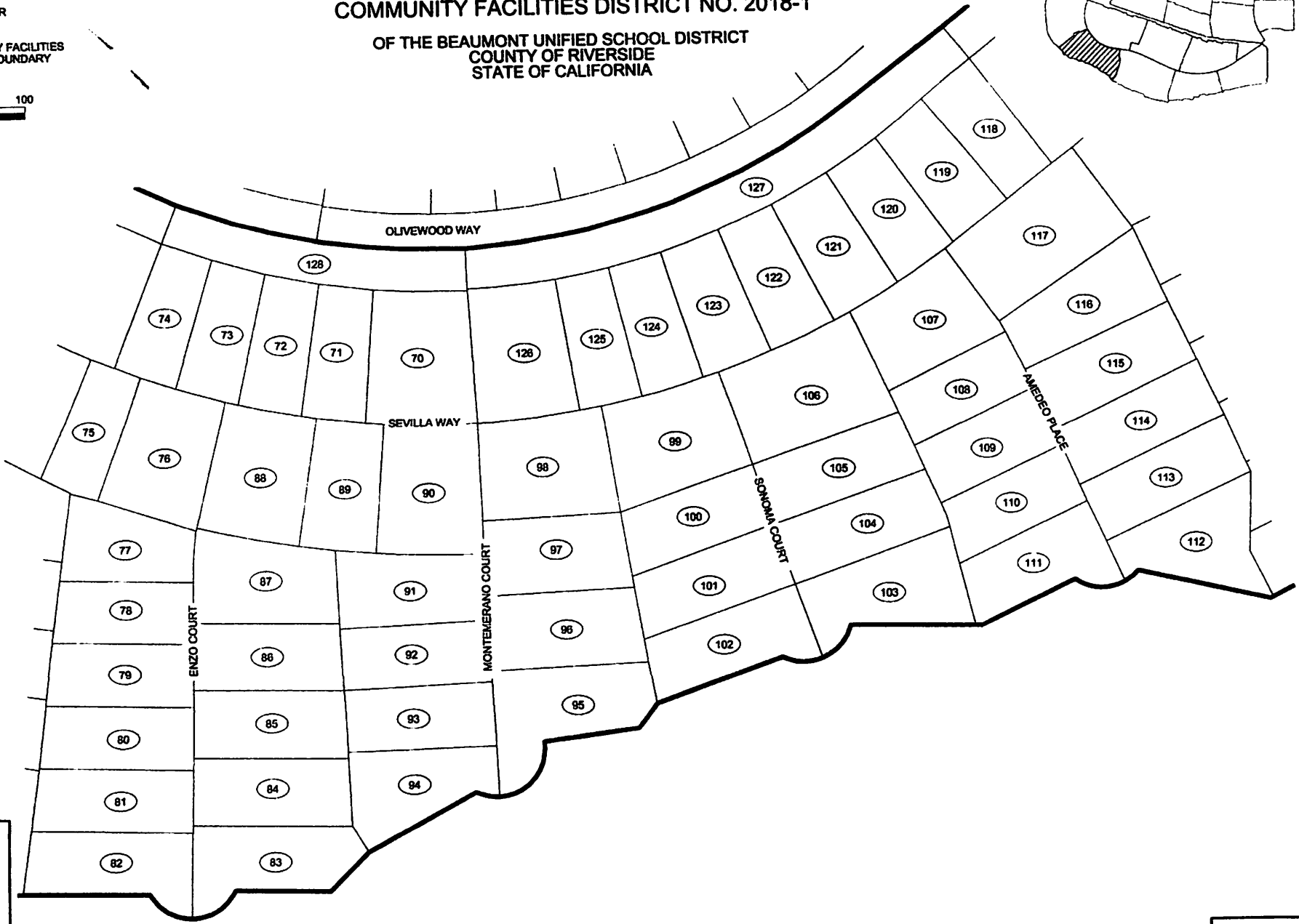
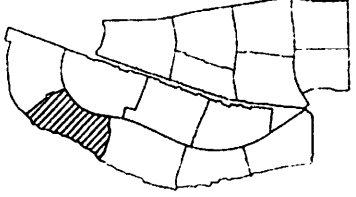

S DFA

SPECIAL DISTRICT FINANCING
& ADMINISTRATION

437 WEST GRAND AVENUE
ESCONDIDO, CALIFORNIA 92025
TELEPHONE: (760)233-2630
FAX: (760)233-2631

IMPROVEMENT AREA NO. 1

SHEET	3 OF 19
DATE	JULY 2018
JOB NO.	BUSD2018-1

LEGEND:



LOT NUMBER



COMMUNITY FACILITIES DISTRICT BOUNDARY



PROPOSED BOUNDARIES OF
COMMUNITY FACILITIES DISTRICT NO. 2018-1
OF THE BEAUMONT UNIFIED SCHOOL DISTRICT
COUNTY OF RIVERSIDE
STATE OF CALIFORNIA

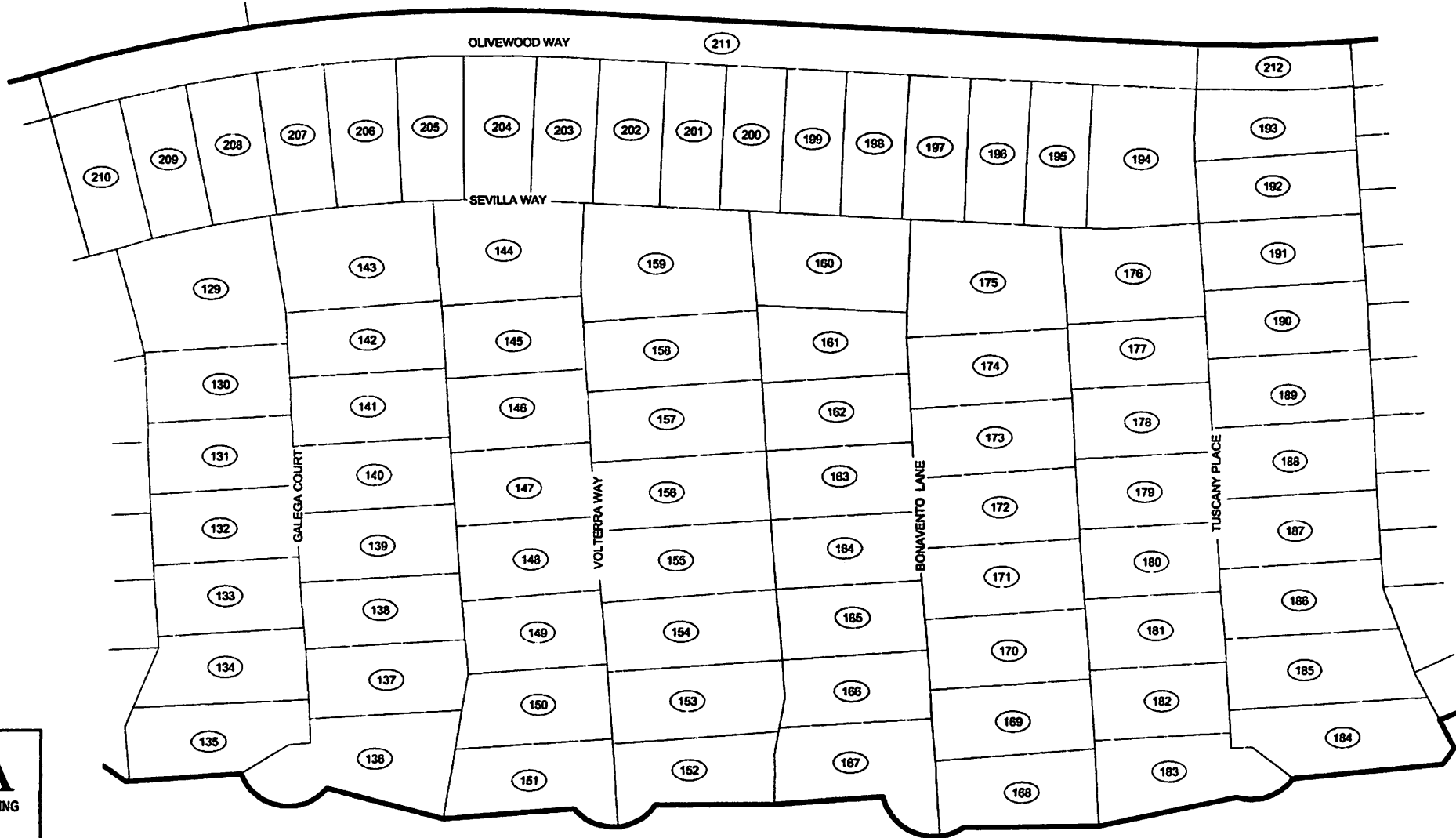
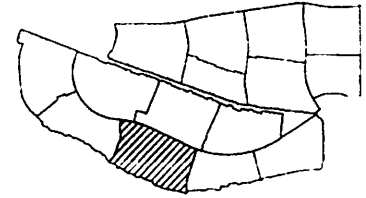

SDFA

SPECIAL DISTRICT FINANCING
& ADMINISTRATION

437 WEST GRAND AVENUE
ESCONDIDO, CALIFORNIA 92025
TELEPHONE: (760)233-2630
FAX: (760)233-2631

IMPROVEMENT AREA NO. 1

SHEET	4 OF 19
DATE	JULY 2018
JOB NO.	BUSD2018-1

COB 8/18

LEGEND:

(1) LOT NUMBER

———— COMMUNITY FACILITIES DISTRICT BOUNDARY

Scale In Feet

**PROPOSED BOUNDARIES OF
COMMUNITY FACILITIES DISTRICT NO. 2018-1**
OF THE BEAUMONT UNIFIED SCHOOL DISTRICT
COUNTY OF RIVERSIDE
STATE OF CALIFORNIA

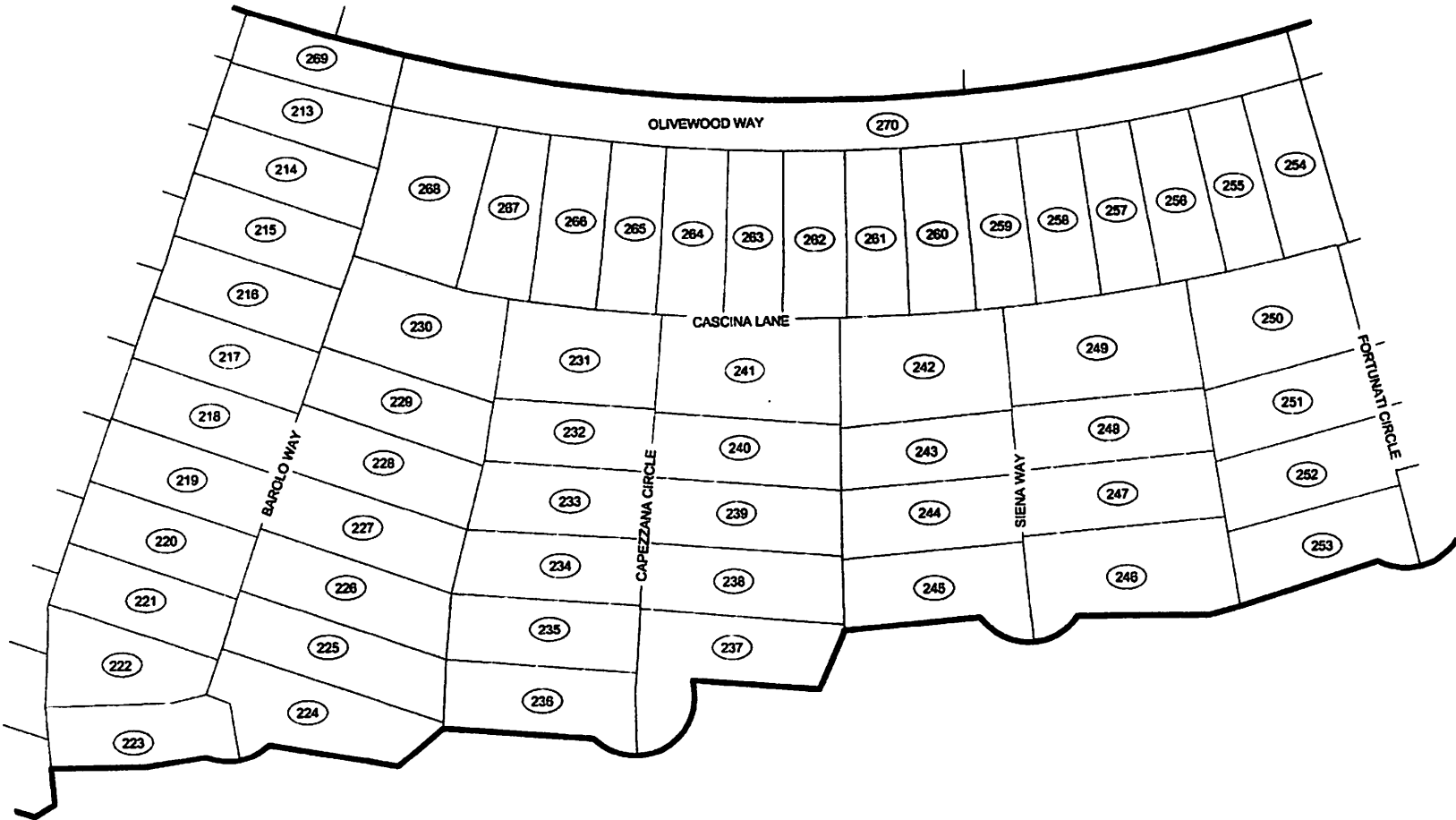
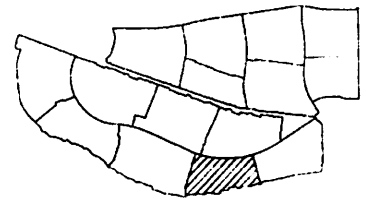

SDFA
SPECIAL DISTRICT FINANCING
& ADMINISTRATION

437 WEST GRAND AVENUE
ESCONDIDO, CALIFORNIA 92025
TELEPHONE: (760)233-2630
FAX: (760)233-2631

IMPROVEMENT AREA NO. 1

SHEET	5 OF 19
DATE	JULY 2018
JOB NO.	BUSD2018-1

copy 8/19

LEGEND:

1

LOT NUMBER

COMMUNITY FACILITIES DISTRICT BOUNDARY



PROPOSED BOUNDARIES OF
COMMUNITY FACILITIES DISTRICT NO. 2018-1
OF THE BEAUMONT UNIFIED SCHOOL DISTRICT
COUNTY OF RIVERSIDE
STATE OF CALIFORNIA

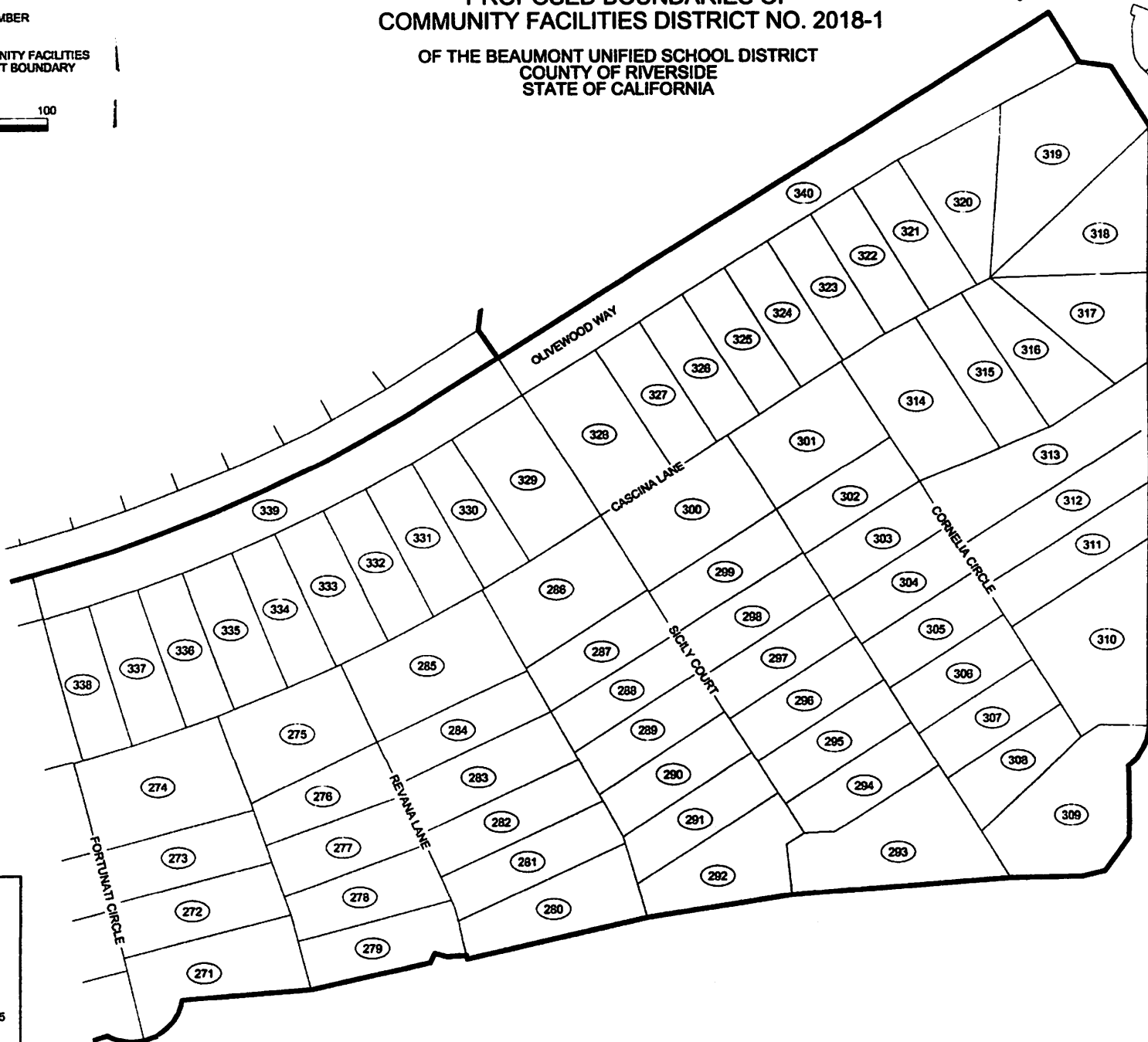
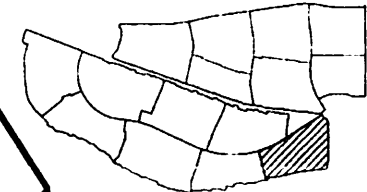

S DFA
SPECIAL DISTRICT FINANCING
& ADMINISTRATION

437 WEST GRAND AVENUE
ESCONDIDO, CALIFORNIA 92025
TELEPHONE: (760)233-2630
FAX: (760)233-2631

IMPROVEMENT AREA NO. 1

SHEET	6 OF 19
DATE	JULY 2018
JOB NO.	BUSD2018-1

004
82/80

PROPOSED BOUNDARIES OF COMMUNITY FACILITIES DISTRICT NO. 2018-1 OF THE BEAUMONT UNIFIED SCHOOL DISTRICT COUNTY OF RIVERSIDE STATE OF CALIFORNIA

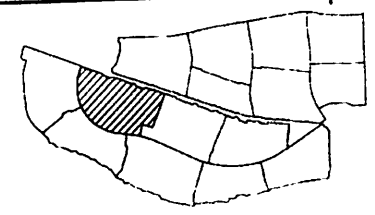

LEGEND:



LOT NUMBER

COMMUNITY FACILITIES
DISTRICT BOUNDARY

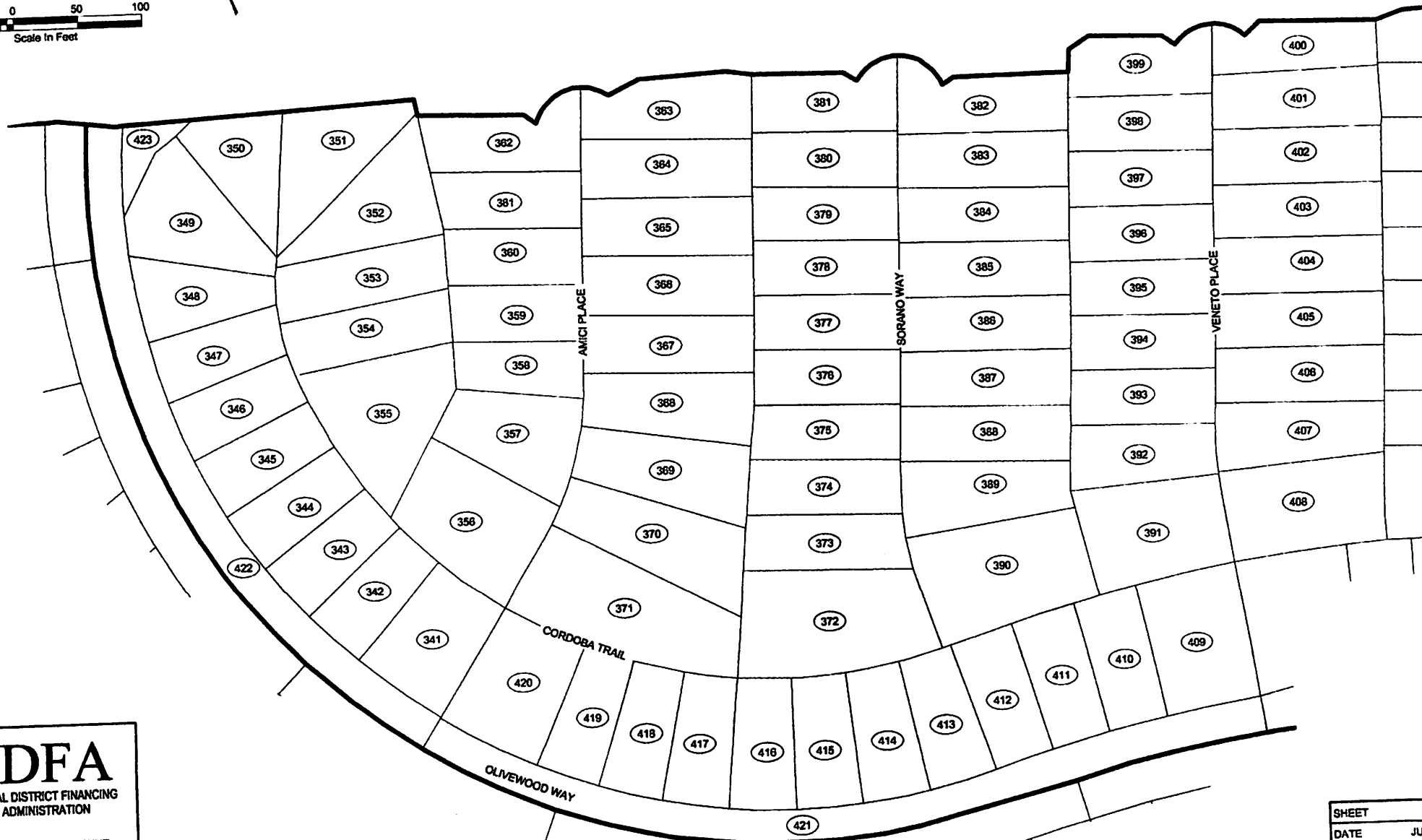

SDFA

SPECIAL DISTRICT FINANCING
& ADMINISTRATION

437 WEST GRAND AVENUE
ESCONDIDO, CALIFORNIA 92025
TELEPHONE: (760)233-2630
FAX: (760)233-2631

IMPROVEMENT AREA NO. 2

SHEET	7 OF 19
DATE	JULY 2018
JOB NO.	BUSD2018-1

LEGEND:

1

LOT NUMBER

COMMUNITY FACILITIES DISTRICT BOUNDARY



PROPOSED BOUNDARIES OF COMMUNITY FACILITIES DISTRICT NO. 2018-1 OF THE BEAUMONT UNIFIED SCHOOL DISTRICT COUNTY OF RIVERSIDE STATE OF CALIFORNIA

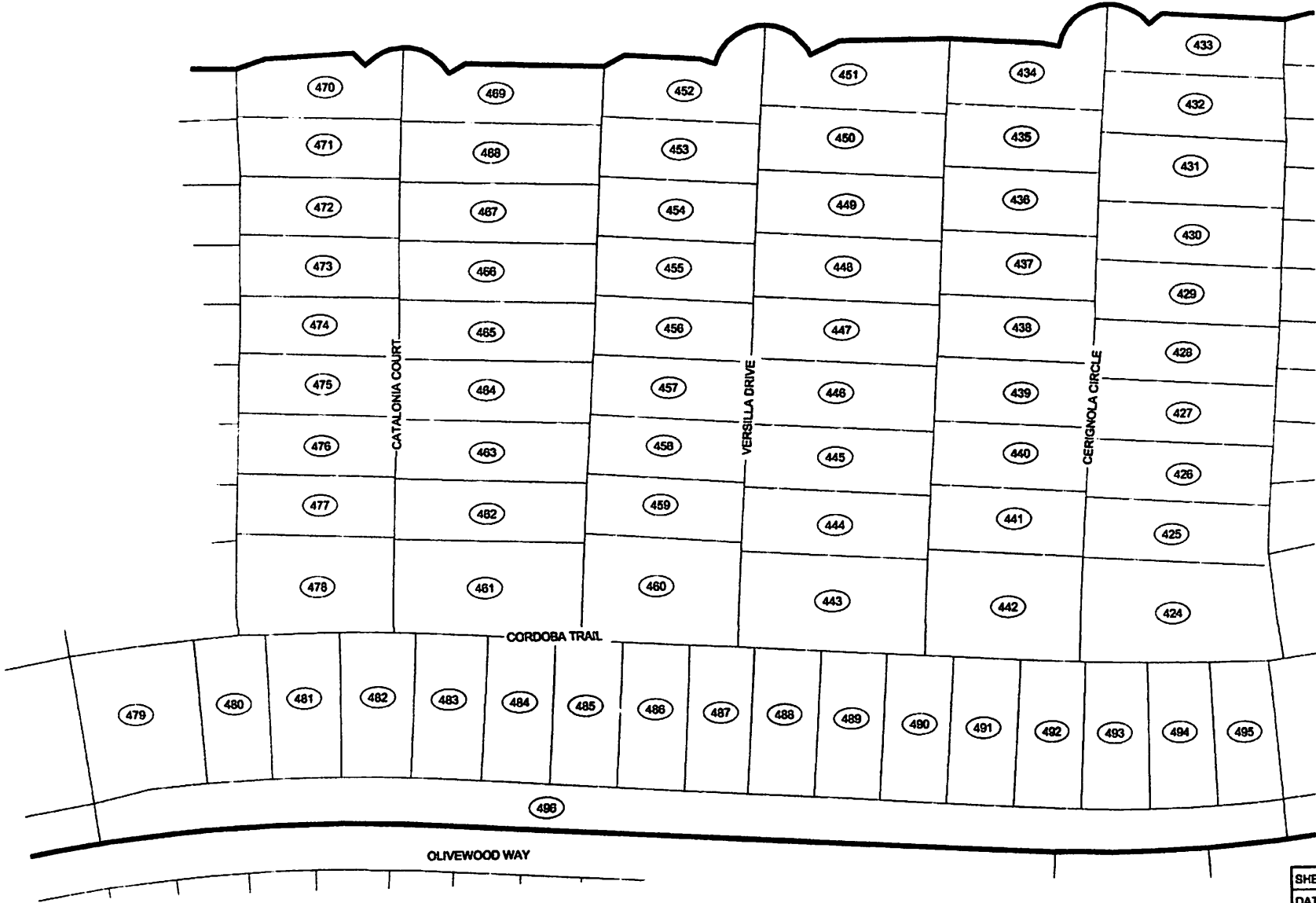
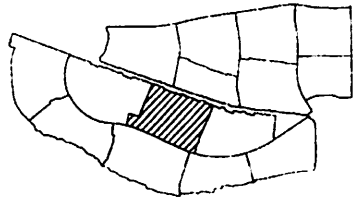

SDFA SPECIAL DISTRICT FINANCING & ADMINISTRATION 437 WEST GRAND AVENUE ESCONDIDO, CALIFORNIA 92025 TELEPHONE: (760)233-2630 FAX: (760)233-2631

IMPROVEMENT AREA NO. 2

Table with 2 columns: SHEET, DATE, JOB NO. and 2 rows: 8 OF 19, JULY 2018, BUSD2018-1

COPY 82/82

LEGEND:

1 LOT NUMBER

COMMUNITY FACILITIES DISTRICT BOUNDARY



PROPOSED BOUNDARIES OF
COMMUNITY FACILITIES DISTRICT NO. 2018-1
OF THE BEAUMONT UNIFIED SCHOOL DISTRICT
COUNTY OF RIVERSIDE
STATE OF CALIFORNIA

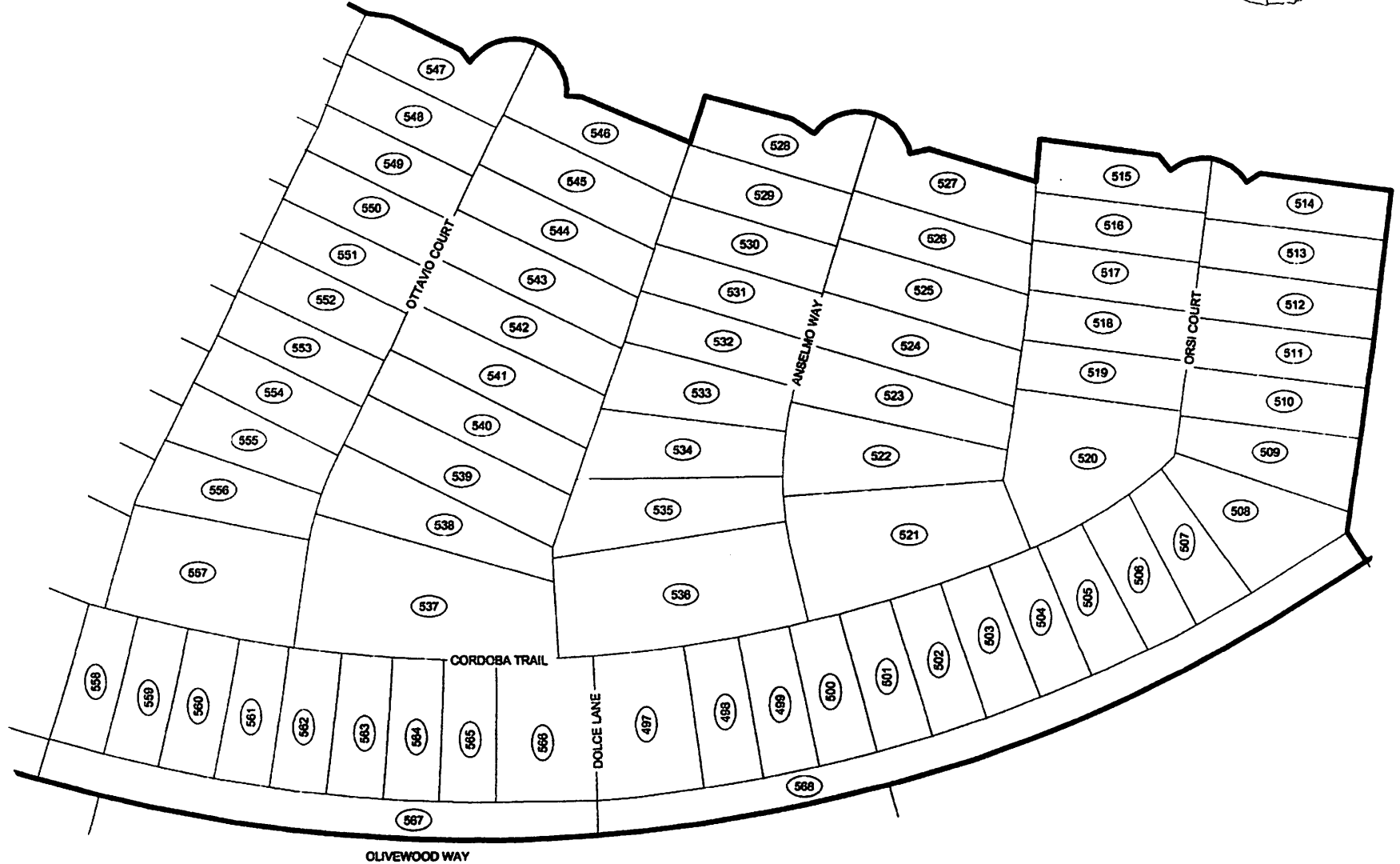
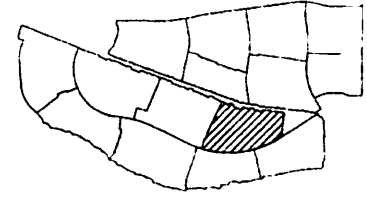

SDFA
SPECIAL DISTRICT FINANCING
& ADMINISTRATION

437 WEST GRAND AVENUE
ESCONDIDO, CALIFORNIA 92025
TELEPHONE: (760)233-2630
FAX: (760)233-2631

IMPROVEMENT AREA NO. 2

SHEET	9 OF 19
DATE	JULY 2018
JOB NO.	BJSD2018-1

COPY 82/83

LEGEND:

1

LOT NUMBER

COMMUNITY FACILITIES DISTRICT BOUNDARY



Scale in Feet

PROPOSED BOUNDARIES OF
COMMUNITY FACILITIES DISTRICT NO. 2018-1
OF THE BEAUMONT UNIFIED SCHOOL DISTRICT
COUNTY OF RIVERSIDE
STATE OF CALIFORNIA

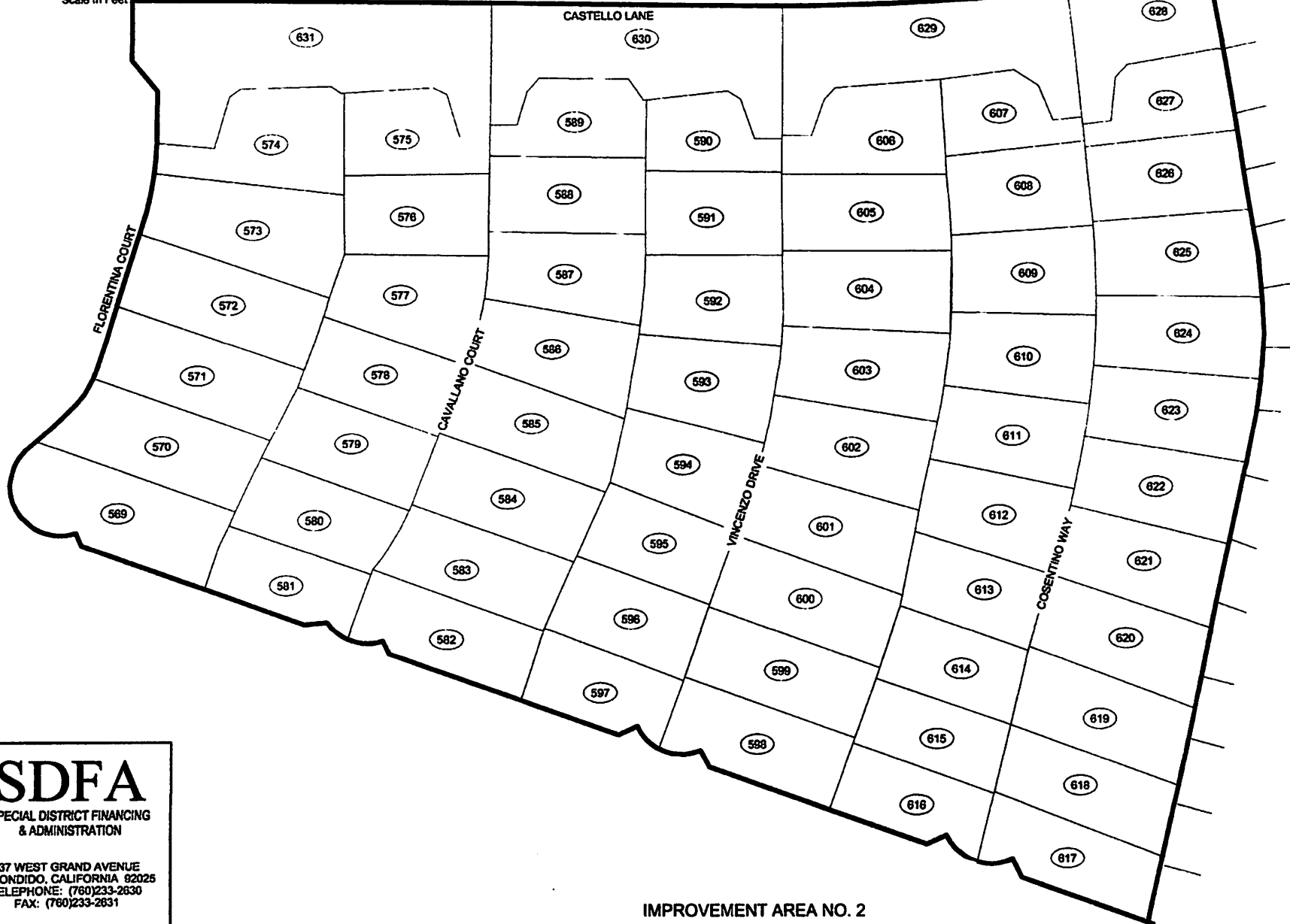
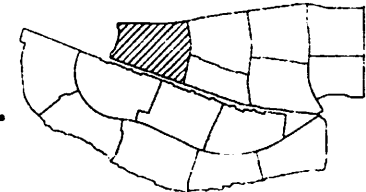

S DFA

SPECIAL DISTRICT FINANCING
& ADMINISTRATION

437 WEST GRAND AVENUE
ESCONDIDO, CALIFORNIA 92025
TELEPHONE: (760)233-2830
FAX: (760)233-2831

IMPROVEMENT AREA NO. 2

SHEET	10 OF 19
DATE	JULY 2018
JOB NO.	BUSD2018-1

copy 82/84

LEGEND:

1

LOT NUMBER

COMMUNITY FACILITIES DISTRICT BOUNDARY



PROPOSED BOUNDARIES OF
COMMUNITY FACILITIES DISTRICT NO. 2018-1
OF THE BEAUMONT UNIFIED SCHOOL DISTRICT
COUNTY OF RIVERSIDE
STATE OF CALIFORNIA

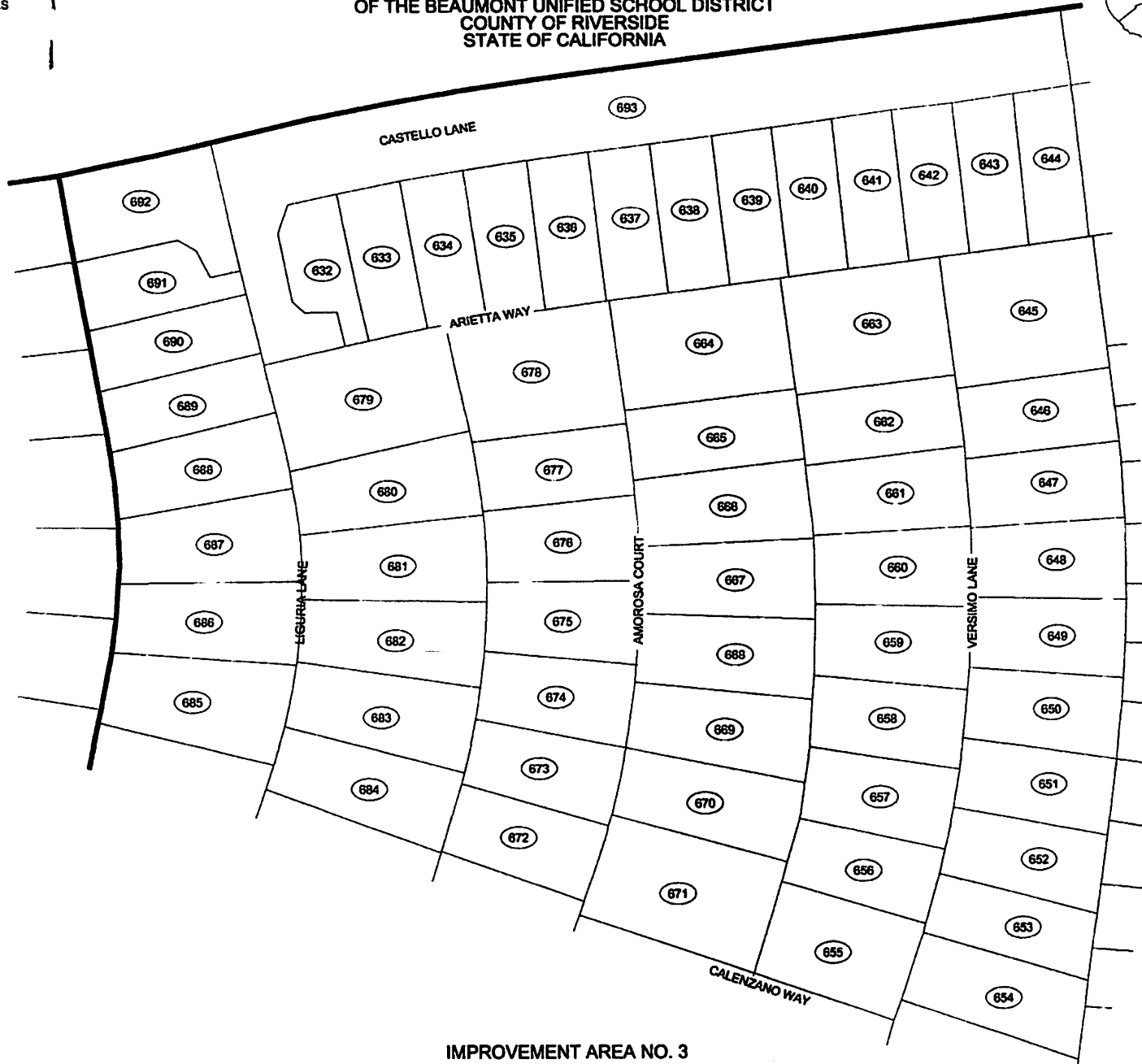
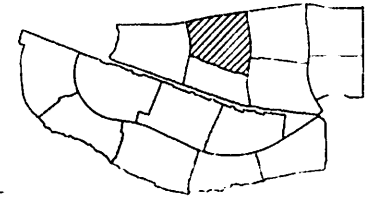

SDFA

SPECIAL DISTRICT FINANCING
& ADMINISTRATION

437 WEST GRAND AVENUE
ESCONDIDO, CALIFORNIA 92025
TELEPHONE: (760)233-2630
FAX: (760)233-2631

IMPROVEMENT AREA NO. 3

SHEET	11 OF 19
DATE	JULY 2018
JOB NO.	BUSD2018-1

CDP 8/25

LEGEND:

1

LOT NUMBER

COMMUNITY FACILITIES DISTRICT BOUNDARY



PROPOSED BOUNDARIES OF
COMMUNITY FACILITIES DISTRICT NO. 2018-1
OF THE BEAUMONT UNIFIED SCHOOL DISTRICT
COUNTY OF RIVERSIDE
STATE OF CALIFORNIA

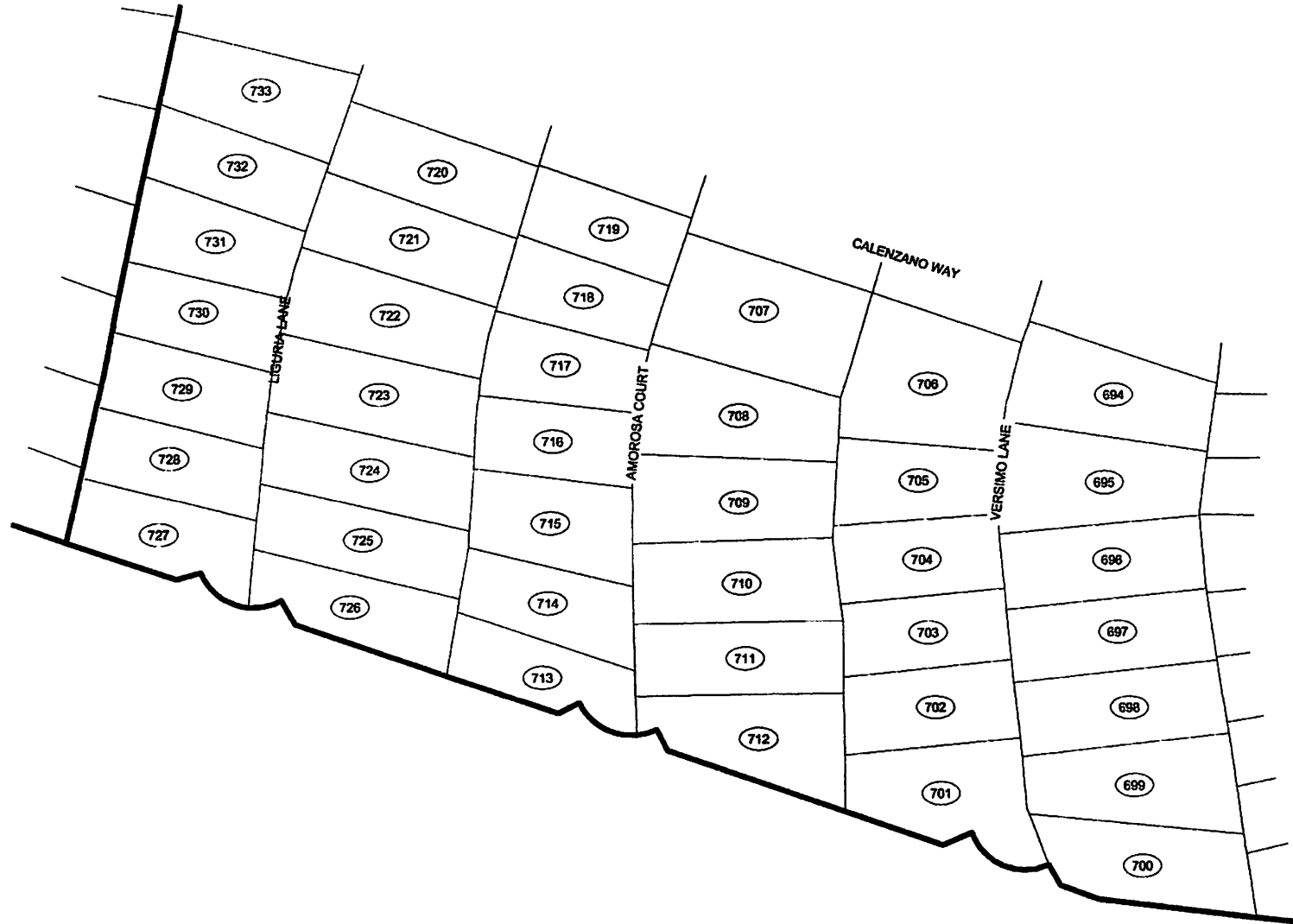
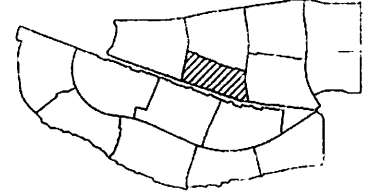

SDFA

SPECIAL DISTRICT FINANCING
& ADMINISTRATION

437 WEST GRAND AVENUE
ESCONDIDO, CALIFORNIA 92025
TELEPHONE: (760)233-2630
FAX: (760)233-2631

IMPROVEMENT AREA NO. 3

SHEET	12 OF 19
DATE	JULY 2018
JOB NO.	BUSD2018-1

COPY 8/2/86

LEGEND:

1

LOT NUMBER

COMMUNITY FACILITIES DISTRICT BOUNDARY



PROPOSED BOUNDARIES OF COMMUNITY FACILITIES DISTRICT NO. 2018-1 OF THE BEAUMONT UNIFIED SCHOOL DISTRICT COUNTY OF RIVERSIDE STATE OF CALIFORNIA

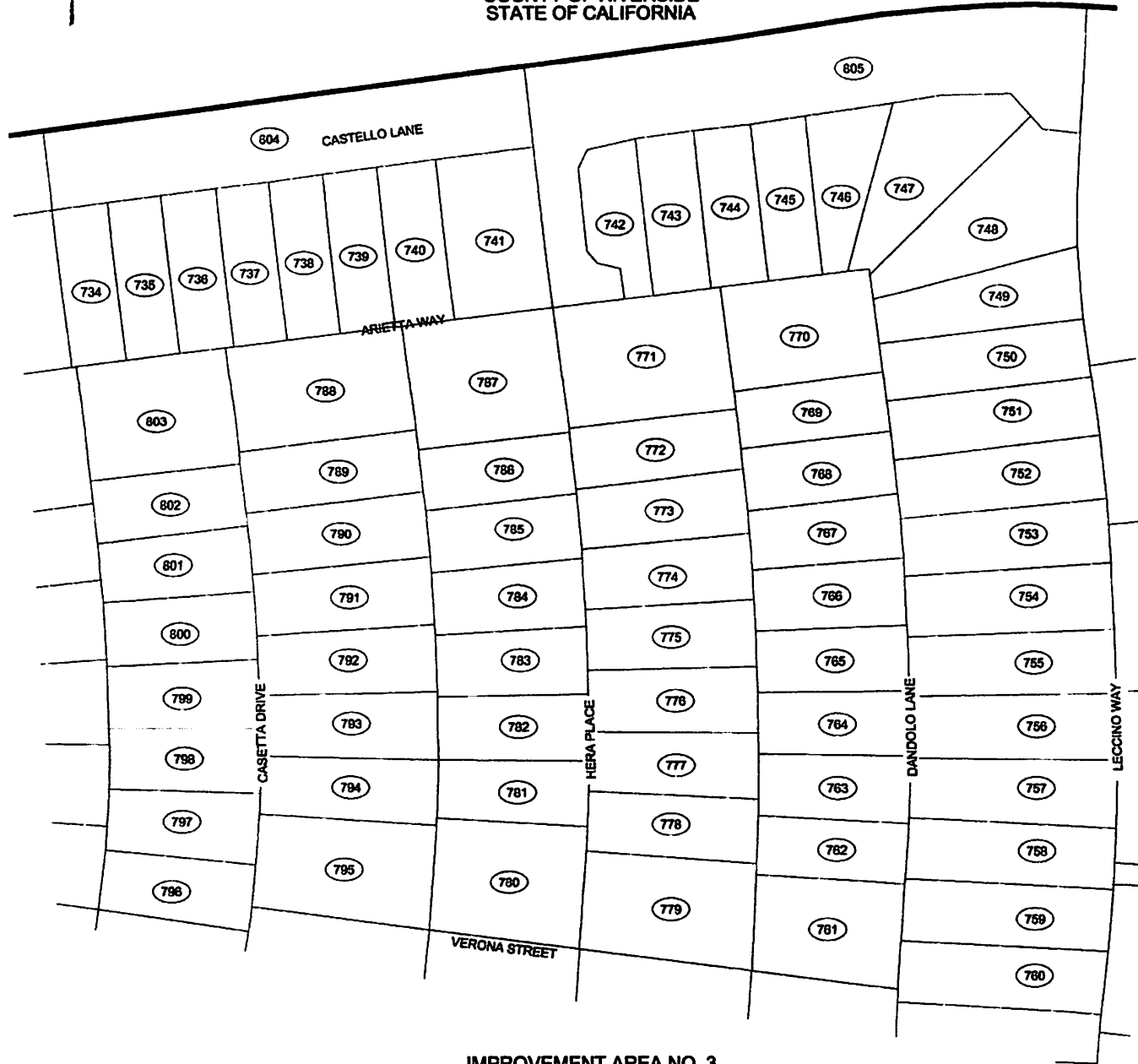
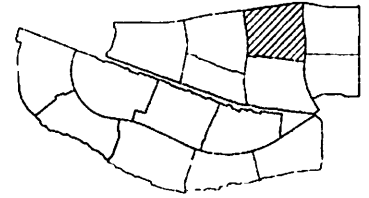

SDFA SPECIAL DISTRICT FINANCING & ADMINISTRATION 437 WEST GRAND AVENUE ESCONDIDO, CALIFORNIA 92025 TELEPHONE: (760)233-2630 FAX: (760)233-2631

IMPROVEMENT AREA NO. 3

Table with 2 columns: SHEET, DATE, JOB NO. and 2 rows: 13 OF 19, JULY 2018, BUSD2018-1

PROPOSED BOUNDARIES OF COMMUNITY FACILITIES DISTRICT NO. 2018-1 OF THE BEAUMONT UNIFIED SCHOOL DISTRICT COUNTY OF RIVERSIDE STATE OF CALIFORNIA

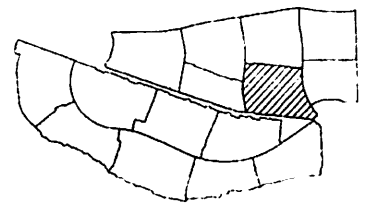

LEGEND:

① LOT NUMBER

--- COMMUNITY FACILITIES DISTRICT BOUNDARY

50 0 50 100
Scale in Feet

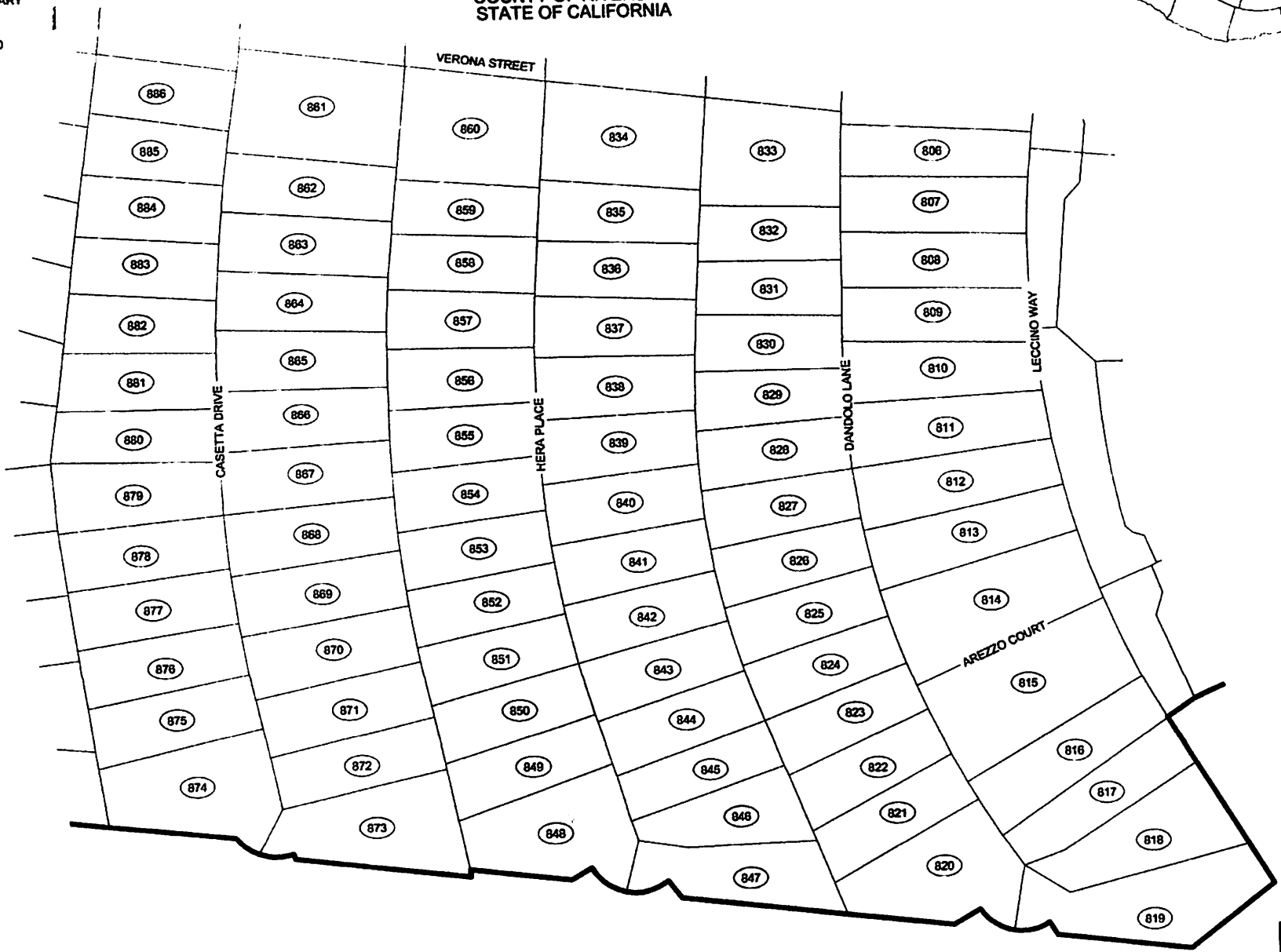

S DFA
SPECIAL DISTRICT FINANCING
& ADMINISTRATION

437 WEST GRAND AVENUE
ESCONDIDO, CALIFORNIA 92025
TELEPHONE: (760)233-2630
FAX: (760)233-2631

IMPROVEMENT AREA NO. 3

SHEET	14 OF 19
DATE	JULY 2018
JOB NO.	BUSD2018-1

COPY

LEGEND:

1 LOT NUMBER

COMMUNITY FACILITIES DISTRICT BOUNDARY



PROPOSED BOUNDARIES OF COMMUNITY FACILITIES DISTRICT NO. 2018-1 OF THE BEAUMONT UNIFIED SCHOOL DISTRICT COUNTY OF RIVERSIDE STATE OF CALIFORNIA

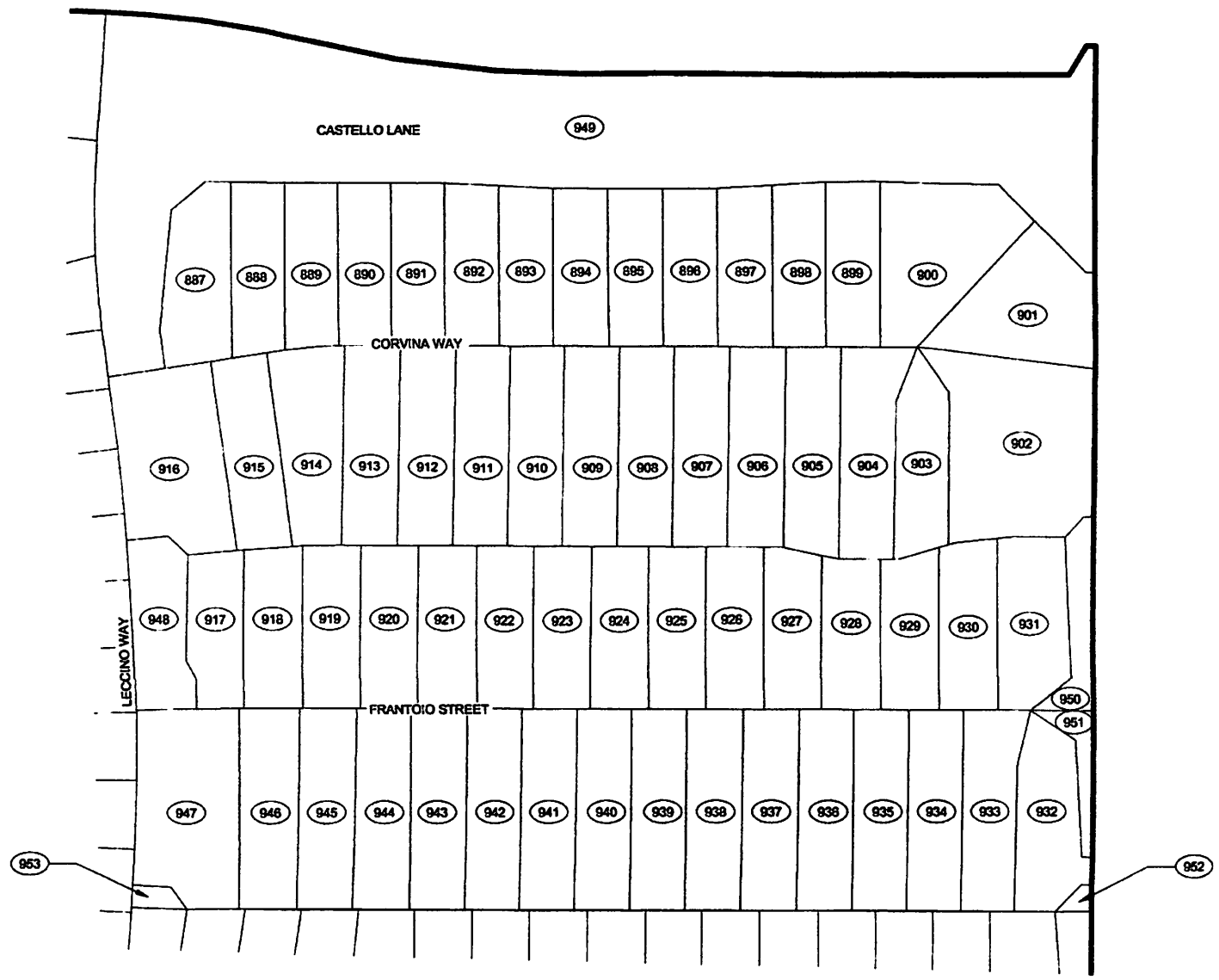
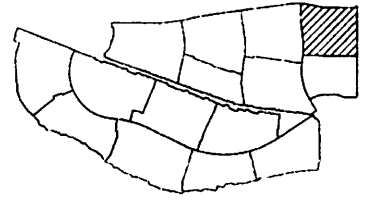

S DFA
SPECIAL DISTRICT FINANCING & ADMINISTRATION

437 WEST GRAND AVENUE
ESCONDIDO, CALIFORNIA 92025
TELEPHONE: (760)233-2830
FAX: (760)233-2831

IMPROVEMENT AREA NO. 3

SHEET	15 OF 19
DATE	JULY 2018
JOB NO.	BUSD2018-1

COPY 8/28

LEGEND:



LOT NUMBER



COMMUNITY FACILITIES DISTRICT BOUNDARY



PROPOSED BOUNDARIES OF
COMMUNITY FACILITIES DISTRICT NO. 2018-1
OF THE BEAUMONT UNIFIED SCHOOL DISTRICT
COUNTY OF RIVERSIDE
STATE OF CALIFORNIA

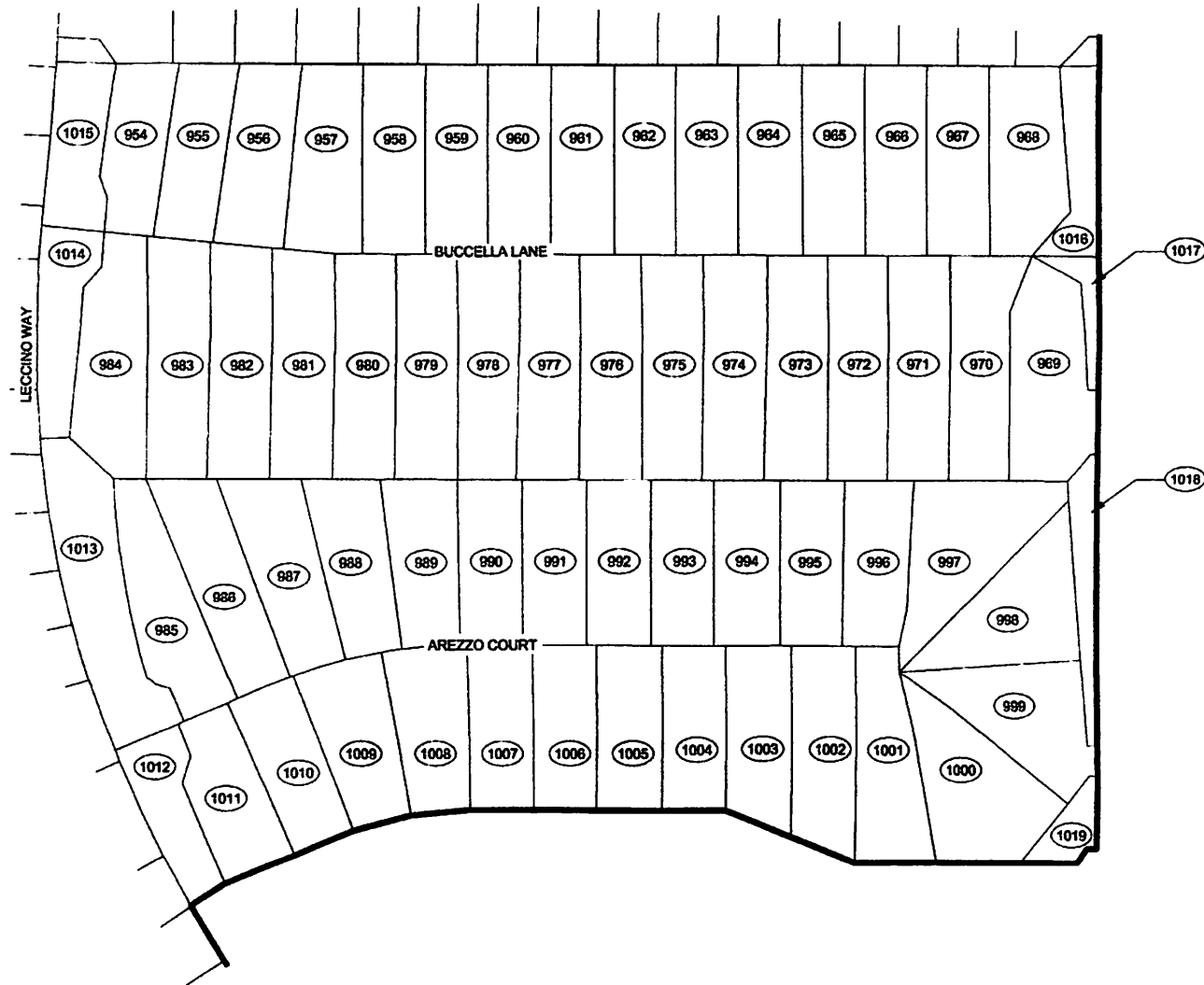
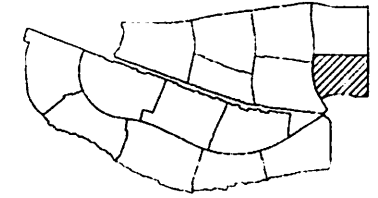

S DFA

SPECIAL DISTRICT FINANCING
& ADMINISTRATION

437 WEST GRAND AVENUE
ESCONDIDO, CALIFORNIA 92025
TELEPHONE: (760)233-2630
FAX: (760)233-2631

IMPROVEMENT AREA NO. 3

SHEET	16 OF 19
DATE	JULY 2018
JOB NO.	BUSD2018-1

PROPOSED BOUNDARY MAP OF COMMUNITY FACILITIES DISTRICT NO. 2018-1
OF THE BEAUMONT UNIFIED SCHOOL DISTRICT
COUNTY OF RIVERSIDE
STATE OF CALIFORNIA

LOT NO.	APN	IMPROV. AREA
1	414-380-001	1
2	414-380-002	1
3	414-380-003	1
4	414-380-004	1
5	414-380-005	1
6	414-380-006	1
7	414-380-007	1
8	414-380-008	1
9	414-380-009	1
10	414-380-010	1
11	414-380-011	1
12	414-380-012	1
13	414-380-013	1
14	414-380-014	1
15	414-380-015	1
16	414-380-016	1
17	414-380-017	1
18	414-380-018	1
19	414-380-019	1
20	414-380-020	1
21	414-380-021	1
22	414-380-022	1
23	414-380-023	1
24	414-380-024	1
25	414-380-025	1
26	414-380-026	1
27	414-380-027	1
28	414-380-028	1
29	414-380-029	1
30	414-380-030	1
31	414-380-031	1
32	414-380-032	1
33	414-380-033	1
34	414-380-034	1
35	414-380-035	1
36	414-380-036	1
37	414-380-037	1
38	414-380-038	1
39	414-380-039	1
40	414-380-040	1
41	414-380-041	1
42	414-380-042	1
43	414-380-043	1
44	414-380-044	1
45	414-380-045	1

LOT NO.	APN	IMPROV. AREA
46	414-380-046	1
47	414-380-047	1
48	414-380-048	1
49	414-380-049	1
50	414-380-050	1
51	414-380-051	1
52	414-380-052	1
53	414-380-053	1
54	414-380-054	1
55	414-380-055	1
56	414-380-056	1
57	414-380-057	1
58	414-380-058	1
59	414-380-059	1
60	414-380-060	1
61	414-380-061	1
62	414-380-062	1
63	414-380-063	1
64	414-380-064	1
65	414-380-065	1
66	414-380-066	1
67	414-380-067	1
68	414-380-068	1
69	414-380-069	1
70	414-380-070	1
71	414-380-071	1
72	414-380-072	1
73	414-380-073	1
74	414-380-074	1
75	414-380-075	1
76	414-380-076	1
77	414-380-077	1
78	414-380-078	1
79	414-380-079	1
80	414-380-080	1
81	414-380-081	1
82	414-380-082	1
83	414-380-083	1
84	414-380-084	1
85	414-380-085	1
86	414-380-086	1
87	414-380-087	1
88	414-380-088	1
89	414-380-089	1
90	414-380-090	1
91	414-380-091	1
92	414-380-092	1
93	414-380-093	1
94	414-380-094	1
95	414-380-095	1
96	414-380-096	1
97	414-380-097	1
98	414-380-098	1
99	414-380-099	1
100	414-380-100	1

LOT NO.	APN	IMPROV. AREA
101	414-390-032	1
102	414-390-033	1
103	414-390-034	1
104	414-390-035	1
105	414-390-036	1
106	414-390-037	1
107	414-390-038	1
108	414-390-039	1
109	414-390-040	1
110	414-390-041	1
111	414-390-042	1
112	414-390-043	1
113	414-390-044	1
114	414-390-045	1
115	414-390-046	1
116	414-390-047	1
117	414-390-048	1
118	414-390-049	1
119	414-390-050	1
120	414-390-051	1
121	414-390-052	1
122	414-390-053	1
123	414-390-054	1
124	414-390-055	1
125	414-390-056	1
126	414-390-057	1
127	414-390-058	1
128	414-390-059	1
129	414-400-001	1
130	414-400-002	1
131	414-400-003	1
132	414-400-004	1
133	414-400-005	1
134	414-400-006	1
135	414-400-007	1
136	414-400-008	1
137	414-400-009	1
138	414-400-010	1
139	414-400-011	1
140	414-400-012	1
141	414-400-013	1
142	414-400-014	1
143	414-400-015	1
144	414-400-016	1
145	414-400-017	1
146	414-400-018	1
147	414-400-019	1
148	414-400-020	1
149	414-400-021	1
150	414-400-022	1
151	414-400-023	1
152	414-400-024	1
153	414-400-025	1
154	414-400-026	1
155	414-400-027	1

LOT NO.	APN	IMPROV. AREA
156	414-400-028	1
157	414-400-029	1
158	414-400-030	1
159	414-400-031	1
160	414-400-032	1
161	414-400-033	1
162	414-400-034	1
163	414-400-035	1
164	414-400-036	1
165	414-400-037	1
166	414-400-038	1
167	414-400-039	1
168	414-400-040	1
169	414-400-041	1
170	414-400-042	1
171	414-400-043	1
172	414-400-044	1
173	414-400-045	1
174	414-400-046	1
175	414-400-047	1
176	414-400-048	1
177	414-400-049	1
178	414-400-050	1
179	414-400-051	1
180	414-400-052	1
181	414-400-053	1
182	414-400-054	1
183	414-400-055	1
184	414-400-056	1
185	414-400-057	1
186	414-400-058	1
187	414-400-059	1
188	414-400-060	1
189	414-400-061	1
190	414-400-062	1
191	414-400-063	1
192	414-400-064	1
193	414-400-065	1
194	414-400-066	1
195	414-400-067	1
196	414-400-068	1
197	414-400-069	1
198	414-400-070	1
199	414-400-071	1
200	414-400-072	1
201	414-400-073	1
202	414-400-074	1
203	414-400-075	1
204	414-400-076	1
205	414-400-077	1
206	414-400-078	1
207	414-400-079	1
208	414-400-080	1
209	414-400-081	1
210	414-400-082	1

LOT NO.	APN	IMPROV. AREA
211	414-400-083	1
212	414-400-084	1
213	414-510-001	1
214	414-510-002	1
215	414-510-003	1
216	414-510-004	1
217	414-510-005	1
218	414-510-006	1
219	414-510-007	1
220	414-510-008	1
221	414-510-009	1
222	414-510-010	1
223	414-510-011	1
224	414-510-012	1
225	414-510-013	1
226	414-510-014	1
227	414-510-015	1
228	414-510-016	1
229	414-510-017	1
230	414-510-018	1
231	414-510-019	1
232	414-510-020	1
233	414-510-021	1
234	414-510-022	1
235	414-510-023	1
236	414-510-024	1
237	414-510-025	1
238	414-510-026	1
239	414-510-027	1
240	414-510-028	1
241	414-510-029	1
242	414-510-030	1
243	414-510-031	1
244	414-510-032	1
245	414-510-033	1
246	414-510-034	1
247	414-510-035	1
248	414-510-036	1
249	414-510-037	1
250	414-510-038	1
251	414-510-039	1
252	414-510-040	1
253	414-510-041	1
254	414-510-042	1
255	414-510-043	1
256	414-510-044	1
257	414-510-045	1
258	414-510-046	1
259	414-510-047	1
260	414-510-048	1
261	414-510-049	1
262	414-510-050	1
263	414-510-051	1
264	414-510-052	1
265	414-510-053	1

LOT NO.	APN	IMPROV. AREA
266	414-510-054	1
267	414-510-055	1
268	414-510-056	1
269	414-510-057	1
270	414-510-058	1
271	414-520-001	1
272	414-520-002	1
273	414-520-003	1
274	414-520-004	1
275	414-520-005	1
276	414-520-006	1
277	414-520-007	1
278	414-520-008	1
279	414-520-009	1
280	414-520-010	1
281	414-520-011	1
282	414-520-012	1
283	414-520-013	1
284	414-520-014	1
285	414-520-015	1
286	414-520-016	1
287	414-520-017	1
288	414-520-018	1
289	414-520-019	1
290	414-520-020	1
291	414-520-021	1
292	414-520-022	1
293	414-520-023	1
294	414-520-024	1
295	414-520-025	1
296	414-520-026	1
297	414-520-027	1
298	414-520-028	1
299	414-520-029	1
300	414-520-030	1
301	414-520-031	1
302	414-520-032	1
303	414-520-033	1
304	414-520-034	1
305	414-520-035	1
306	414-520-036	1
307	414-520-037	1
308	414-520-038	1
309	414-520-039	1
310	414-520-040	1
311	414-520-041	1
312	414-520-042	1
313	414-520-043	1
314	414-520-044	1
315	414-520-045	1
316	414-520-046	1
317	414-520-047	1
318	414-520-048	1
319	414-520-049	1
320	414-520-050	1

LOT NO.	APN	IMPROV. AREA
321	414-520-051	1
322	414-520-052	1
323	414-520-053	1
324	414-520-054	1
325	414-520-055	1
326	414-520-056	1
327	414-520-057	1
328	414-520-058	1
329	414-520-059	1
330	414-520-060	1
331	414-520-061	1
332	414-520-062	1
333	414-520-063	1
334	414-520-064	1
335	414-520-065	1

COPY 8/9

PROPOSED BOUNDARY MAP OF COMMUNITY FACILITIES DISTRICT NO. 2018-1
OF THE BEAUMONT UNIFIED SCHOOL DISTRICT
COUNTY OF RIVERSIDE
STATE OF CALIFORNIA

LOT NO.	APN	IMPROV. AREA
371	414-440-031	2
372	414-440-032	2
373	414-440-033	2
374	414-440-034	2
375	414-440-035	2
376	414-440-036	2
377	414-440-037	2
378	414-440-038	2
379	414-440-039	2
380	414-440-040	2
381	414-440-041	2
382	414-440-042	2
383	414-440-043	2
384	414-440-044	2
385	414-440-045	2
386	414-440-046	2
387	414-440-047	2
388	414-440-048	2
389	414-440-049	2
390	414-440-050	2
391	414-440-051	2
392	414-440-052	2
393	414-440-053	2
394	414-440-054	2
395	414-440-055	2
396	414-440-056	2
397	414-440-057	2
398	414-440-058	2
399	414-440-059	2
400	414-440-060	2
401	414-440-061	2
402	414-440-062	2
403	414-440-063	2
404	414-440-064	2
405	414-440-065	2
406	414-440-066	2
407	414-440-067	2
408	414-440-068	2
409	414-440-069	2
410	414-440-070	2
411	414-440-071	2
412	414-440-072	2
413	414-440-073	2
414	414-440-074	2
415	414-440-075	2

LOT NO.	APN	IMPROV. AREA
416	414-440-076	2
417	414-440-077	2
418	414-440-078	2
419	414-440-079	2
420	414-440-080	2
421	414-440-081	2
422	414-440-082	2
423	414-440-083	2
424	414-410-001	2
425	414-410-002	2
426	414-410-003	2
427	414-410-004	2
428	414-410-005	2
429	414-410-006	2
430	414-410-007	2
431	414-410-008	2
432	414-410-009	2
433	414-410-010	2
434	414-410-011	2
435	414-410-012	2
436	414-410-013	2
437	414-410-014	2
438	414-410-015	2
439	414-410-016	2
440	414-410-017	2
441	414-410-018	2
442	414-410-019	2
443	414-410-020	2
444	414-410-021	2
445	414-410-022	2
446	414-410-023	2
447	414-410-024	2
448	414-410-025	2
449	414-410-026	2
450	414-410-027	2
451	414-410-028	2
452	414-410-029	2
453	414-410-030	2
454	414-410-031	2
455	414-410-032	2
456	414-410-033	2
457	414-410-034	2
458	414-410-035	2
459	414-410-036	2
460	414-410-037	2
461	414-410-038	2
462	414-410-039	2
463	414-410-040	2
464	414-410-041	2
465	414-410-042	2
466	414-410-043	2
467	414-410-044	2
468	414-410-045	2
469	414-410-046	2
470	414-410-047	2

LOT NO.	APN	IMPROV. AREA
471	414-410-048	2
472	414-410-049	2
473	414-410-050	2
474	414-410-051	2
475	414-410-052	2
476	414-410-053	2
477	414-410-054	2
478	414-410-055	2
479	414-410-056	2
480	414-410-057	2
481	414-410-058	2
482	414-410-059	2
483	414-410-060	2
484	414-410-061	2
485	414-410-062	2
486	414-410-063	2
487	414-410-064	2
488	414-410-065	2
489	414-410-066	2
490	414-410-067	2
491	414-410-068	2
492	414-410-069	2
493	414-410-070	2
494	414-410-071	2
495	414-410-072	2
496	414-410-073	2
497	414-420-001	2
498	414-420-002	2
499	414-420-003	2
500	414-420-004	2
501	414-420-005	2
502	414-420-006	2
503	414-420-007	2
504	414-420-008	2
505	414-420-009	2
506	414-420-010	2
507	414-420-011	2
508	414-420-012	2
509	414-420-013	2
510	414-420-014	2
511	414-420-015	2
512	414-420-016	2
513	414-420-017	2
514	414-420-018	2
515	414-420-019	2
516	414-420-020	2
517	414-420-021	2
518	414-420-022	2
519	414-420-023	2
520	414-420-024	2
521	414-420-025	2
522	414-420-026	2
523	414-420-027	2
524	414-420-028	2
525	414-420-029	2

LOT NO.	APN	IMPROV. AREA
526	414-420-030	2
527	414-420-031	2
528	414-420-032	2
529	414-420-033	2
530	414-420-034	2
531	414-420-035	2
532	414-420-036	2
533	414-420-037	2
534	414-420-038	2
535	414-420-039	2
536	414-420-040	2
537	414-420-041	2
538	414-420-042	2
539	414-420-043	2
540	414-420-044	2
541	414-420-045	2
542	414-420-046	2
543	414-420-047	2
544	414-420-048	2
545	414-420-049	2
546	414-420-050	2
547	414-420-051	2
548	414-420-052	2
549	414-420-053	2
550	414-420-054	2
551	414-420-055	2
552	414-420-056	2
553	414-420-057	2
554	414-420-058	2
555	414-420-059	2
556	414-420-060	2
557	414-420-061	2
558	414-420-062	2
559	414-420-063	2
560	414-420-064	2
561	414-420-065	2
562	414-420-066	2
563	414-420-067	2
564	414-420-068	2
565	414-420-069	2
566	414-420-070	2
567	414-420-071	2
568	414-420-072	2
569	414-430-001	2
570	414-430-002	2
571	414-430-003	2
572	414-430-004	2
573	414-430-005	2
574	414-430-006	2
575	414-430-007	2
576	414-430-008	2
577	414-430-009	2
578	414-430-010	2
579	414-430-011	2
580	414-430-012	2

LOT NO.	APN	IMPROV. AREA
581	414-430-013	2
582	414-430-014	2
583	414-430-015	2
584	414-430-016	2
585	414-430-017	2
586	414-430-018	2
587	414-430-019	2
588	414-430-020	2
589	414-430-021	2
590	414-430-022	2
591	414-430-023	2
592	414-430-024	2
593	414-430-025	2
594	414-430-026	2
595	414-430-027	2
596	414-430-028	2
597	414-430-029	2
598	414-430-030	2
599	414-430-031	2
600	414-430-032	2
601	414-430-033	2
602	414-430-034	2
603	414-430-035	2
604	414-430-036	2
605	414-430-037	2
606	414-430-038	2
607	414-430-039	2
608	414-430-040	2
609	414-430-041	2
610	414-430-042	2
611	414-430-043	2
612	414-430-044	2
613	414-430-045	2
614	414-430-046	2
615	414-430-047	2
616	414-430-048	2
617	414-430-049	2
618	414-430-050	2
619	414-430-051	2
620	414-430-052	2
621	414-430-053	2
622	414-430-054	2
623	414-430-055	2
624	414-430-056	2
625	414-430-057	2
626	414-430-058	2
627	414-430-059	2
628	414-430-060	2
629	414-430-061	2
630	414-430-062	2
631	414-430-063	2
632	414-450-001	3
633	414-450-002	3
634	414-450-003	3
635	414-450-004	3

LOT NO.	APN	IMPROV. AREA
636	414-450-005	3
637	414-450-006	3
638	414-450-007	3
639	414-450-008	3
640	414-450-009	3
641	414-450-010	3
642	414-450-011	3
643	414-450-012	3
644	414-450-013	3
645	414-450-014	3
646	414-450-015	3
647	414-450-016	3
648	414-450-017	3
649	414-450-018	3
650	414-450-019	3
651	414-450-020	3
652	414-450-021	3
653	414-450-022	3
654	414-450-023	3
655	414-450-024	3
656	414-450-025	3
657	414-450-026	3
658	414-450-027	3
659	414-450-028	3
660	414-450-029	3
661	414-450-030	3
662	414-450-031	3
663	414-450-032	3
664	414-450-033	3
665	414-450-034	3
666	414-450-035	3
667	414-450-036	3
668	414-450-037	3
669	414-450-038	3
670	414-450-039	3
671	414-450-040	3
672	414-450-041	3
673	414-450-042	3
674	414-450-043	3
675	414-450-044	3
676	414-450-045	3
677	414-450-046	3
678	414-450-047	3
679	414-450-048	3
680	414-450-049	3
681	414-450-050	3
682	414-450-051	3
683	414-450-052	3
684	414-450-053	3
685	414-450-054	3
686	414-450-055	3
687	414-450-056	3
688	414-450-057	3
689	414-450-058	3
690	414-450-059	3

LOT NO.	APN	IMPROV. AREA
691	414-450-060	3
692	414-450-061	3
693	414-450-062	3
694	414-460-001	3
695	414-460-002	3
696	414-460-003	3
697	414-460-004	3
698	414-460-005	3
699	414-460-006	3
700	414-460-007	3
701	414-460-008	3
702	414-460-009	3</

PROPOSED BOUNDARY MAP OF COMMUNITY FACILITIES DISTRICT NO. 2018-1

OF THE BEAUMONT UNIFIED SCHOOL DISTRICT
COUNTY OF RIVERSIDE
STATE OF CALIFORNIA

LOT NO.	APN	IMPROV. AREA
741	414-470-008	3
742	414-470-009	3
743	414-470-010	3
744	414-470-011	3
745	414-470-012	3
746	414-470-013	3
747	414-470-014	3
748	414-470-015	3
749	414-470-016	3
750	414-470-017	3
751	414-470-018	3
752	414-470-019	3
753	414-470-020	3
754	414-470-021	3
755	414-470-022	3
756	414-470-023	3
757	414-470-024	3
758	414-470-025	3
759	414-470-026	3
760	414-470-027	3
761	414-470-028	3
762	414-470-029	3
763	414-470-030	3
764	414-470-031	3
765	414-470-032	3
766	414-470-033	3
767	414-470-034	3
768	414-470-035	3
769	414-470-036	3
770	414-470-037	3
771	414-470-038	3
772	414-470-039	3
773	414-470-040	3
774	414-470-041	3
775	414-470-042	3
776	414-470-043	3
777	414-470-044	3
778	414-470-045	3
779	414-470-046	3
780	414-470-047	3
781	414-470-048	3
782	414-470-049	3
783	414-470-050	3
784	414-470-051	3
785	414-470-052	3
786	414-470-053	3
787	414-470-054	3
788	414-470-055	3
789	414-470-056	3
790	414-470-057	3
791	414-470-058	3
792	414-470-059	3
793	414-470-060	3
794	414-470-061	3
795	414-470-062	3
796	414-470-063	3

LOT NO.	APN	IMPROV. AREA
797	414-470-064	3
798	414-470-065	3
799	414-470-066	3
800	414-470-067	3
801	414-470-068	3
802	414-470-069	3
803	414-470-070	3
804	414-470-071	3
805	414-470-072	3
806	414-480-001	3
807	414-480-002	3
808	414-480-003	3
809	414-480-004	3
810	414-480-005	3
811	414-480-006	3
812	414-480-007	3
813	414-480-008	3
814	414-480-009	3
815	414-480-010	3
816	414-480-011	3
817	414-480-012	3
818	414-480-013	3
819	414-480-014	3
820	414-480-015	3
821	414-480-016	3
822	414-480-017	3
823	414-480-018	3
824	414-480-019	3
825	414-480-020	3
826	414-480-021	3
827	414-480-022	3
828	414-480-023	3
829	414-480-024	3
830	414-480-025	3
831	414-480-026	3
832	414-480-027	3
833	414-480-028	3
834	414-480-029	3
835	414-480-030	3
836	414-480-031	3
837	414-480-032	3
838	414-480-033	3
839	414-480-034	3
840	414-480-035	3
841	414-480-036	3
842	414-480-037	3
843	414-480-038	3
844	414-480-039	3
845	414-480-040	3
846	414-480-041	3
847	414-480-042	3
848	414-480-043	3
849	414-480-044	3
850	414-480-045	3
851	414-480-046	3
852	414-480-047	3

LOT NO.	APN	IMPROV. AREA
853	414-480-048	3
854	414-480-049	3
855	414-480-050	3
856	414-480-051	3
857	414-480-052	3
858	414-480-053	3
859	414-480-054	3
860	414-480-055	3
861	414-480-056	3
862	414-480-057	3
863	414-480-058	3
864	414-480-059	3
865	414-480-060	3
866	414-480-061	3
867	414-480-062	3
868	414-480-063	3
869	414-480-064	3
870	414-480-065	3
871	414-480-066	3
872	414-480-067	3
873	414-480-068	3
874	414-480-069	3
875	414-480-070	3
876	414-480-071	3
877	414-480-072	3
878	414-480-073	3
879	414-480-074	3
880	414-480-075	3
881	414-480-076	3
882	414-480-077	3
883	414-480-078	3
884	414-480-079	3
885	414-480-080	3
886	414-480-081	3
887	414-500-001	3
888	414-500-002	3
889	414-500-003	3
890	414-500-004	3
891	414-500-005	3
892	414-500-006	3
893	414-500-007	3
894	414-500-008	3
895	414-500-009	3
896	414-500-010	3
897	414-500-011	3
898	414-500-012	3
899	414-500-013	3
900	414-500-014	3
901	414-500-015	3
902	414-500-016	3
903	414-500-017	3
904	414-500-018	3
905	414-500-019	3
906	414-500-020	3
907	414-500-021	3
908	414-500-022	3

LOT NO.	APN	IMPROV. AREA
909	414-500-023	3
910	414-500-024	3
911	414-500-025	3
912	414-500-026	3
913	414-500-027	3
914	414-500-028	3
915	414-500-029	3
916	414-500-030	3
917	414-500-031	3
918	414-500-032	3
919	414-500-033	3
920	414-500-034	3
921	414-500-035	3
922	414-500-036	3
923	414-500-037	3
924	414-500-038	3
925	414-500-039	3
926	414-500-040	3
927	414-500-041	3
928	414-500-042	3
929	414-500-043	3
930	414-500-044	3
931	414-500-045	3
932	414-500-046	3
933	414-500-047	3
934	414-500-048	3
935	414-500-049	3
936	414-500-050	3
937	414-500-051	3
938	414-500-052	3
939	414-500-053	3
940	414-500-054	3
941	414-500-055	3
942	414-500-056	3
943	414-500-057	3
944	414-500-058	3
945	414-500-059	3
946	414-500-060	3
947	414-500-061	3
948	414-500-062	3
949	414-500-063	3
950	414-500-064	3
951	414-500-065	3
952	414-500-066	3
953	414-500-067	3
954	414-480-001	3
955	414-480-002	3
956	414-480-003	3
957	414-480-004	3
958	414-480-005	3
959	414-480-006	3
960	414-480-007	3
961	414-480-008	3
962	414-480-009	3
963	414-480-010	3
964	414-480-011	3

LOT NO.	APN	IMPROV. AREA
965	414-480-012	3
966	414-480-013	3
967	414-480-014	3
968	414-480-015	3
969	414-480-016	3
970	414-480-017	3
971	414-480-018	3
972	414-480-019	3
973	414-480-020	3
974	414-480-021	3
975	414-480-022	3
976	414-480-023	3
977	414-480-024	3
978	414-480-025	3
979	414-480-026	3
980	414-480-027	3
981	414-480-028	3
982	414-480-029	3
983	414-480-030	3
984	414-480-031	3
985	414-480-032	3
986	414-480-033	3
987	414-480-034	3
988	414-480-035	3
989	414-480-036	3
990	414-480-037	3
991	414-480-038	3
992	414-480-039	3
993	414-480-040	3
994	414-480-041	3
995	414-480-042	3
996	414-480-043	3
997	414-480-044	3
998	414-480-045	3
999	414-480-046	3
1000	414-480-047	3
1001	414-480-048	3
1002	414-480-049	3
1003	414-480-050	3
1004	414-480-051	3
1005	414-480-052	3
1006	414-480-053	3
1007	414-480-054	3
1008	414-480-055	3
1009	414-480-056	3
1010	414-480-057	3
1011	414-480-058	3
1012	414-480-059	3
1013	414-480-060	3
1014	414-480-061	3
1015	414-480-062	3
1016	414-480-063	3
1017	414-480-064	3
1018	414-480-065	3
1019	414-480-066	3

SDFA
SPECIAL DISTRICT FINANCING
& ADMINISTRATION

437 WEST GRAND AVENUE
ESCONDIDO, CALIFORNIA 92025
TELEPHONE: (760)233-2630
FAX: (760)233-2631